

1

2

3

4

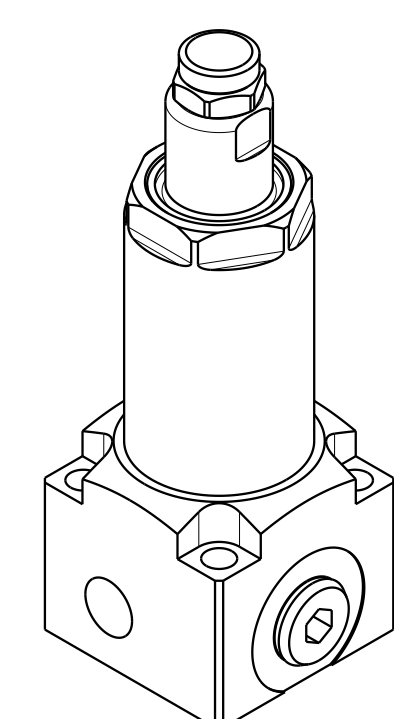

ILC10080626PS REV A ECN3869

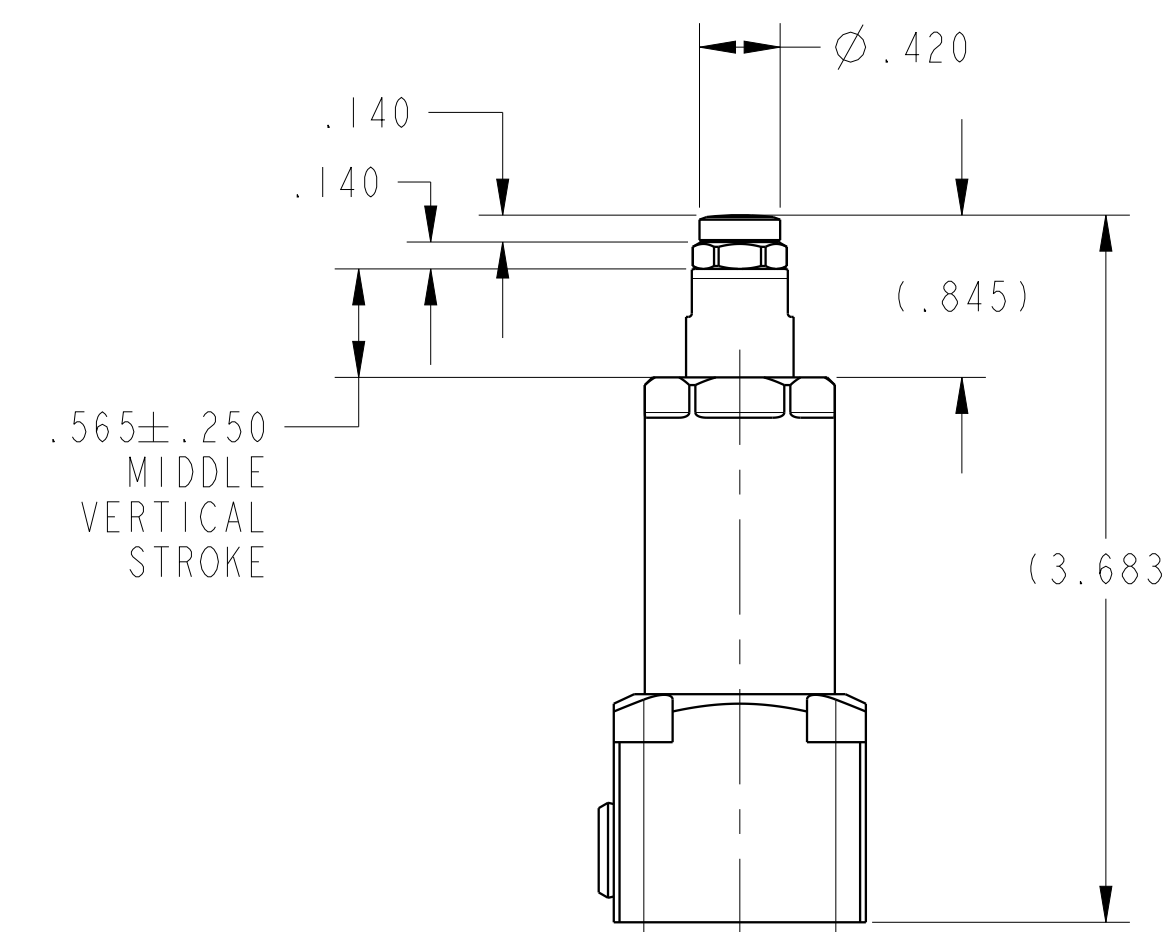
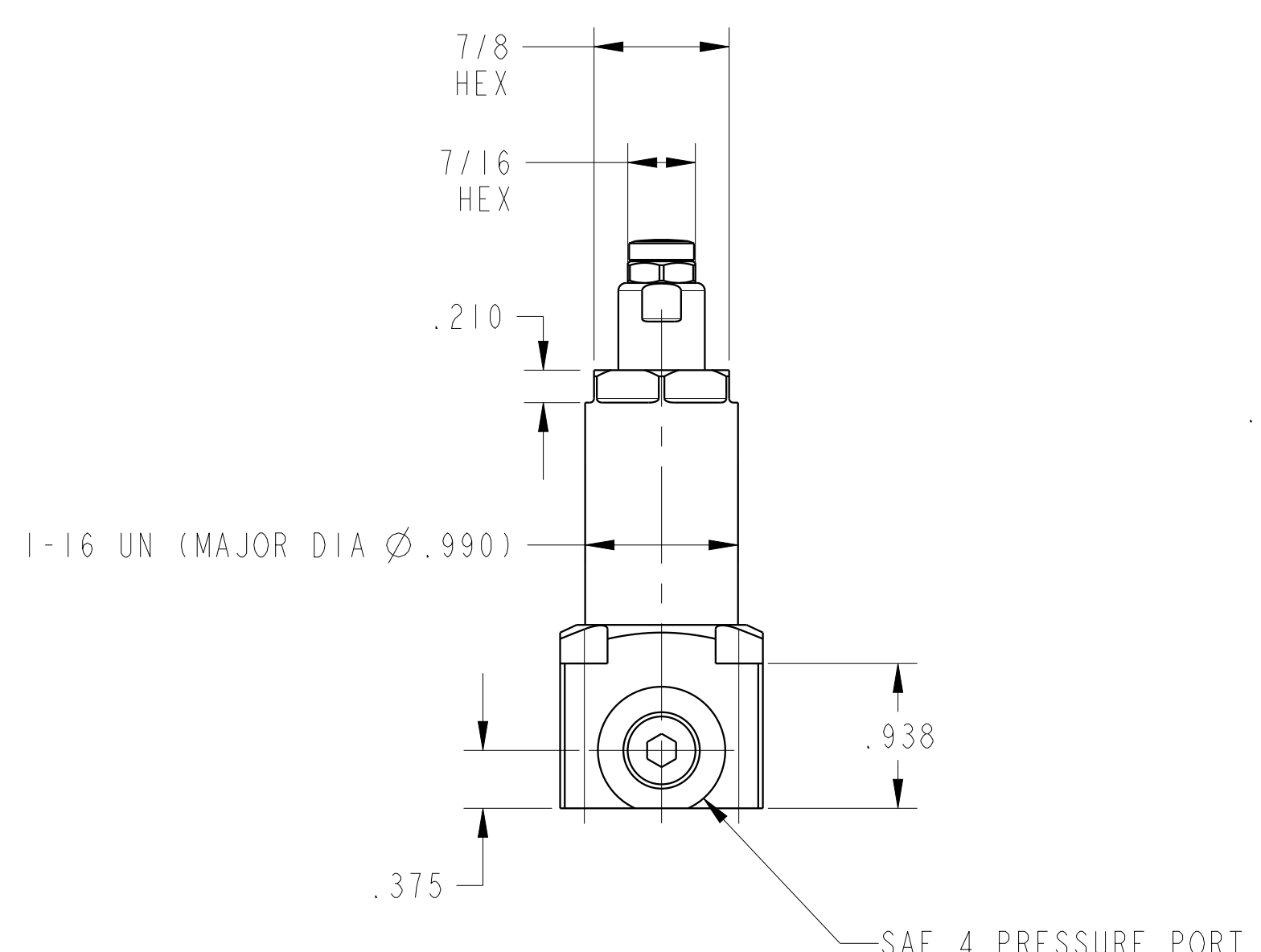
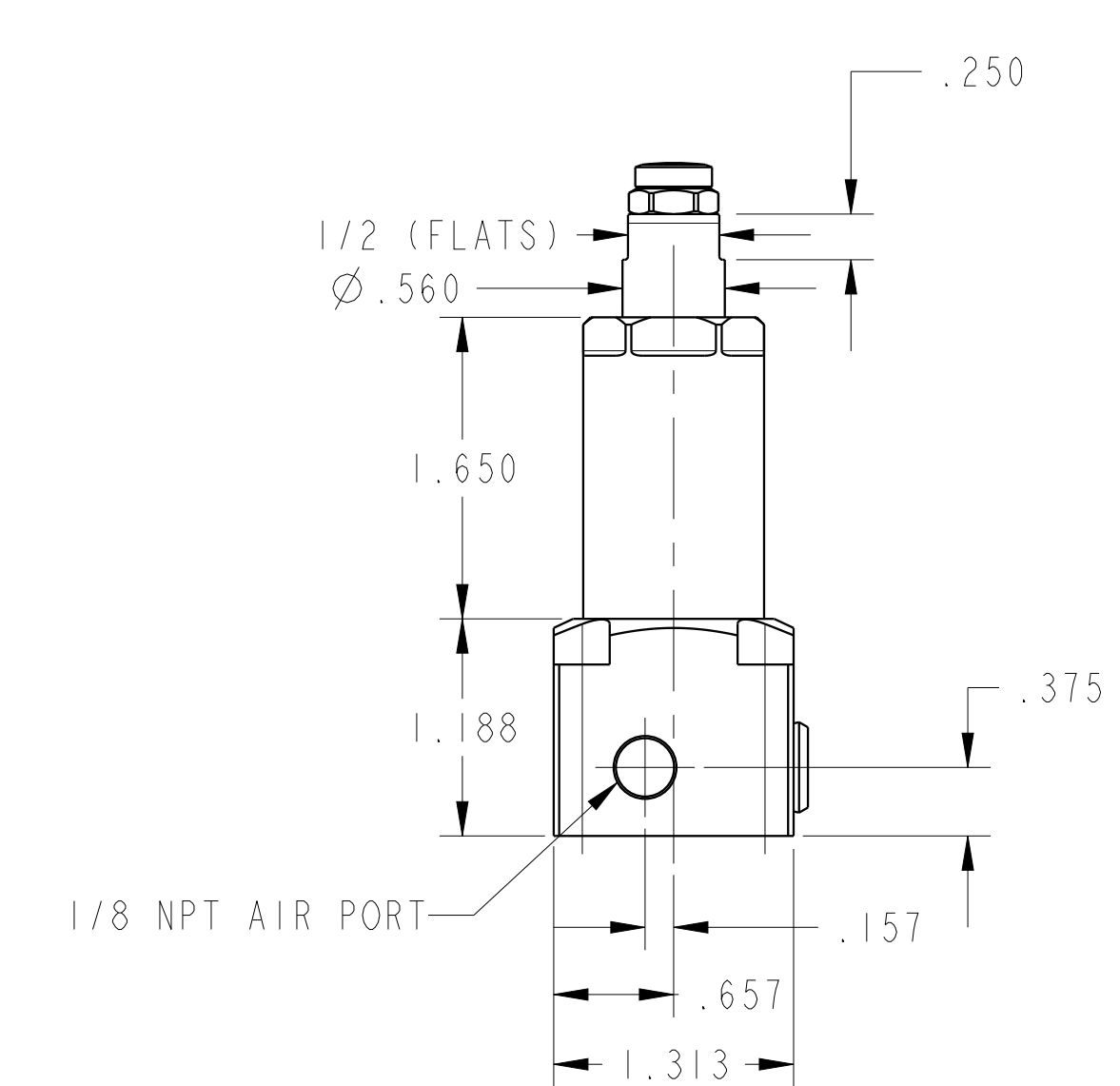
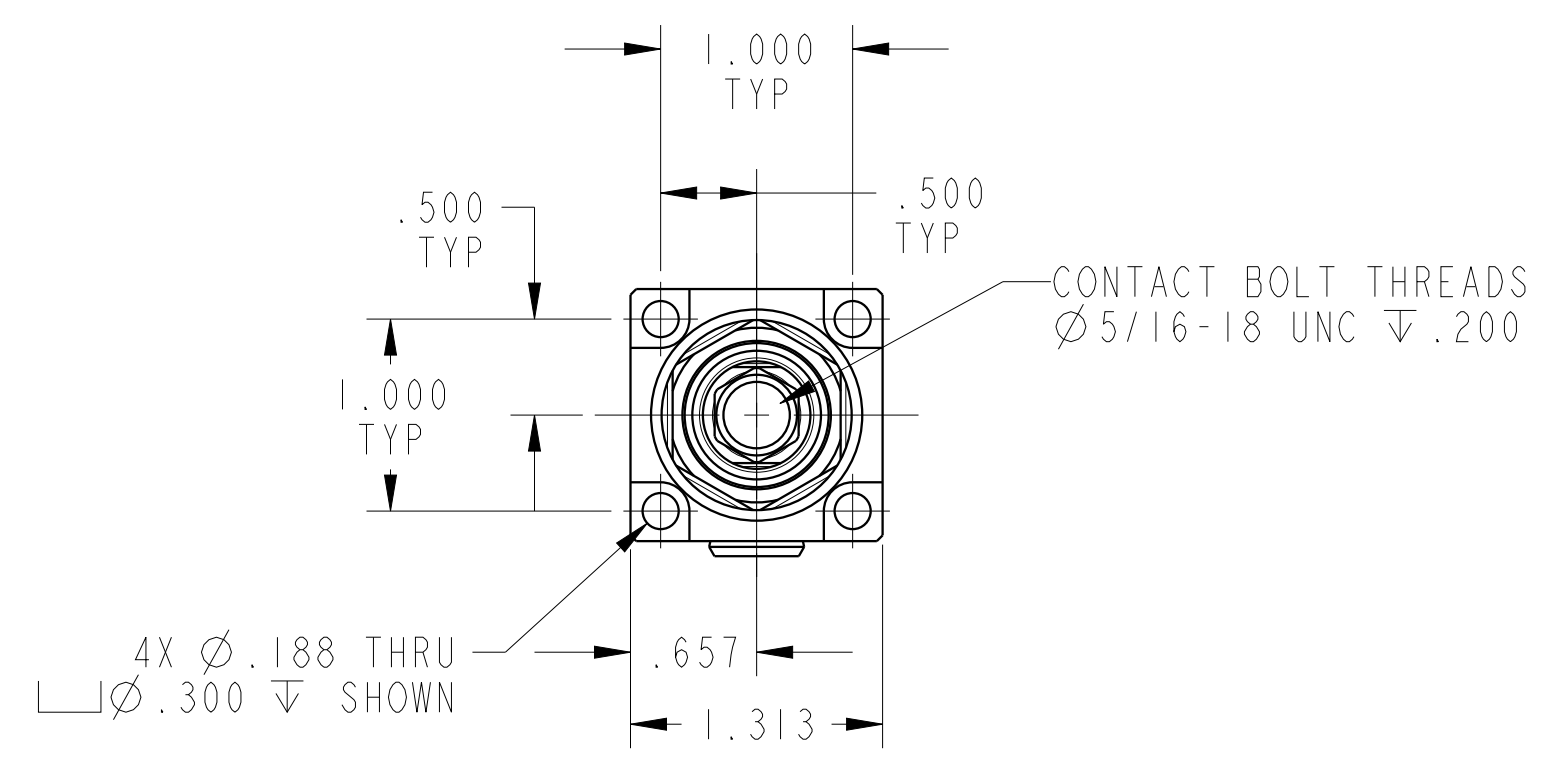

SEE IS5003 FOR PART POSITION SENSOR SETUP

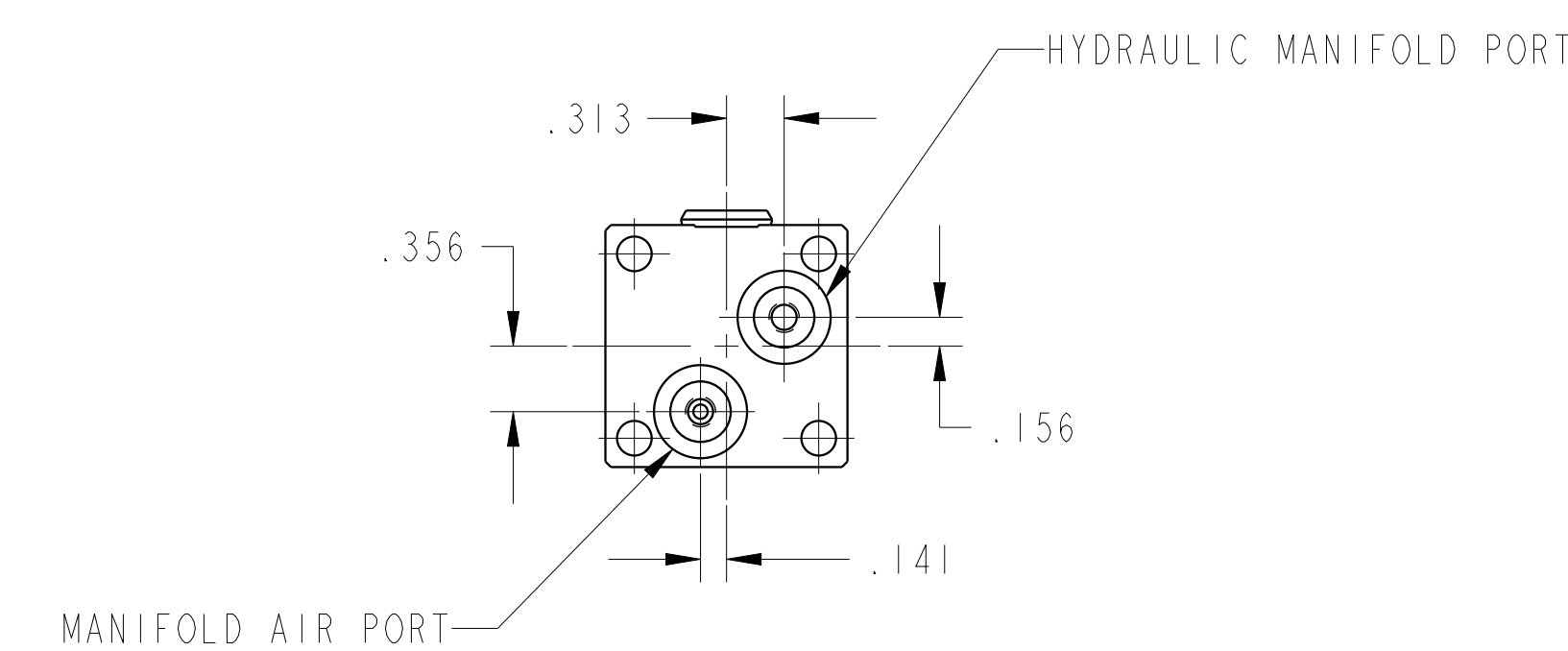

CAD CONTROL DRAWING

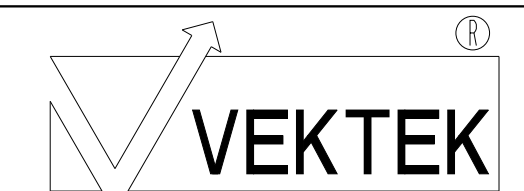

VEKTEK, INC.  
1334 E. SIXTH AVE. P.O. BOX 625  
EMPORIA, KS. 66801 U.S.A.

A	3869	RELEASE	ALS	6/22/20	10080626PS	A	WS, FA, BM, HC, 2000, PPS, LS
REV	IN ACCORDANCE WITH ECN	EFFECTIVE DATE	REVISED BY	DATE	REFERENCE MODEL	REF REV	
DRW BY:	ALS	DRAWING STATUS: Released			TOLERANCES DO NOT APPLY DIMENSIONS ARE NOMINAL		SIZE D
DATE:	3/2/20	PRODUCTION APPROVED FOR RELEASED STATUS ONLY					ILC10080626PS REV A

1

2

3

4

SHEET 1 OF 1