

ILCI4110501L REV D ECN 2510

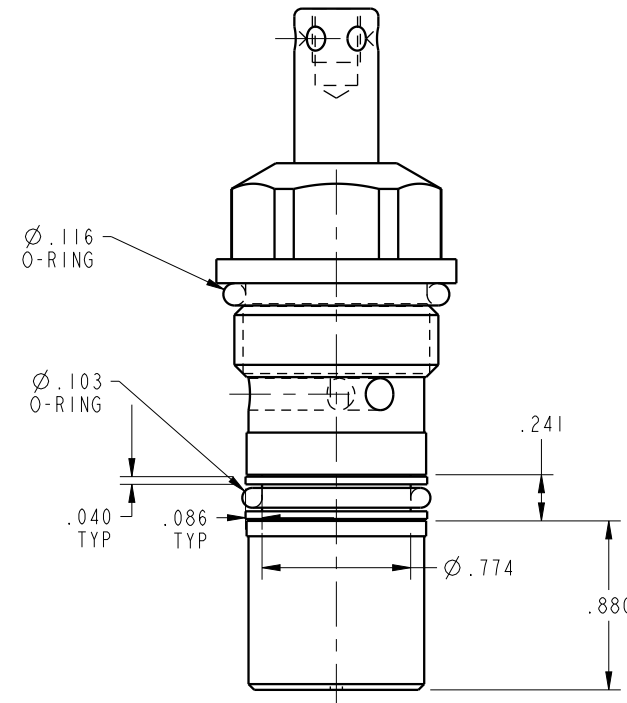

CAD CONTROL DRAWING



VEKTEK, INC.
1334 E. SIXTH AVE. P.O. BOX 625
EMPORIA, KS. 66801 U.S.A.

D	2510	RELEASED	JDW	04/08/13	14110501L	A	SC, HS, CM, SA, 450, LH
REV	IN ACCORDANCE WITH ECN	EFFECTIVE DATE	REVISED BY	DATE	REFERENCE MODEL	REF REV	
DRW BY:	K. ROEMER	DRAWING STATUS: Released			TOLERANCES DO NOT APPLY DIMENSIONS ARE NOMINAL		SIZE B
DATE:	03/28/08	PRODUCTION APPROVED FOR RELEASED STATUS ONLY			ILCI4110501L		REV D

FORM FEG036, Rev. B

SHEET 1 OF 1