

ILC14620501S REV A ECN 3414
SCALE 1.000

CAD CONTROL
DRAWING

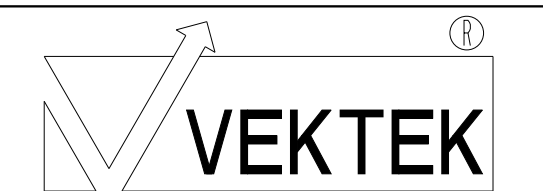

VEKTEK, INC.
1334 E. SIXTH AVE. P.O. BOX 625
EMPORIA, KS. 66801 U.S.A.

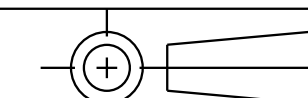

A	3414	RELEASE	JDW	02/07/18	14620501S	A	SC, TF, DA, HS, STR, 450
REV	IN ACCORDANCE WITH ECN	EFFECTIVE DATE	REVISED BY	DATE	REFERENCE MODEL	REF REV	
DRW BY:	JDW	DRAWING STATUS: Released			TOLERANCES DO NOT APPLY DIMENSIONS ARE NOMINAL		SIZE D
DATE:	02/07/18	PRODUCTION APPROVED FOR RELEASED STATUS ONLY			ILC14620501S		REV A

SHEET 1 OF 1