

ILC15822900 REV. A ECN4112

**CAD CONTROL
DRAWING**

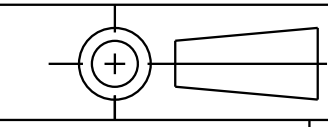

VEKTEK, INC.
1334 E. SIXTH AVE. P.O. BOX 625
EMPORIA, KS. 66801 U.S.A.



A	4112	RELEASE	JDW	02/21/20	15822900	A	CENTER CLAMP, MEGA, 2PT, 3.27-3.58 IN
REV	IN ACCORDANCE WITH ECN	EFFECTIVE DATE	REVISED BY	DATE	REFERENCE MODEL	REF REV	
DRW BY: JDW		DRAWING STATUS: Released			TOLERANCES DO NOT APPLY DIMENSIONS ARE NOMINAL		SIZE D
DATE: 02/21/20		PRODUCTION APPROVED FOR RELEASED STATUS ONLY			ILC15822900		REV A