

ILC20111000 REV A ECN 642  
SCALE 1.000

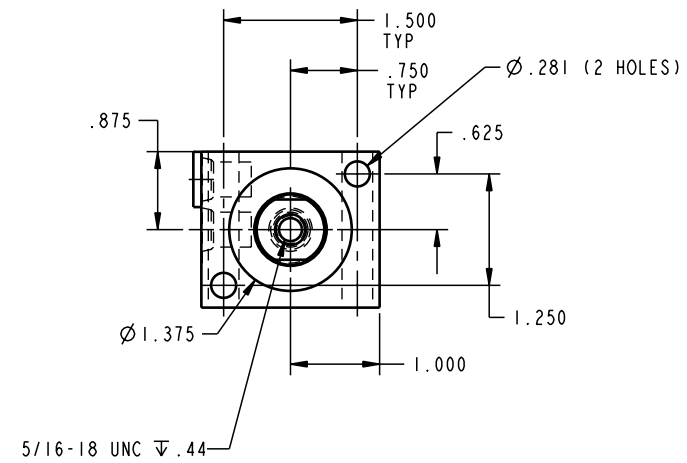

CAD CONTROL  
DRAWING

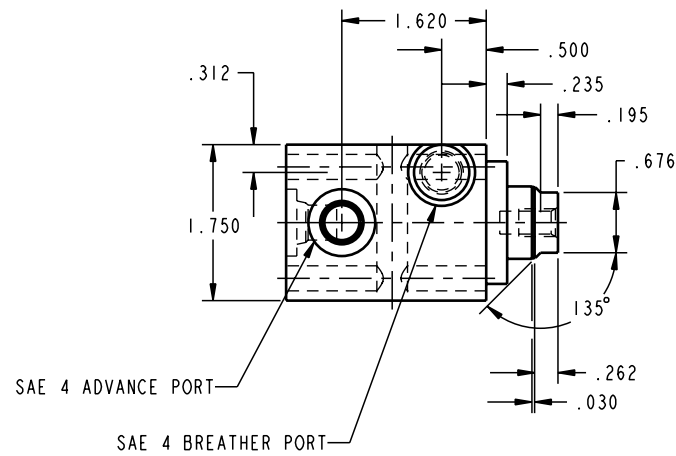
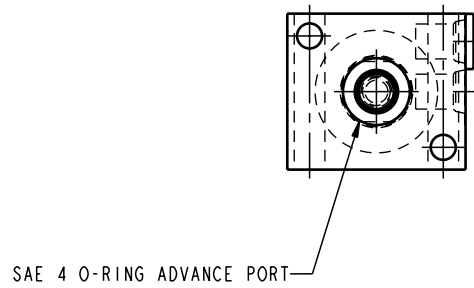

VEKTEK, INC.  
1334 E. SIXTH AVE. P.O. BOX 625  
EMPORIA, KS. 66801 U.S.A.

A	642	RELEASE	K. ROEMER	04-01-05	20111000	H	CYL, BB, SA, 3900, .50 STRK
REV	IN ACCORDANCE WITH ECN	EFFECTIVE DATE	REVISED BY	DATE	REFERENCE MODEL	REF REV	
DRW BY:	DRAWING STATUS: <b>Released</b>				TOLERANCES DO NOT APPLY		SIZE
DATE:	PRODUCTION APPROVED FOR RELEASED STATUS ONLY				DIMENSIONS ARE NOMINAL		D ILC20111000 REV A

TOLERANCES DO NOT APPLY  
DIMENSIONS ARE NOMINAL

SIZE  
D ILC20111000 REV A

FORM FEG036, Rev. A

SHEET 1 OF 1