

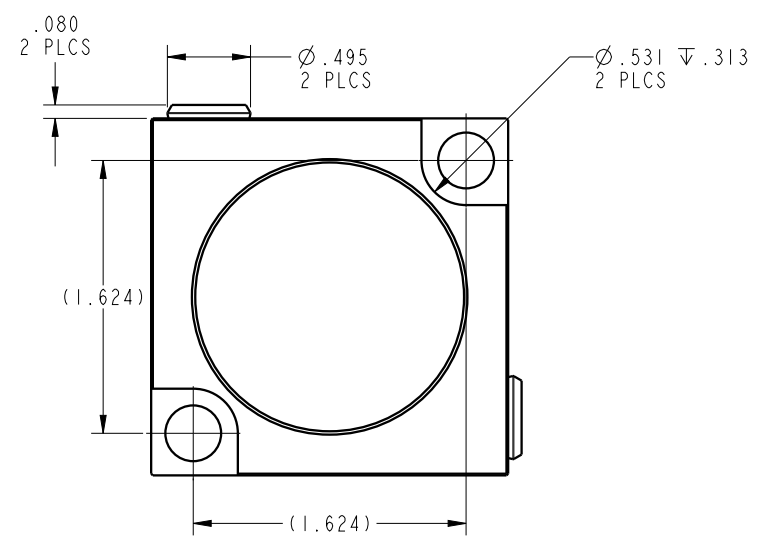

ILC20111300 REV A ECN 3539

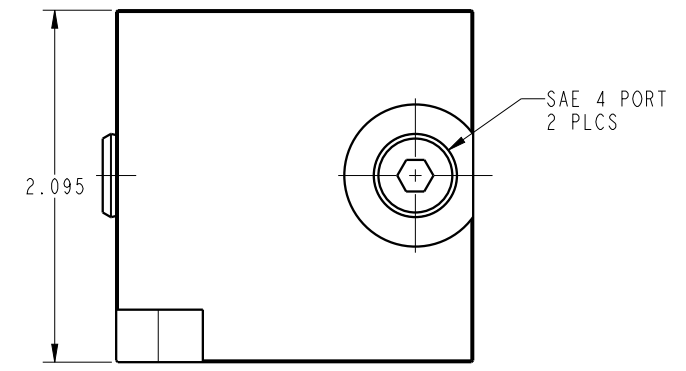
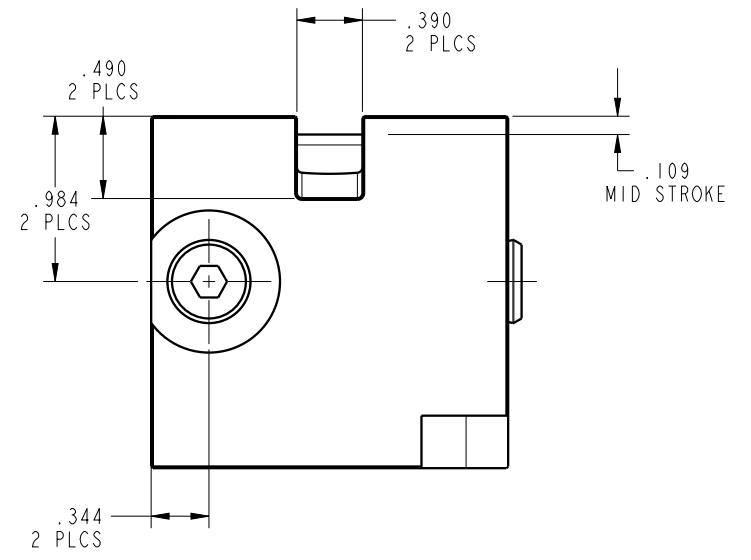

CAD CONTROL DRAWING	 VEKTEK, INC. 1334 E. SIXTH AVE. P.O. BOX 625 EMPORIA, KS. 66801 U.S.A.	
		

A	3539	RELEASE	MJUST	7/30/18	20111300	A	CYL, BB, PULL, 5200LB	
REV	IN ACCORDANCE WITH ECN	EFFECTIVE DATE	REVISED BY	DATE	REFERENCE MODEL	REF REV	3/8-16 THREAD	
DRW BY:	MJUST	DRAWING STATUS: Released			TOLERANCES DO NOT APPLY		SIZE	
DATE:	7/24/18	PRODUCTION APPROVED FOR RELEASED STATUS ONLY			DIMENSIONS ARE NOMINAL		B	
							ILC20111300	REV A
							FORM FEG036, Rev. B	

SHEET 1 OF 1