

ILC20121505 REV A ECN 4656
SCALE 1.000

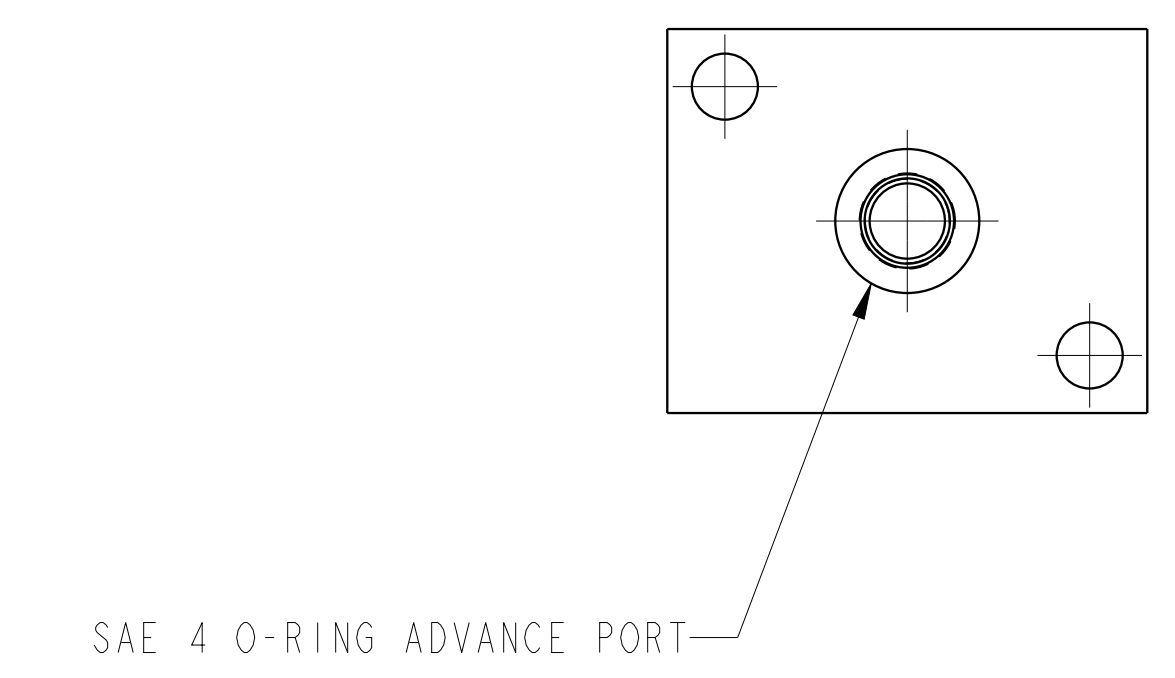
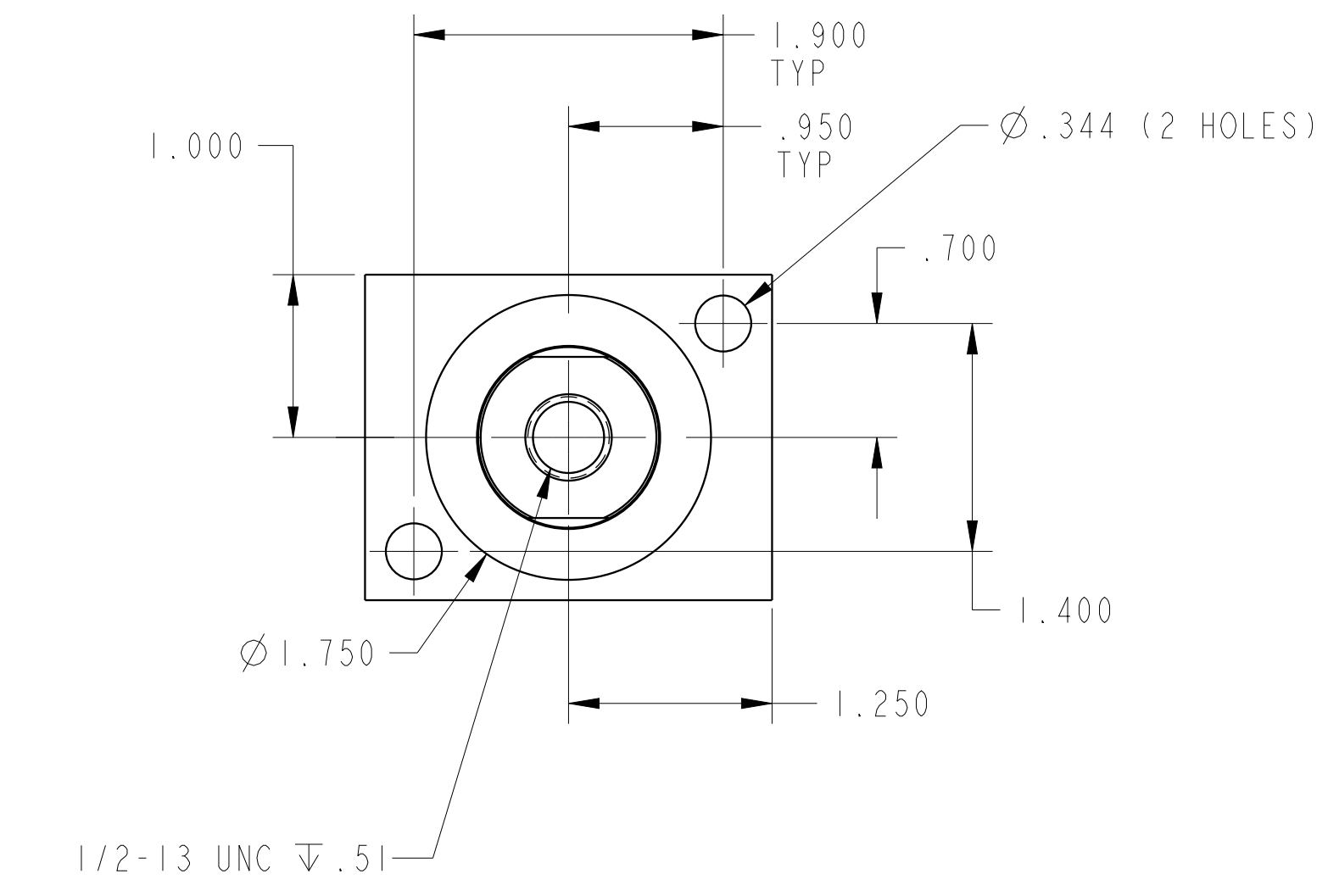
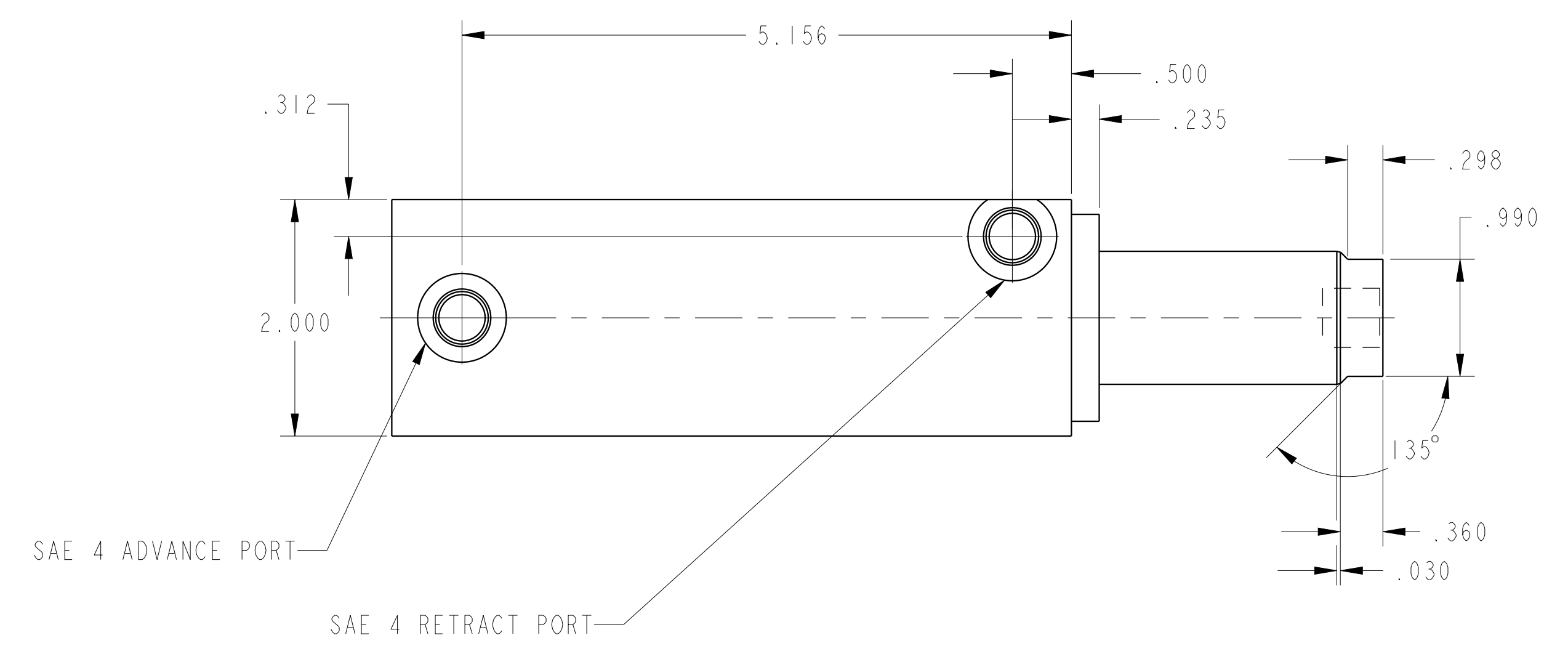

SAE 4 ADVANCE PORT

SAE 4 RETRACT PORT

CAD CONTROL DRAWING

VEKTEK, INC.
1334 E. SIXTH AVE. P.O. BOX 625
EMPORIA, KS. 66801 U.S.A.

A	4656	RELEASE	ALS	3/29/22	20121505	A	CYL, BB, DA, 8800, 4.0 STRK
REV	IN ACCORDANCE WITH ECN	EFFECTIVE DATE	REVISED BY	DATE	REFERENCE MODEL	REF REV	
DRW BY:	ALS	DRAWING STATUS: Released			TOLERANCES DO NOT APPLY DIMENSIONS ARE NOMINAL		SIZE D
DATE:	7/21/20	PRODUCTION APPROVED FOR RELEASED STATUS ONLY			ILC20121505	REV A	