

1

2

3

4

D

D

C

C

B

B

A

A

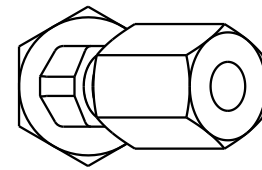

ILC30150146 REV A ECN 4756

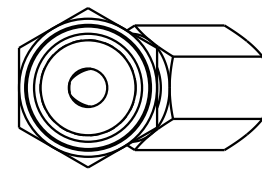
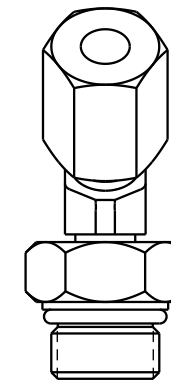
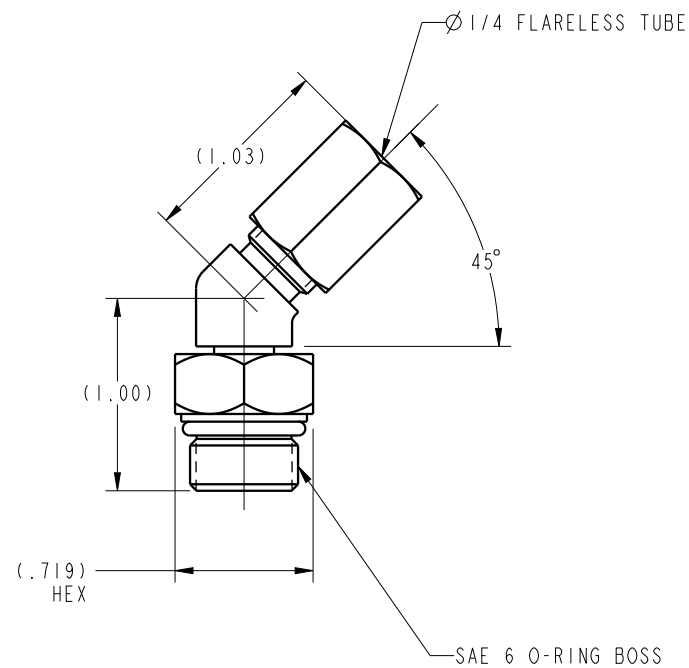
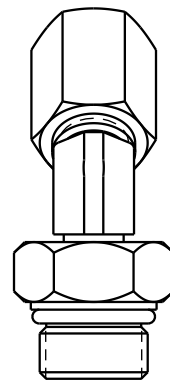

CAD CONTROL DRAWING



VEKTEK, INC.
1334 E. SIXTH AVE. P.O. BOX 625
EMPORIA, KS. 66801 U.S.A.

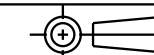

A	4756	RELEASE	RLK	9/6/22	30150155	A	ELBOW, -6,M,SAE,45DEG/ADJ X 1/4,F,TUBE
REV	IN ACCORDANCE WITH ECN	EFFECTIVE DATE	REVISED BY	DATE	REFERENCE MODEL	REF REV	
DRW BY:	RLK	DRAWING STATUS: Released			TOLERANCES DO NOT APPLY DIMENSIONS ARE NOMINAL		SIZE B
DATE:	9/6/22	PRODUCTION APPROVED FOR RELEASED STATUS ONLY					ILC30150146 REV A

FORM FEG036, Rev. B

SHEET 1 OF 1