

1

2

3

4

D

D

C

C

B

B

A

A

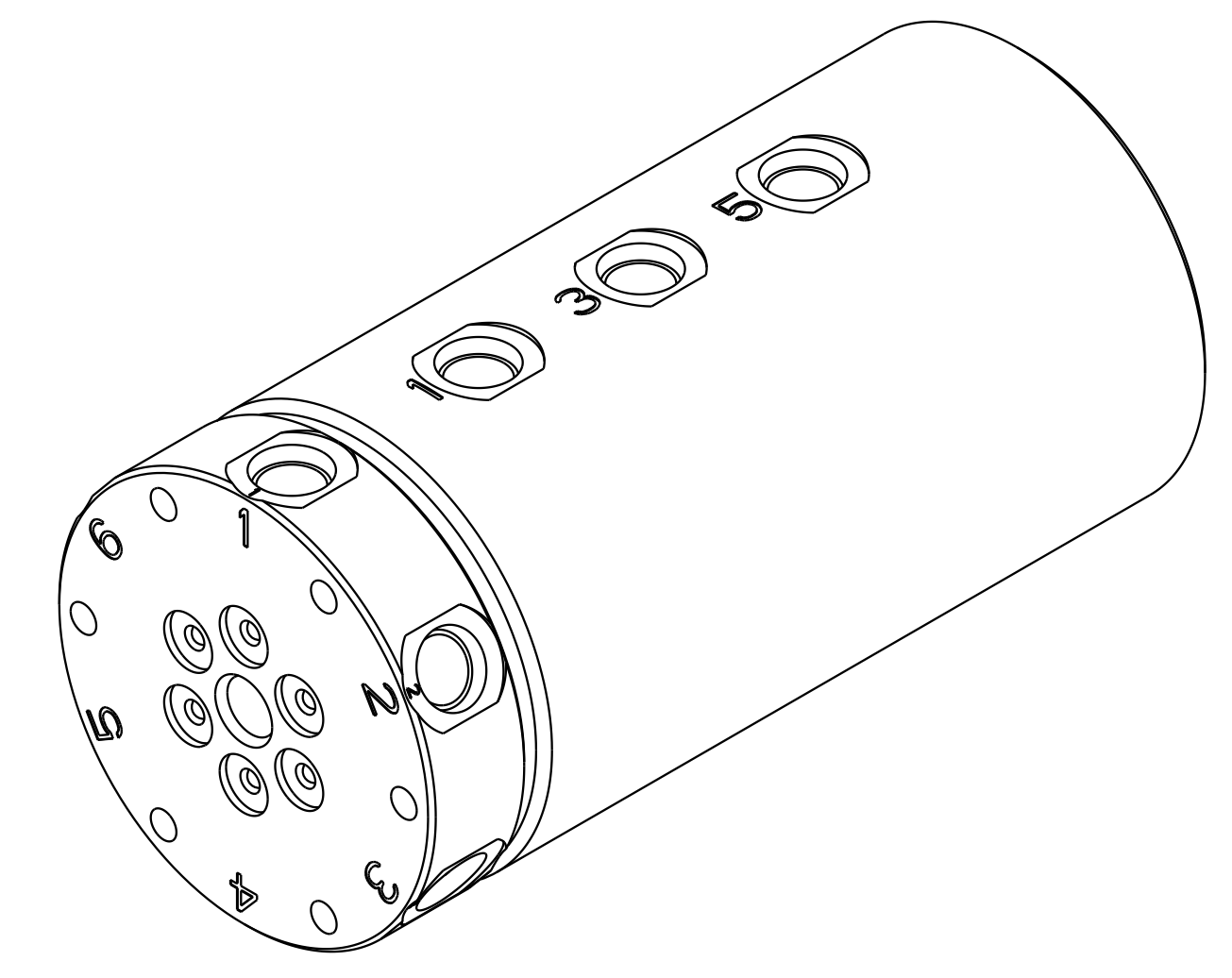
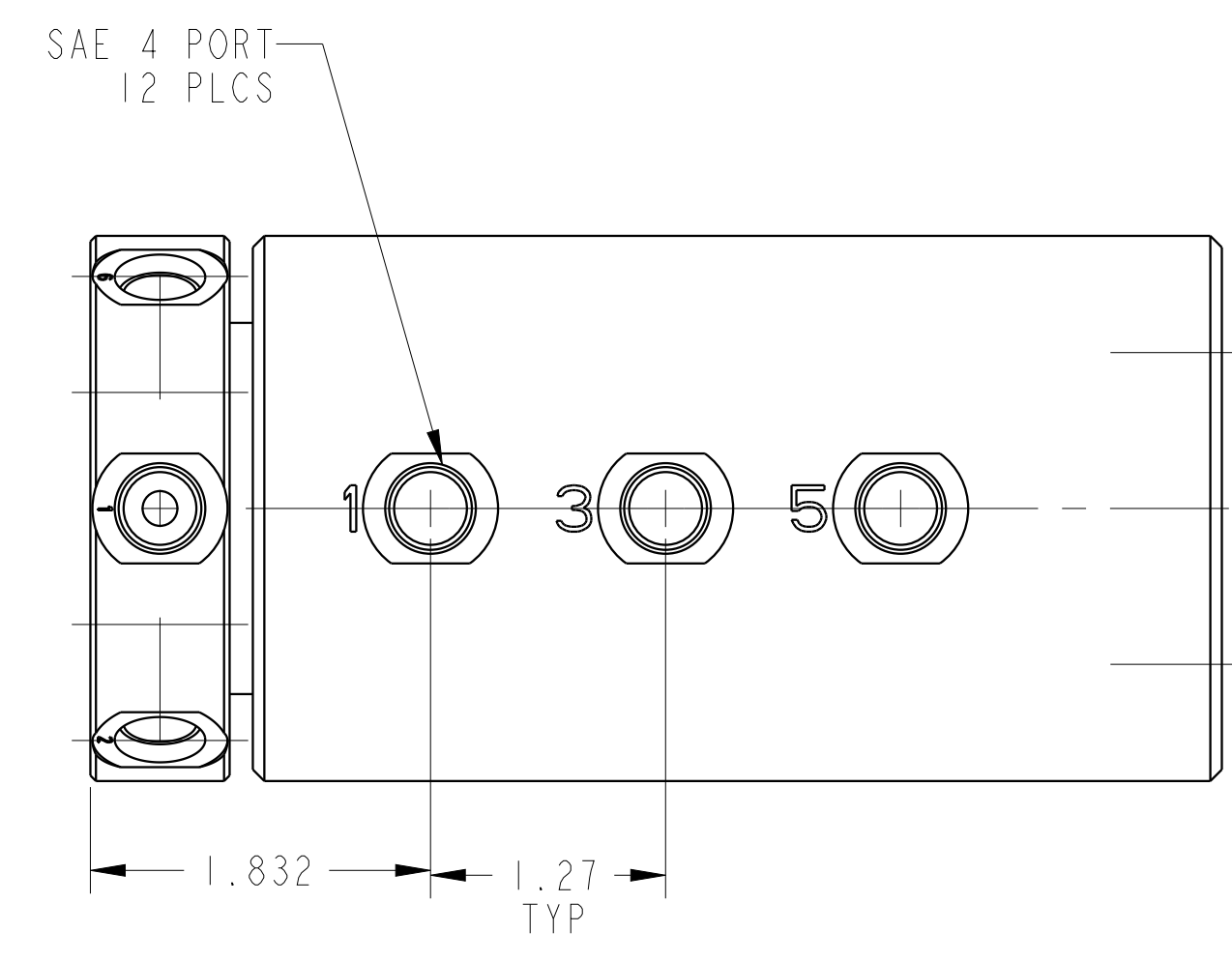

ILC32624600 REV B ECN 5033

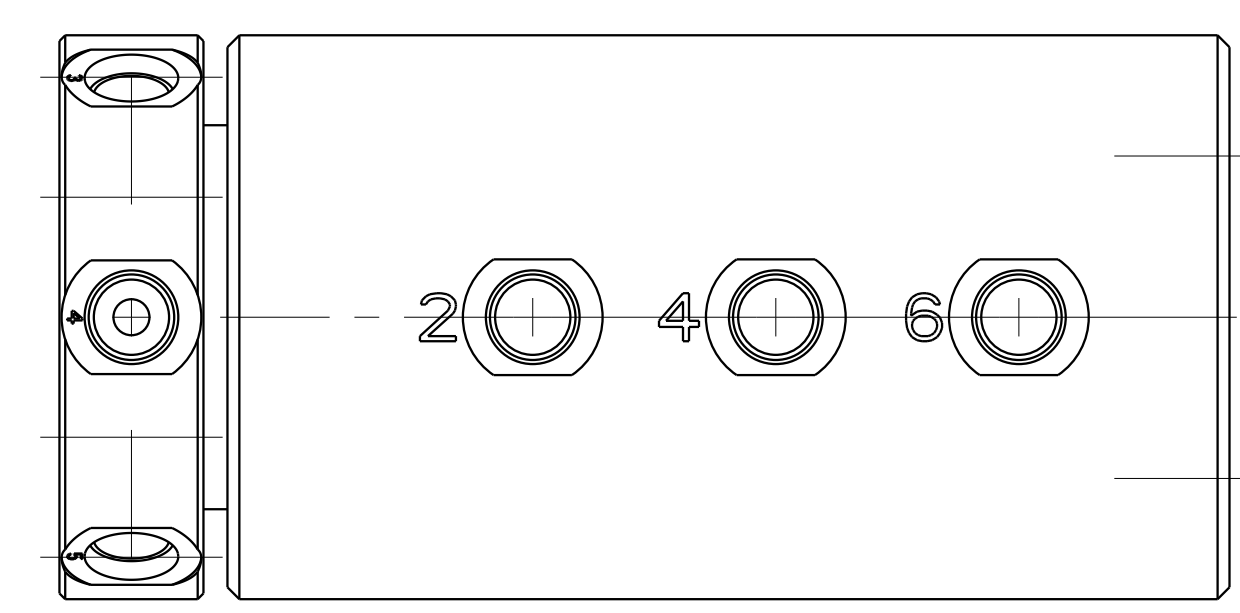
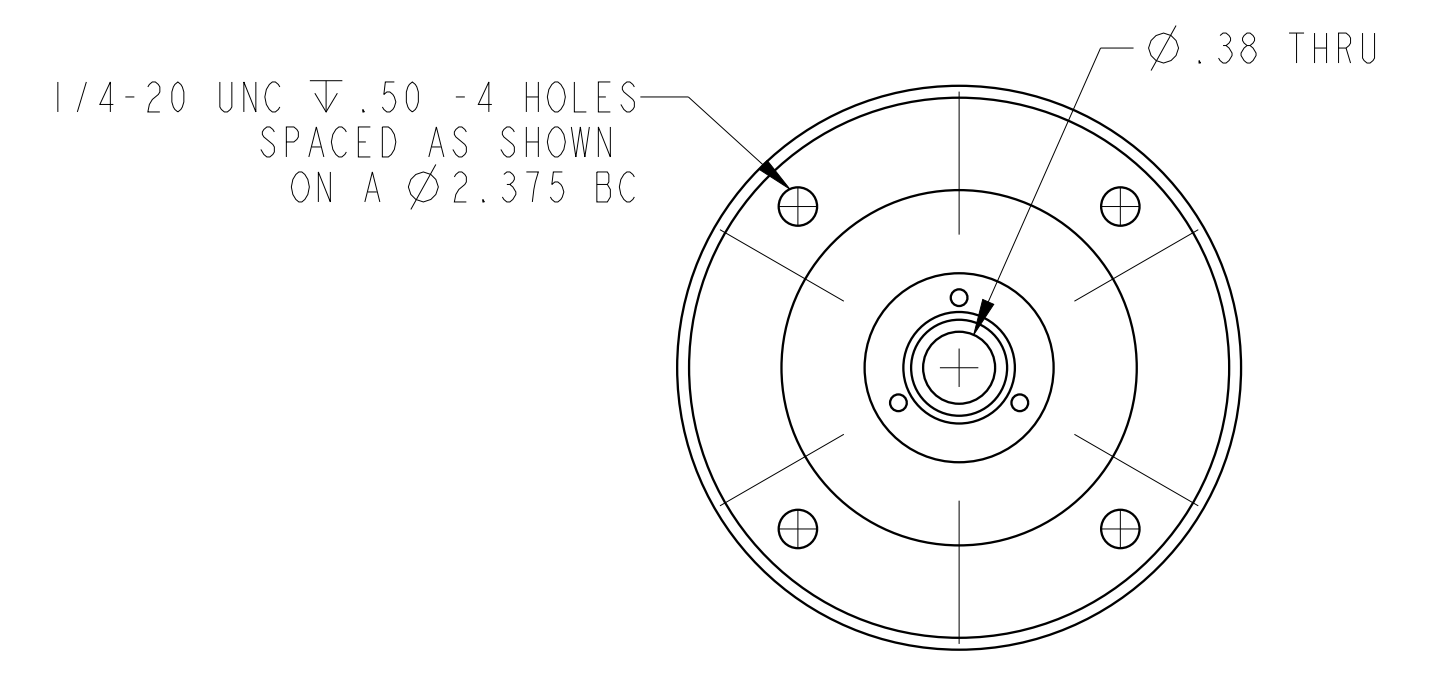
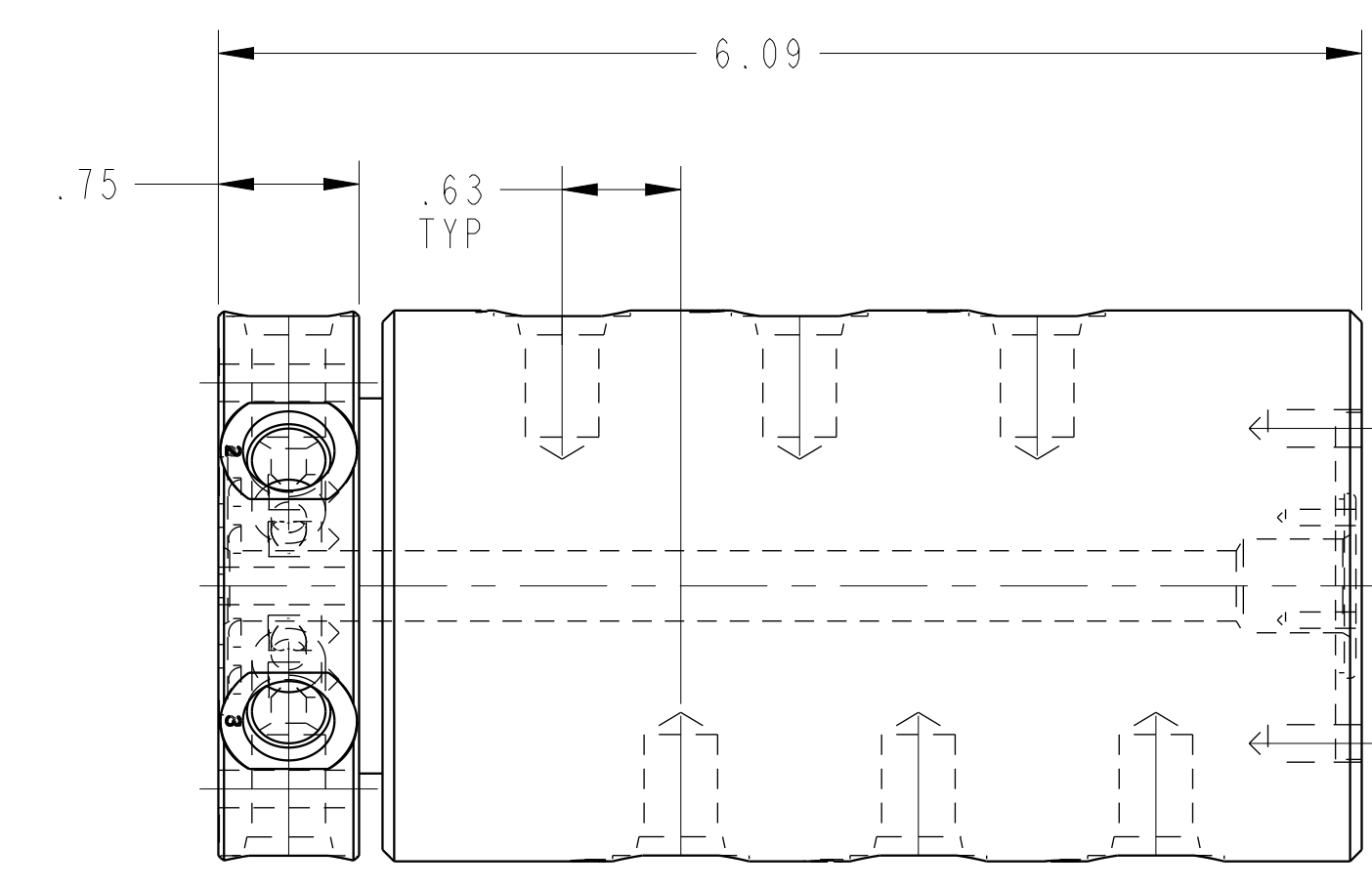
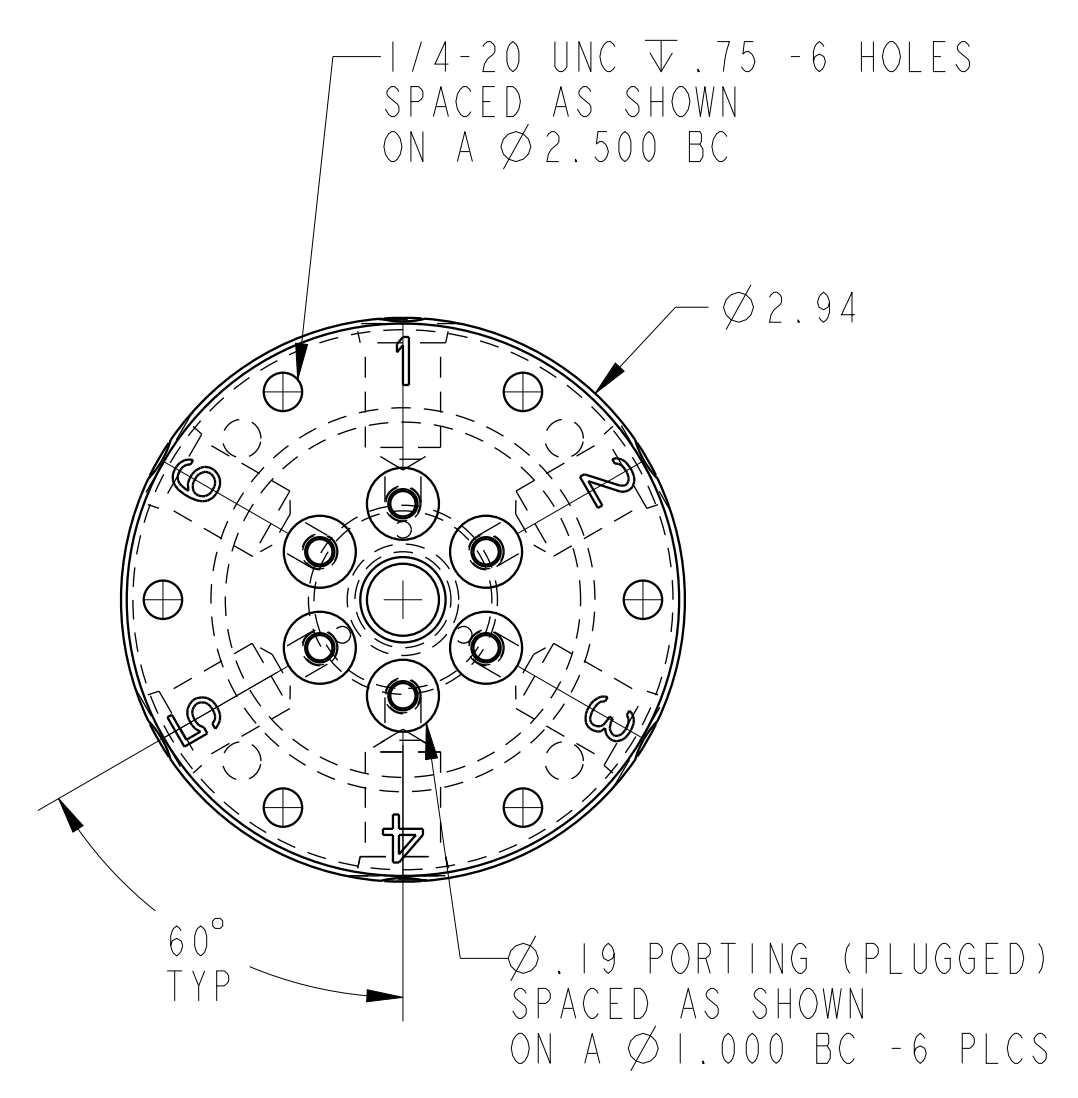

CAD CONTROL DRAWING



VEKTEK, INC.  
1334 E. SIXTH AVE. P.O. BOX 625  
EMPORIA, KS. 66801 U.S.A.

B	5033	RELEASE	JDW	02/14/23	32624600	c	RU,6 PASSAGE,SAE4
REV	IN ACCORDANCE WITH ECN	EFFECTIVE DATE	REVISED BY	DATE	REFERENCE MODEL	REF REV	
DRW BY:	K. ROEMER	DRAWING STATUS: Released			TOLERANCES DO NOT APPLY		SIZE
DATE:	06-29-05	PRODUCTION APPROVED FOR RELEASED STATUS ONLY			DIMENSIONS ARE NOMINAL		D ILC32624600 REV B

1

2

3

4

SHEET 1 OF 1