

1

2

3

4

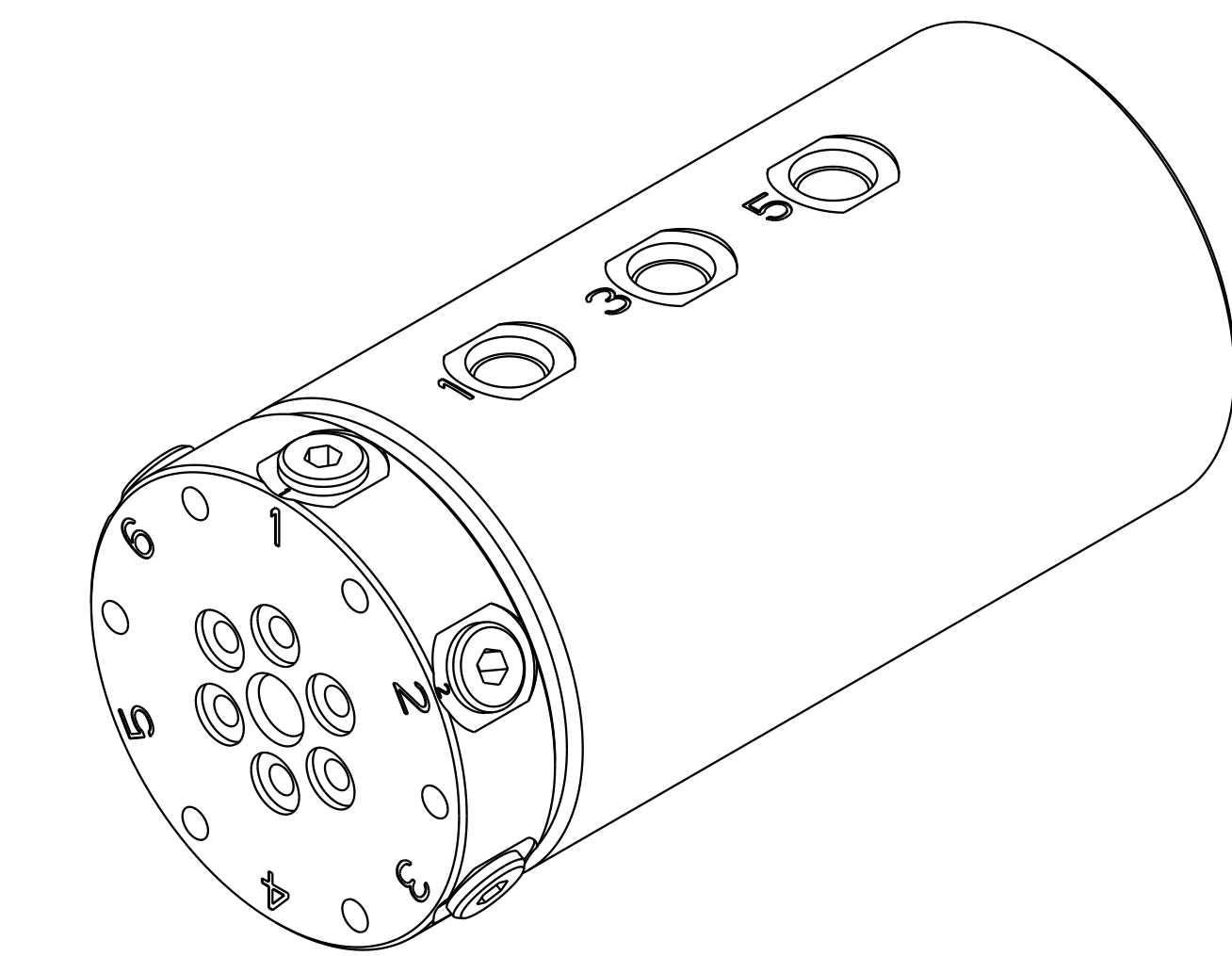
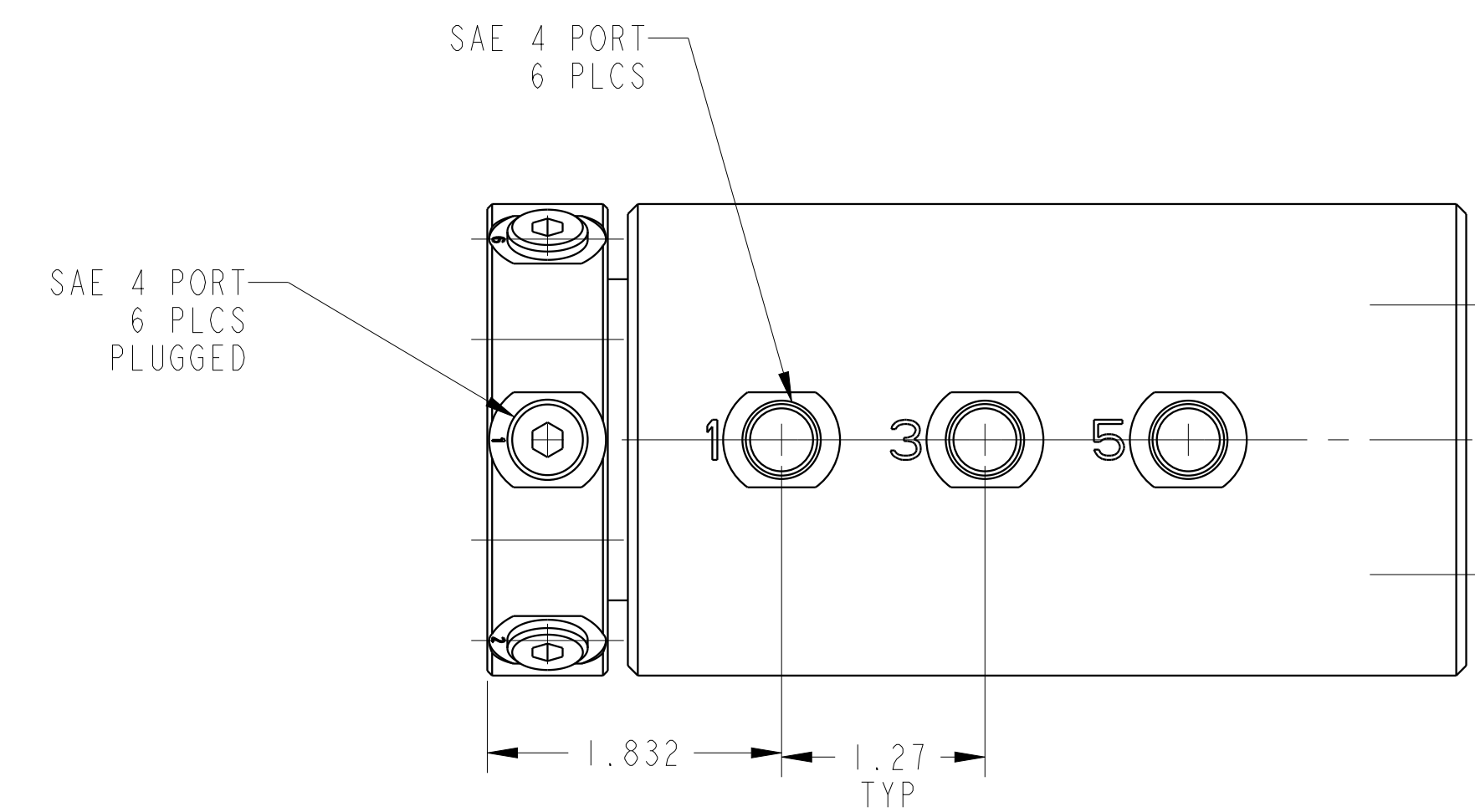

ILC32624601 REV B ECN 5033

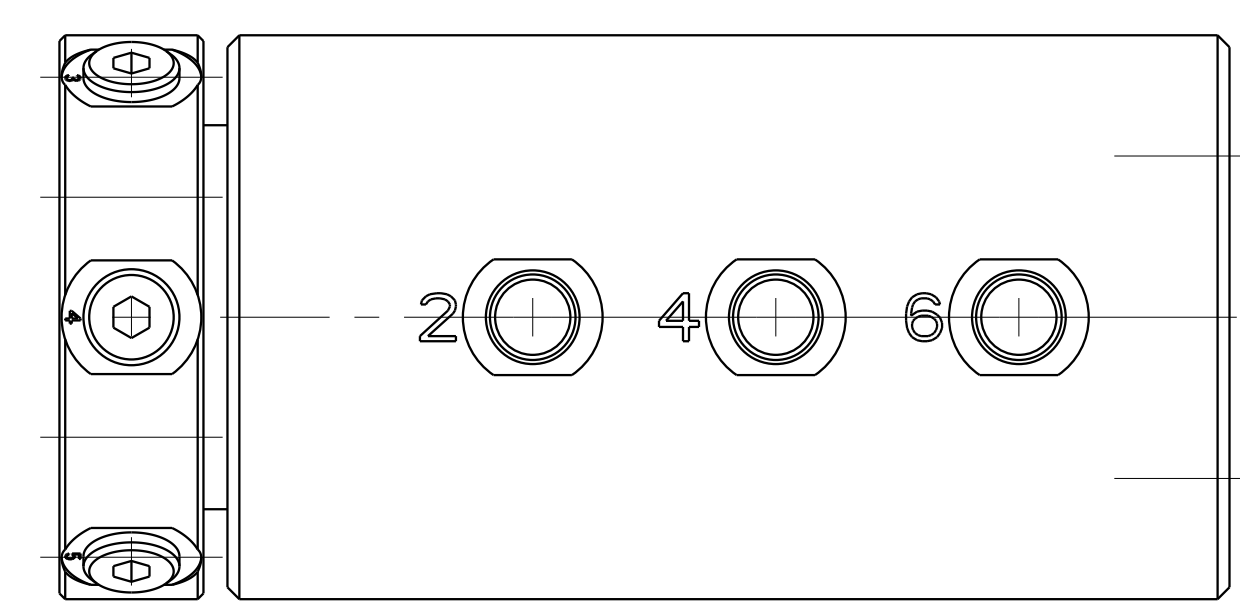
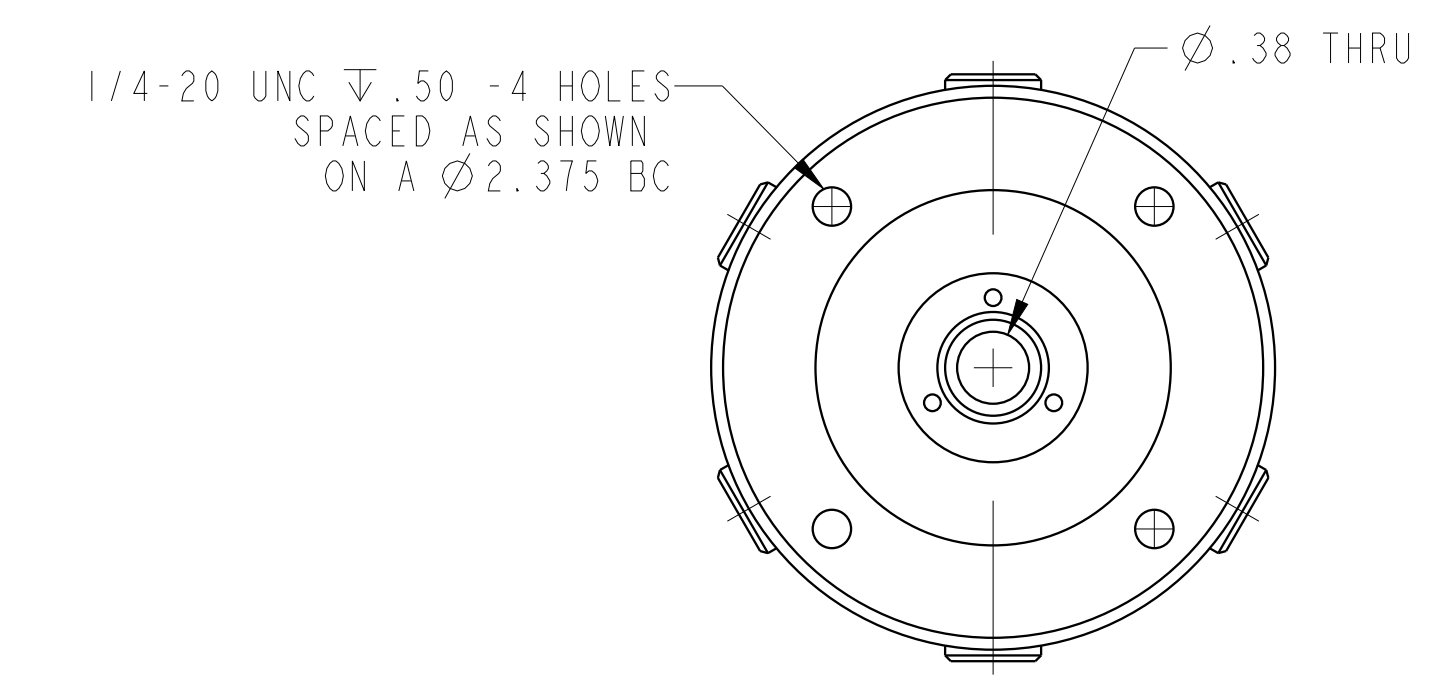
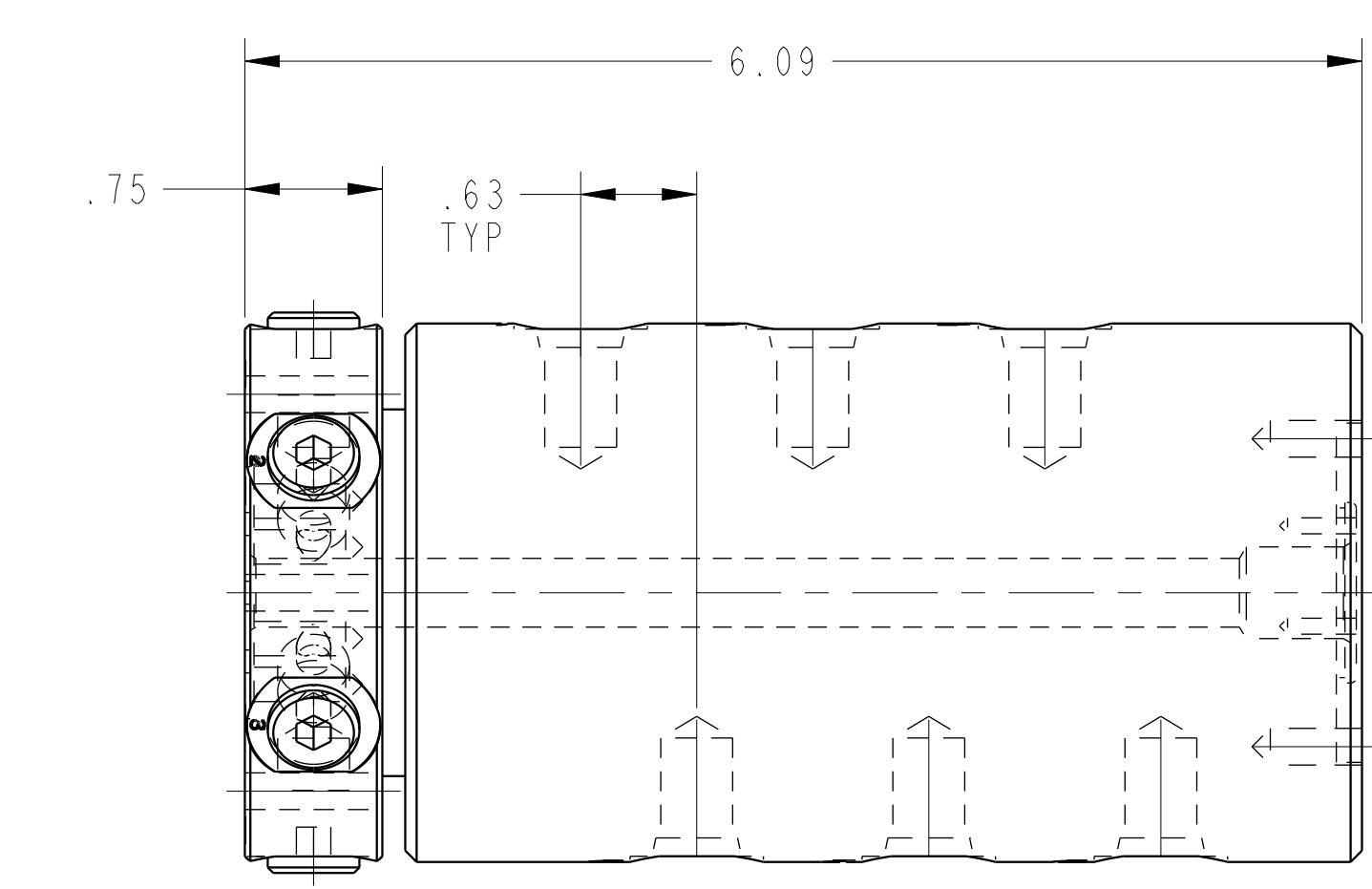
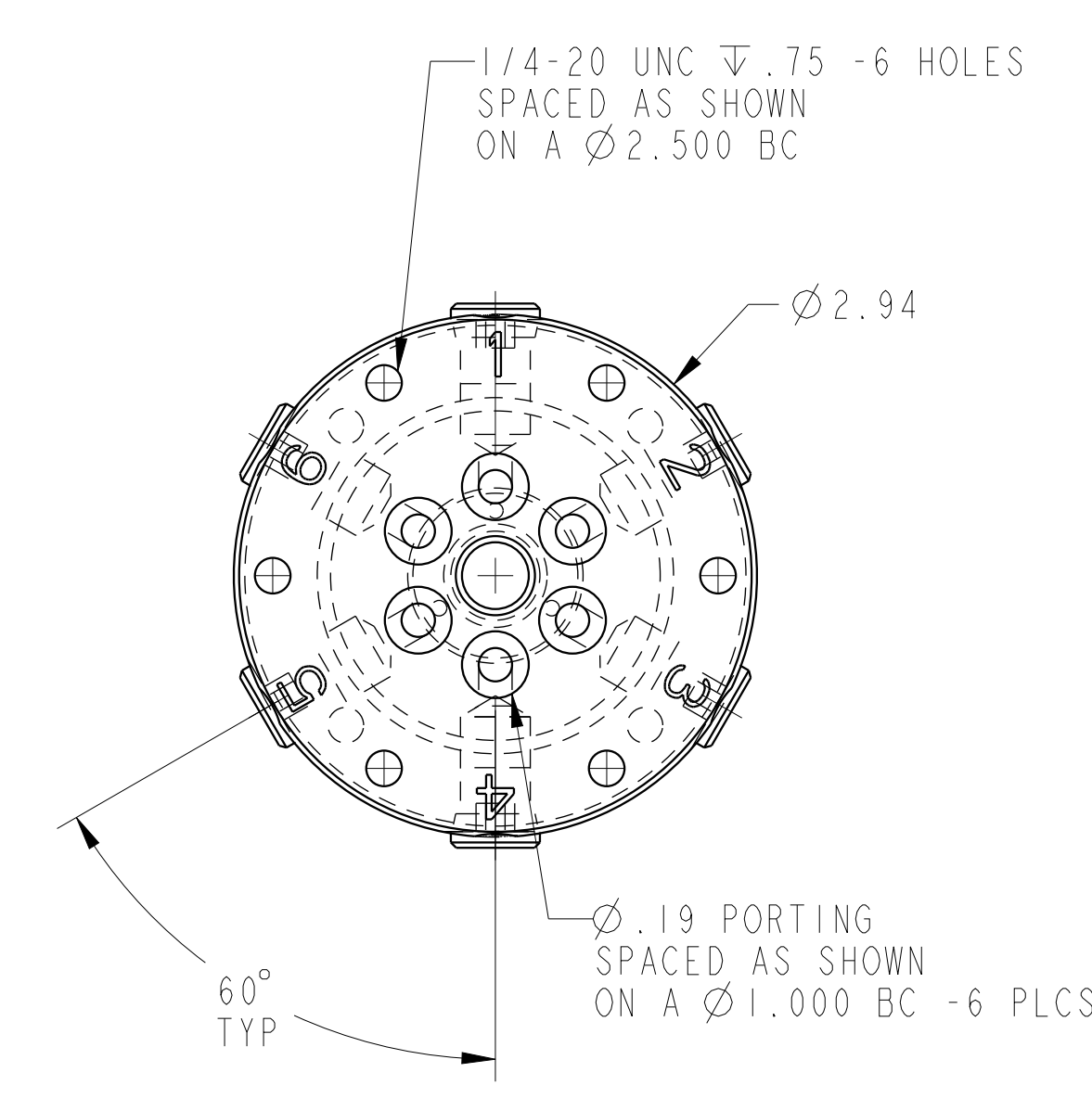

CAD CONTROL DRAWING			
		VEKTEK, INC. 1334 E. SIXTH AVE. P.O. BOX 625 EMPORIA, KS. 66801 U.S.A.	

B	5033	RELEASE	JDW	02/14/23	32624601	B	RU,6 PASSAGE, MM
REV	IN ACCORDANCE WITH ECN	EFFECTIVE DATE	REVISED BY	DATE	REFERENCE MODEL	REF REV	
DRW BY:	K. ROEMER			DRAWING STATUS: Released		TOLERANCES DO NOT APPLY	
DATE:	06-29-05			PRODUCTION APPROVED FOR RELEASED STATUS ONLY		DIMENSIONS ARE NOMINAL	
SIZE	D			ILC32624601		REV B	

1

2

3

4

SHEET 1 OF 1