

ILC56000103 REV B ECN2947

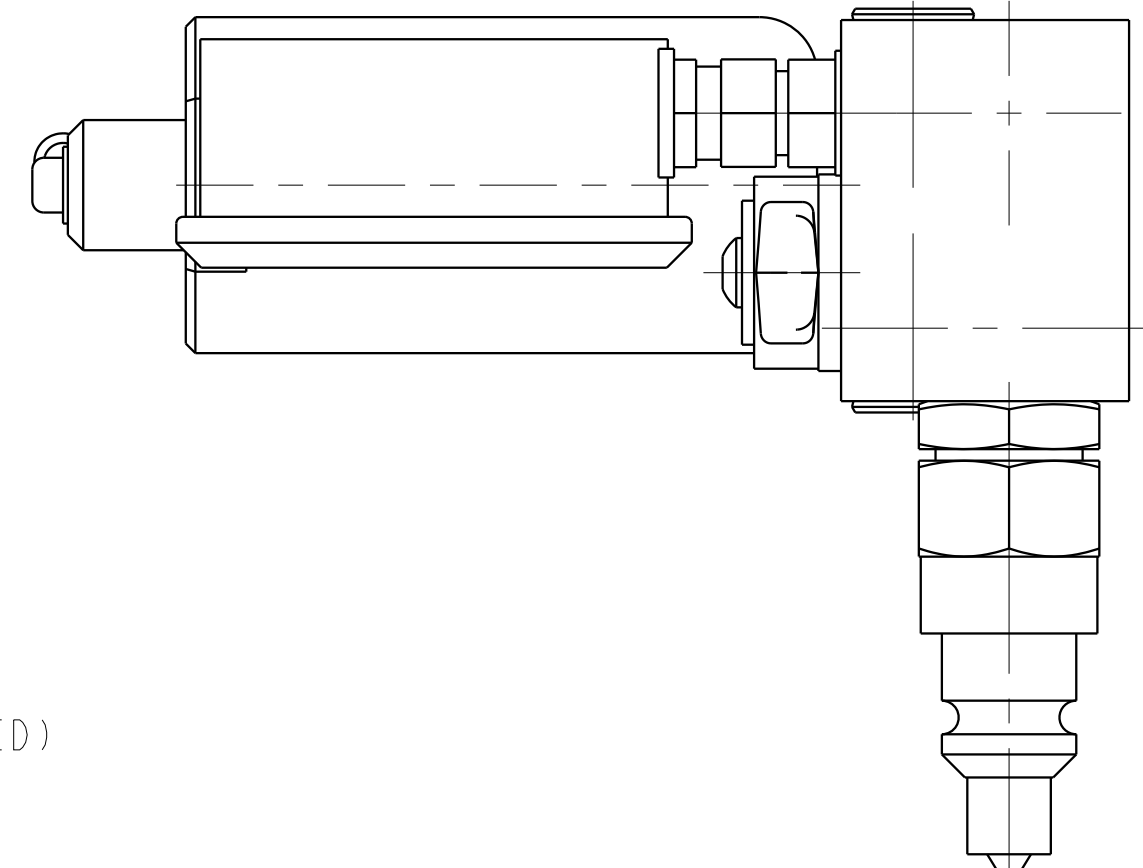

CAD CONTROL DRAWING



B	2947	RELEASE	GAR	1/6/16
REV	IN ACCORDANCE WITH ECN	EFFECTIVE DATE	REVISED BY	DATE
DRW BY:	K. ROEMER	DRAWING STATUS: Released		
DATE:	05-25-05	PRODUCTION APPROVED FOR RELEASED STATUS ONLY		

56000103	M
REFERENCE MODEL	REF REV
TOLERANCES DO NOT APPLY DIMENSIONS ARE NOMINAL	

PD, VERT, 1500 PSI, 1.0 CU IN ACC
SIZE D
ILC56000103
REV B