

ILC70443722 REV A ECN 3559

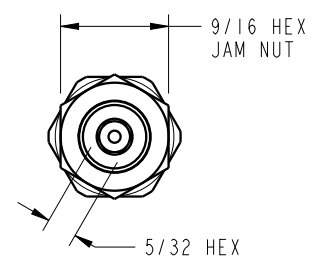
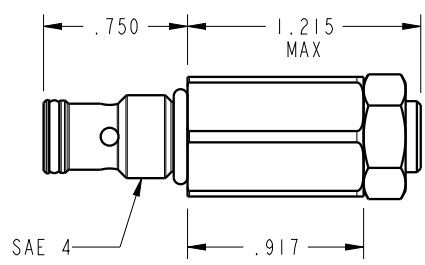
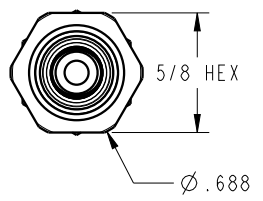

| | | | | | | | |
|--------------------------------|------------------------|---|------------|--|---|-----------------------------------|---------------------|
| CAD CONTROL DRAWING | | | | VEKTEK, INC. 1334 E. SIXTH AVE. P.O. BOX 625 EMPORIA, KS. 66801 U.S.A. | | | |
| | | | | | | ASSY, IP-SEQ, SAE, .750, 3000 PSI | |
| A | 3559 | RELEASE | ATHOMSEN | 22-AUG-2018 | 70443722 | A | ***** |
| REV | IN ACCORDANCE WITH ECN | EFFECTIVE DATE | REVISED BY | DATE | REFERENCE MODEL | REF REV | ***** |
| DRW BY: | ATHOMSEN | DRAWING STATUS: Released PRODUCTION APPROVED FOR RELEASED STATUS ONLY | | | TOLERANCES DO NOT APPLY DIMENSIONS ARE NOMINAL | SIZE B | ILC70443722 REV A |
| DATE: | 22-AUG-2018 | | | | | | FORM FEG036, Rev. B |