

CAD CONTROL
DRAWING

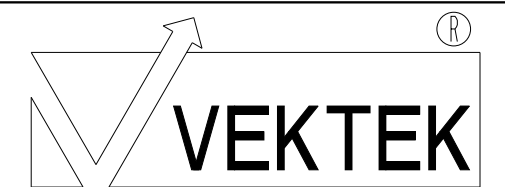

VEKTEK, INC.
1334 E. SIXTH AVE. P.O. BOX 625
EMPORIA, KS. 66801 U.S.A.

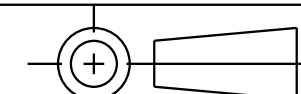

| | | | | |
|---------|------------------------|--|------------|---------|
| A | 3467 | RELEASE | MJUST | 11/6/18 |
| REV | IN ACCORDANCE WITH ECN | EFFECTIVE DATE | REVISED BY | DATE |
| DRW BY: | MJUST | DRAWING STATUS: Released | | |
| DATE: | 10/30/18 | PRODUCTION APPROVED FOR RELEASED STATUS ONLY | | |

| | |
|---|---------|
| 70941103 | B |
| REFERENCE MODEL | REF REV |
| TOLERANCES DO NOT APPLY DIMENSIONS ARE NOMINAL | |

| |
|--|
| MANIFOLD, PARALLEL, D03, 2 VALVE, 5000 PSI |
| SIZE D |
| ILC70941103 |
| REV A |