

ILC91521310 REV A ECN 739

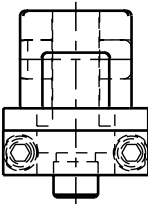

2	1	ILC91521309	ARM, SC, ROCKER, 2600
1	1	ILC91521308	ATCH, RKRA, 2600
No. QTY		PART No.	DESCRIPTION

**CAD CONTROL
DRAWING**

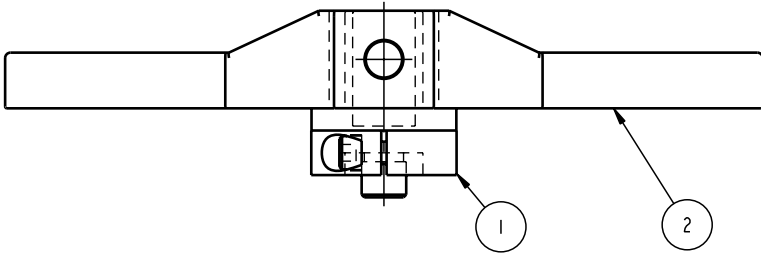

VEKTEK, INC.
1334 E. SIXTH AVE. P.O. BOX 625
EMPORIA, KS. 66801 U.S.A.



A	739	RELEASE	K. ROEMER	03-21-05	91521310	A	ASSY, RKRA, SC, 2600
REV	IN ACCORDANCE WITH ECN	EFFECTIVE DATE	REVISED BY	DATE	REFERENCE MODEL	REF REV	
DRW BY:	K. ROEMER	DRAWING STATUS: Released			TOLERANCES DO NOT APPLY	SIZE	ILC91521310
DATE:	10/23/02	PRODUCTION APPROVED FOR RELEASED STATUS ONLY			DIMENSIONS ARE NOMINAL	D	REV A

FORM FEG036, Rev. A

SHEET 1 OF 1