

ILC95595015 REV B ECN 4108

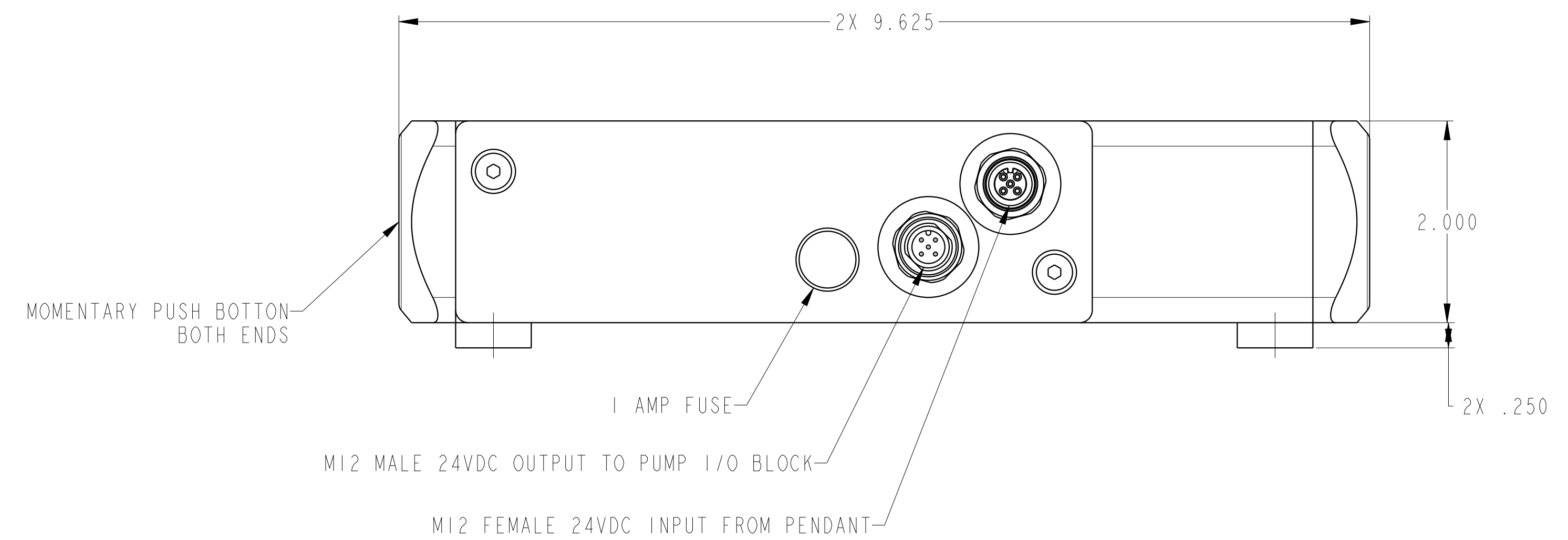

CAD CONTROL DRAWING

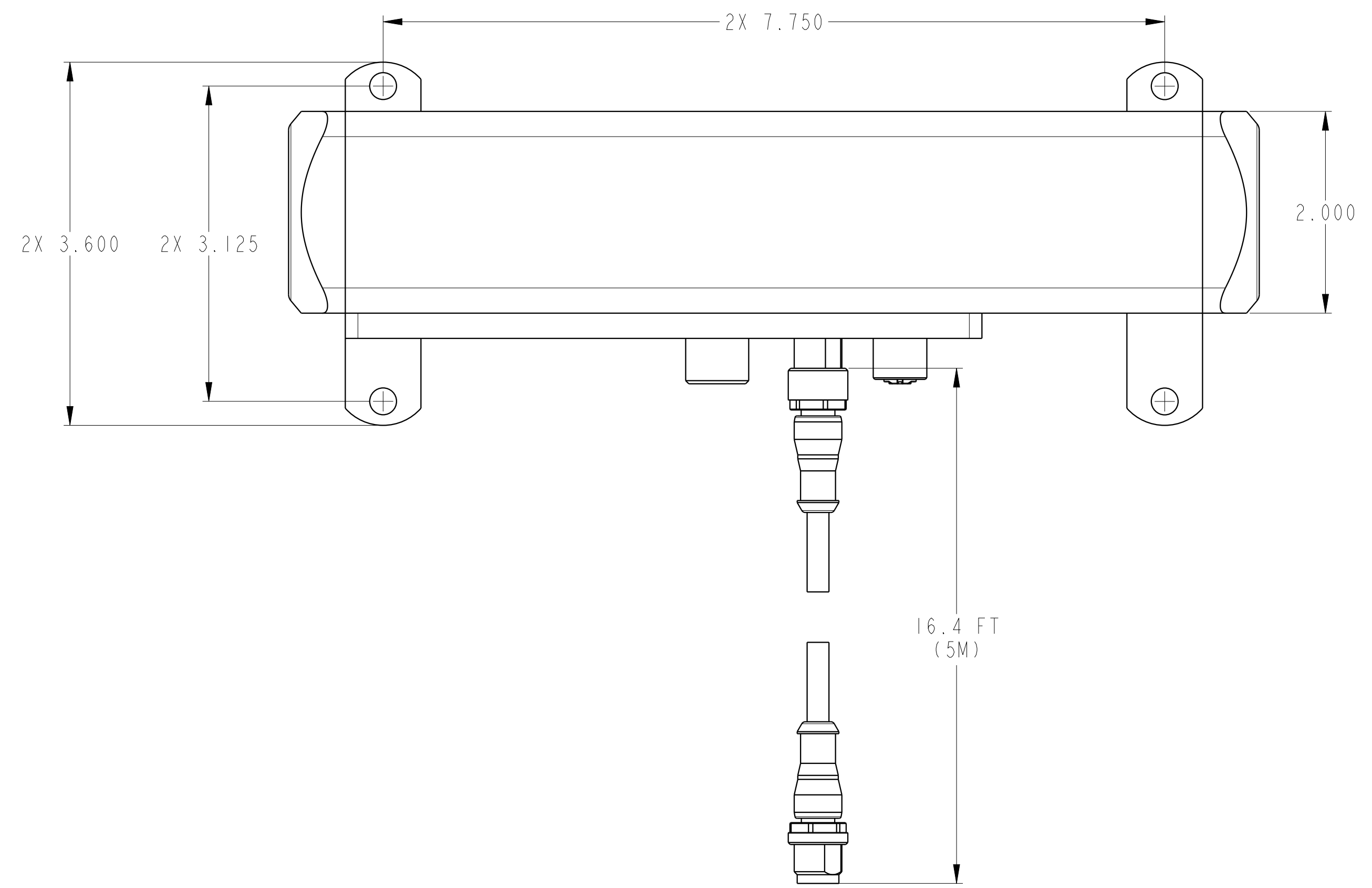
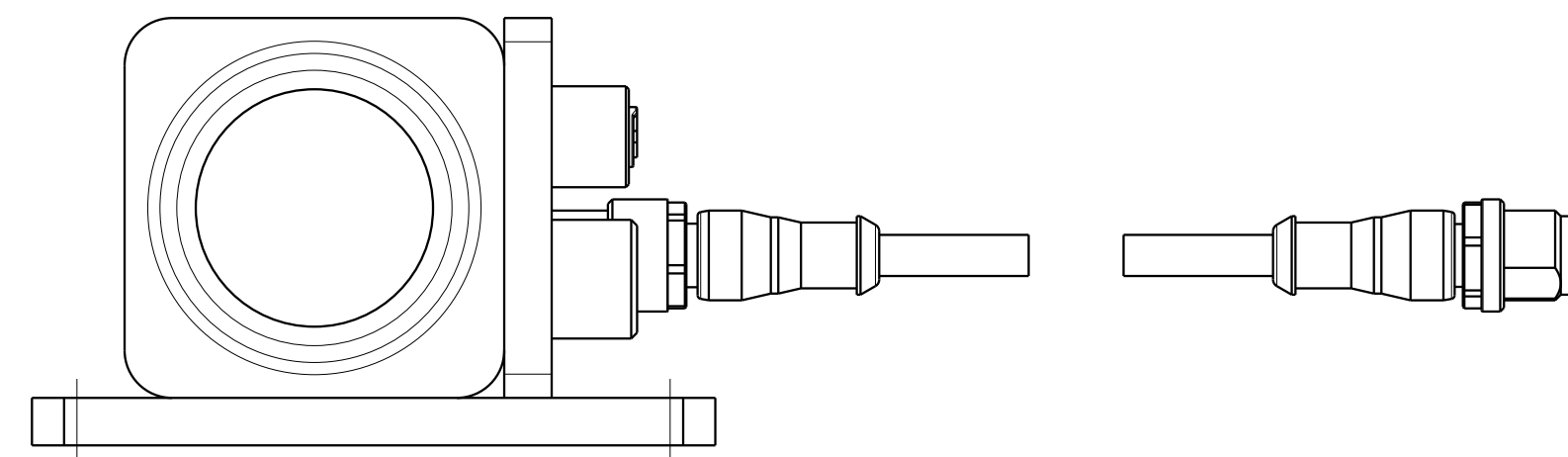
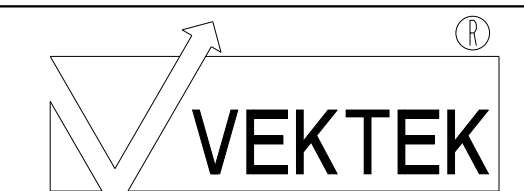

VEKTEK, INC.  
1334 E. SIXTH AVE. P.O. BOX 625  
EMPORIA, KS. 66801 U.S.A.

B	4108	RELEASE	NPETERS	2/20/20	95595015	B	CONTROL, 2-HAND, NTD, 24VDC I/O
REV	IN ACCORDANCE WITH ECN	EFFECTIVE DATE	REVISED BY	DATE	REFERENCE MODEL	REF REV	*****
DRW BY:	KR	DRAWING STATUS: <b>Released</b>			TOLERANCES DO NOT APPLY DIMENSIONS ARE NOMINAL		SIZE D
DATE:	07/20/17	PRODUCTION APPROVED FOR RELEASED STATUS ONLY					ILC95595015 REV B