

M12 X 1.75-6H  $\nabla$  12.95 [.51]

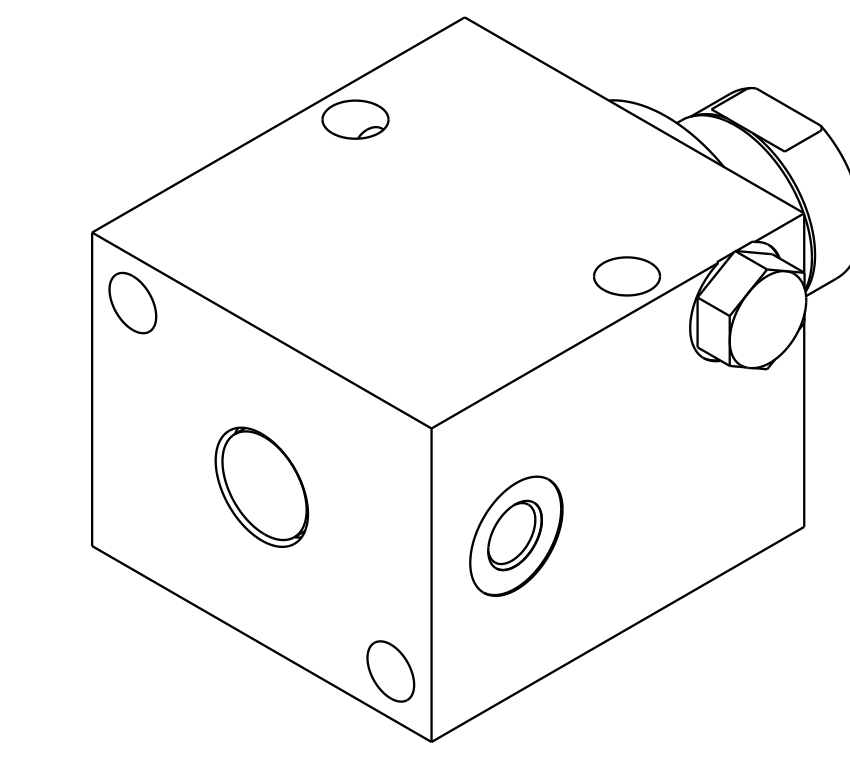
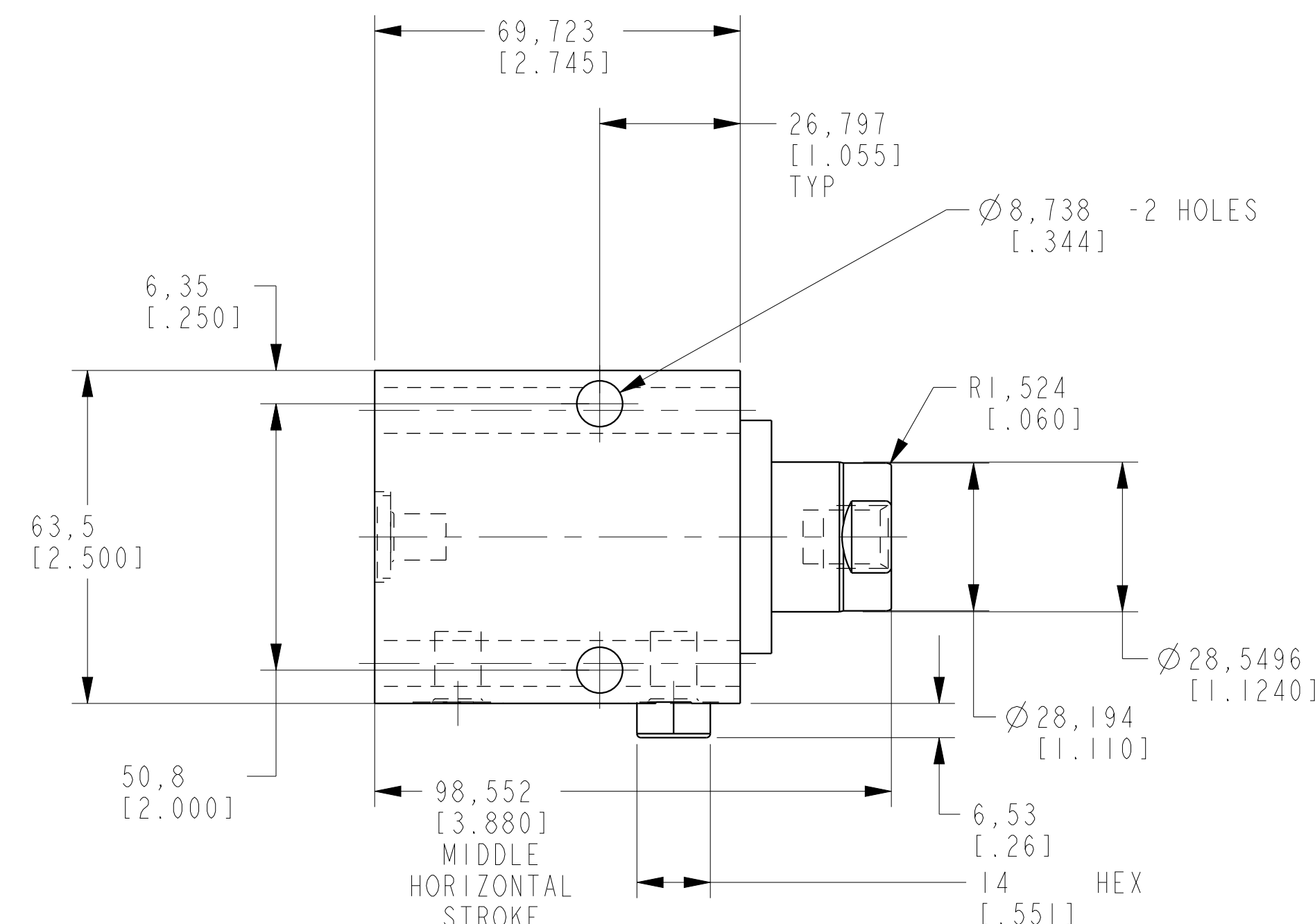

ILCM42011006 REV C ECN 3531

CAD CONTROL DRAWING		
	VEKTEK, INC. 1334 E. SIXTH AVE. P.O. BOX 625 EMPORIA, KS. 66801 U.S.A.	

C	3531	RELEASE	NPETERS	07/17/18	42011006	K	CYL, BB, 39.9 KN, 25.5 STRK, SA
REV	IN ACCORDANCE WITH ECN	EFFECTIVE DATE	REVISED BY	DATE	REFERENCE MODEL	REF REV	
DRW BY:	DRAWING STATUS: <b>Released</b>				TOLERANCES DO NOT APPLY	UNITS	SIZE
DATE:	PRODUCTION APPROVED FOR RELEASED STATUS ONLY				DIMENSIONS ARE NOMINAL	mm (inch)	D
							ILCM42011006
							REV C