

N/A	N/A	ISMI500	INSTALLATION SHEET	N/A	N/A	N/A
N/A	N/A	46100010	KIT, SPRING	N/A	N/A	NOTED
N/A	N/A	6V150106	KIT, SEAL, FKM	N/A	NOTED	N/A
N/A	N/A	46000017	KIT, SEAL, STANDARD	NOTED	N/A	N/A
17	1	39T55001	GASKET, (-113)	X	X	X
16	1	81590501	ROD, SUPPORT, SPRING, SC, 450			X
15	1	81530500	RETAINER, SC, 450			
14	1	49001904	BREATHER, 1/8 BSPP			
13	1	47510500	PLUNGER, SC, 2.0 kN			
12	1	43068004	PLUG, SOCH, G1/8			
11	1	39053004	WIPER, SNAP-IN, (7/16)	X	X	
10	2	39050042	O-RING, (-011)	X	39051025	X
9	1	39010038	SEAL, BEVEL, 7/16 x 3/32 x 5/8	X	39052014	
8	1	39010036	SEAL, BEVEL, 3/8 x 3/32 x 9/16	X	39052010	
7	1	39000032	O-RING, (.070 x .040)	X	39051020	
6	2	23600014	BALL, STEEL, ALLOY, .156	X	X	X
5	1	23311017	SPRING, COMPRESSION			X
4	1	23310008	SPRING, COMPRESSION			X
3	2	21500200	WASHER			
2	2	21500018	SCREW, CAP, SOCH, M3 X 5, ALY			
1	1	21500008	SCREW, CAP, BTNH, M6 X 10, ALY			
No.	QTY	PART No.	DESCRIPTION	Standard Seal Kit	FKM Seal Kit	Spring Kit

Assemble with lip side facing bottom of body

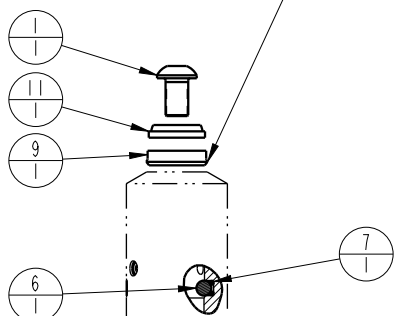

Body- Not Replaceable

Tighten to 1.2 Nm (11 in-lbs) torque

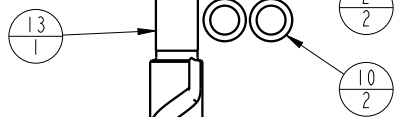

Assemble with lip side facing top of plunger

Coat ball with lithium grease

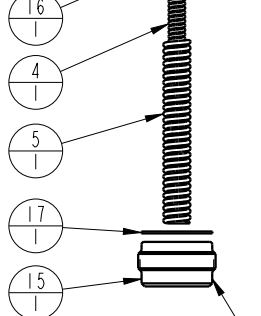

Tighten to 13.6 Nm (10 ft-lbs) torque

Tighten to 18 Nm (13 ft-lbs) torque

Lubricate all seals with clean hydraulic fluid prior to assembly. Do Not Use Silicone Based Lubricants.



PARTS LIST



VEKTEK, INC.
1334 E. SIXTH AVE. P.O. BOX 625
EMPORIA, KS. 66801 U.S.A.

ASSEMBLIES AFFECTED

PARTS LIST, ASSY, SC, BF, 2kN, SA, VersaCam

41520211

41520212

41520215

SIZE
A

MPL1535

REV
N

N	3957	RELEASE	JDW	10/24/19
REV	IN ACCORDANCE WITH ECN	EFFECTIVE DATE	REVISED BY	DATE
DRW BY:	COMBES	DRAWING STATUS: Released		
DATE:	04/06/99	PRODUCTION APPROVED FOR RELEASED STATUS ONLY		

FORM FEG035_PL_ASIZE, REV. B

SHEET 1 OF 1

1

2

B

B

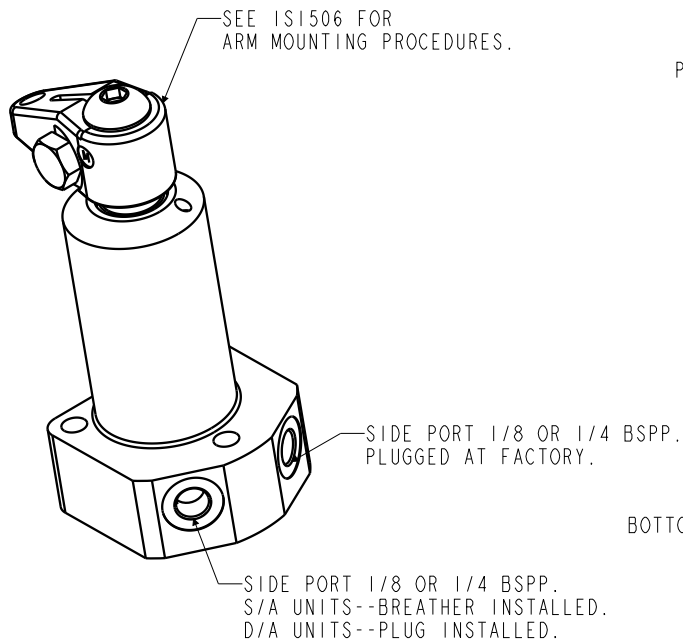

TWO MANIFOLD MOUNT O-RINGS PROVIDED WITH THE ASSEMBLY.

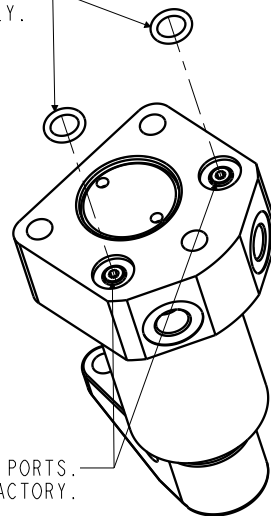

BOTTOM O-RING MANIFOLD MOUNT PORTS. ALL PORTS PLUGGED AT FACTORY.

PLUMBING CONNECTIONS:
 SIDE PORTS--REMOVE PLUG(S) AND INSTALL PROPER FITTING.
 BOTTOM O-RING MANIFOLD MOUNT PORTS--REMOVE PLUG(S). INSERT O-RING(S)
 AND MOUNT TO THE MANIFOLD MOUNTING SURFACE.
 MANIFOLD MOUNTING SURFACE TO BE FLAT WITHIN .08 mm WITH A MAXIMUM SURFACE FINISH OF 2 μm R_a.

A

A

INSTALLATION INSTRUCTIONS



VEKTEK, INC.
 1334 E. SIXTH AVE. P.O. BOX 625
 EMPORIA, KS. 66801 U.S.A.

C	3958	RELEASE	JDW	10/31/19
REV	IN ACCORDANCE WITH ECN	EFFECTIVE DATE	REVISED BY	DATE
DRW BY:	BUSH	DRAWING STATUS: Released		
DATE:	01/02/94	PRODUCTION APPROVED FOR RELEASED STATUS ONLY		

ASSEMBLIES AFFECTED
 ALL METRIC
 FLANGE MOUNTED
 SWING CLAMPS

INSTALLATION INSTRUCTIONS, SC, BF, METRIC			
SIZE	ISMI500	REV	C
A			

1

2

FORM FEG041-IS-ASIZE, REV. B

SHEET 1 OF 1