

N/A	N/A	6V150214	KIT, SEAL, FKM	N/A	NOTED
N/A	N/A	60150500	KIT, SEAL, STANDARD	NOTED	N/A
13	1	39T55003	GASKET, (-124)	X	X
12	1	81531301	RETAINER, SC, 2600		
11	1	47511300	PLUNGER, SC, 11.6 kN		
10	2	43068006	PLUG, PORT, HOLLOW HEX, G1/4		
9	1	39053000	WIPER, SNAP-IN, (7/8)	X	X
8	2	39050042	O-RING, (-011)	X	39051025
7	1	39011046	SEAL, BEVEL W/HEEL INSERT, 7/8 x1/8 x1-1/4	X	39052003
6	1	39011030	SEAL, CROWN, 1-1/16x1-1/4x5/32	X	39V11030
5	1	39000020	O-RING, (-005)	X	39051007
4	1	23600002	BALL, STEEL, ALLOY, .250	X	X
3	2	21500200	WASHER		
2	2	21500019	SCREW, CAP, BTNH, M3 X 6, ALY		
1	1	21500010	SCREW, CAP, BTNH, M12 X 20, ALY		
No.	QTY	PART No.	DESCRIPTION	Standard Seal Kit	FKM Seal Kit

Assemble with lip side facing bottom of body

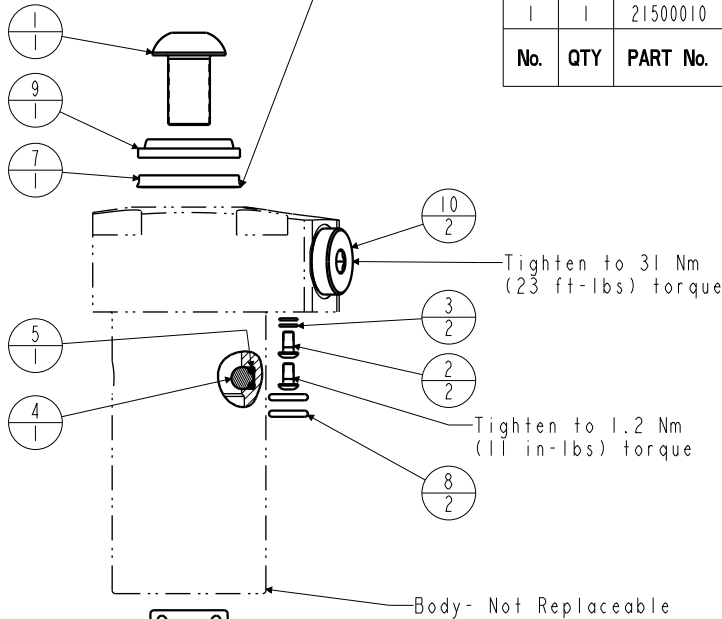

Lubricate all seals with clean hydraulic fluid prior to assembly.
Do Not Use Silicone Based Lubricants.



PARTS LIST



VEKTEK, INC.
1334 E. SIXTH AVE. P.O. BOX 625
EMPORIA, KS. 66801 U.S.A.

ASSEMBLIES AFFECTED

PARTS LIST, ASSY, SC, TF, 11.6KN, DA, VersaCam

41561121
41561122
41561125

SIZE
A

MPL1560

REV
P

P	3925	RELEASE	JDW	10/22/19
REV	IN ACCORDANCE WITH ECN	EFFECTIVE DATE	REVISED BY	DATE
DRW BY:	COMBES	DRAWING STATUS: Released		
DATE:	03/16/99	PRODUCTION APPROVED FOR RELEASED STATUS ONLY		

FORM FEG035_PL_ASIZE, REV. B

SHEET 1 OF 1