



VEKTEK, INC.
1334 E. SIXTH AVE.
P.O. BOX 625
EMPORIA, KS. 66801
U.S.A.

PARTS LIST

MPL-1565

Model Numbers: 41-5622-21

REV L
ECN 2721
DRAWN/DATE ROMINE
06/08/00

UNIT WITH PLUNGER CLUTCH MODELS THAT APPLY

6951K-22-21-L , Revision A & Later
6951KN-22-21 , Revision D & Earlier

ASSY, SC, LP, TF, 22KN, DA, RH

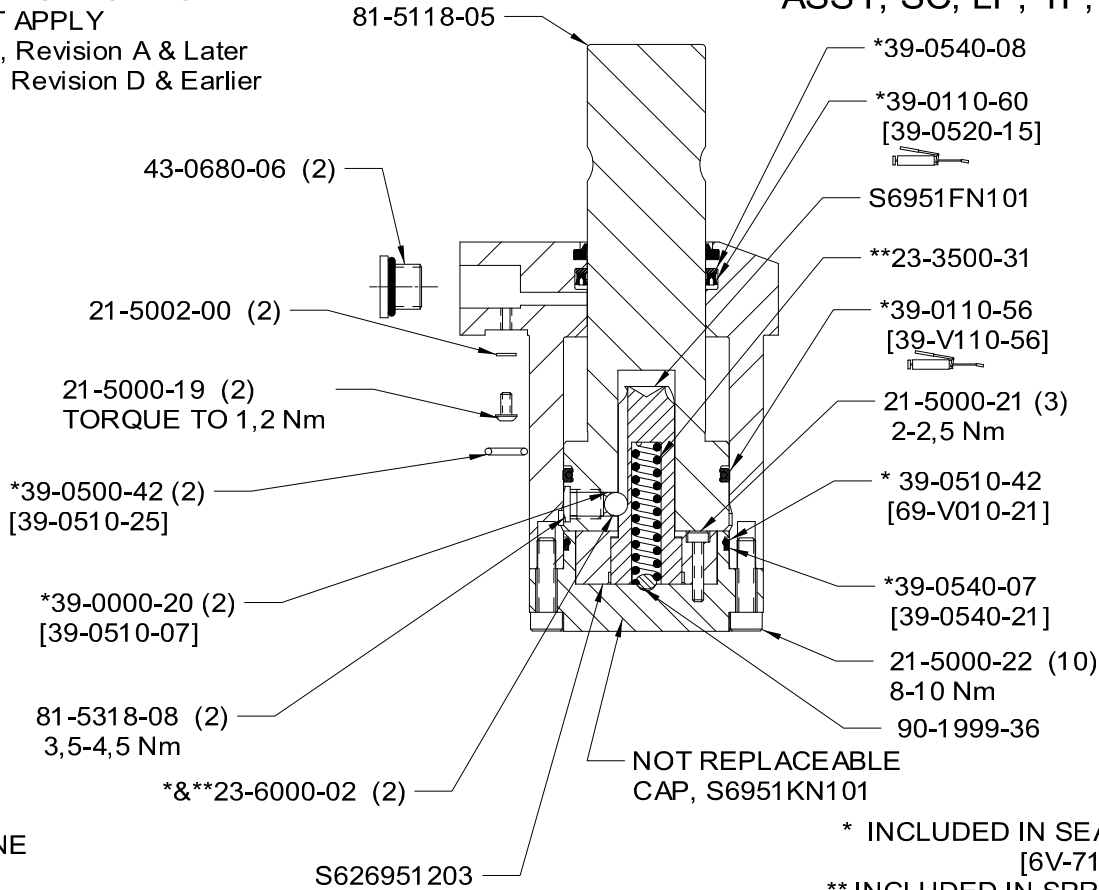

* INCLUDED IN SEAL KIT 60-7110-03
[6V-7110-03]
** INCLUDED IN SPRING KIT 61-7040-02

UNIT WITHOUT PLUNGER CLUTCH

AS OF 11/09/04

MODELS THAT APPLY

41-5622-21 , Revision A & Later
6951KN-22-21 , Revision E & Later

ASSY, SC, LP, TF, 22KN, DA, RH

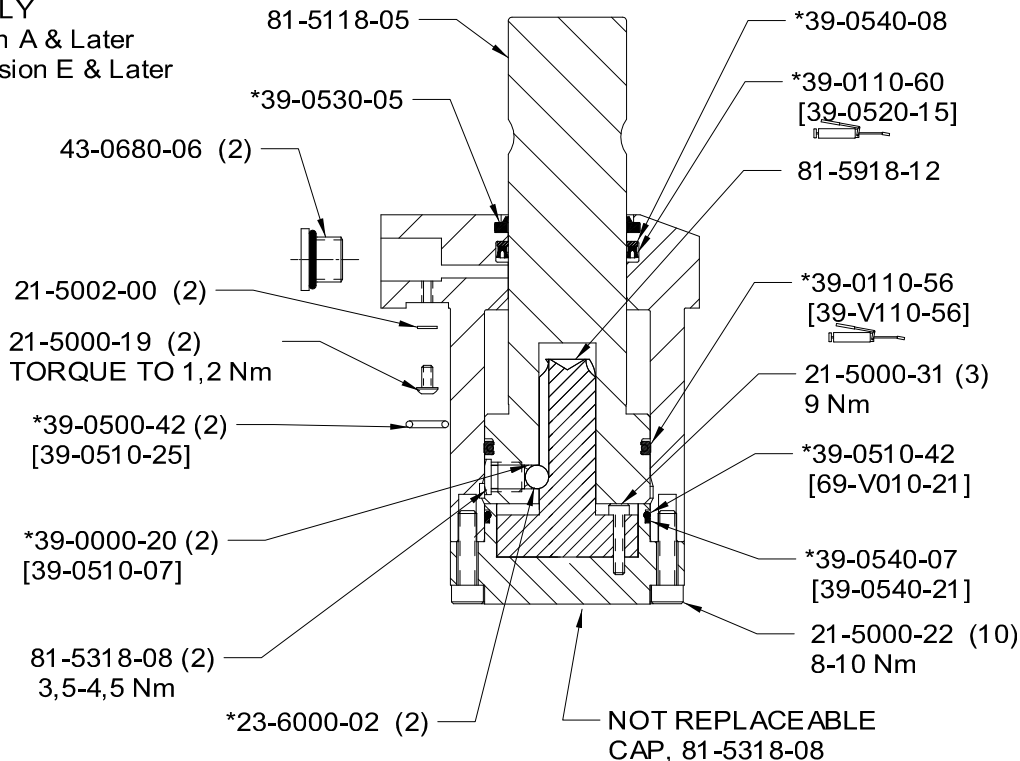

* INCLUDED IN SEAL KIT 60-7110-03
[6V-7110-03]