



VEKTEK, INC.  
1334 E. SIXTH AVE.  
P.O. BOX 625  
EMPORIA, KS. 66801  
U.S.A.

## PARTS LIST

Model  
Numbers:

41-5222-20

MPL-1570

REV L  
ECN 2721

DRAWN/DATE  
ROMINE  
06/08/00

### UNIT WITH PLUNGER CLUTCH

#### MODELS THAT APPLY

6951FZ-22-20-L, Revision A & Later  
6951FZN-22-20, Revision B & Earlier

### ASSY, SC, LP, BF, 22KN, DA, STR

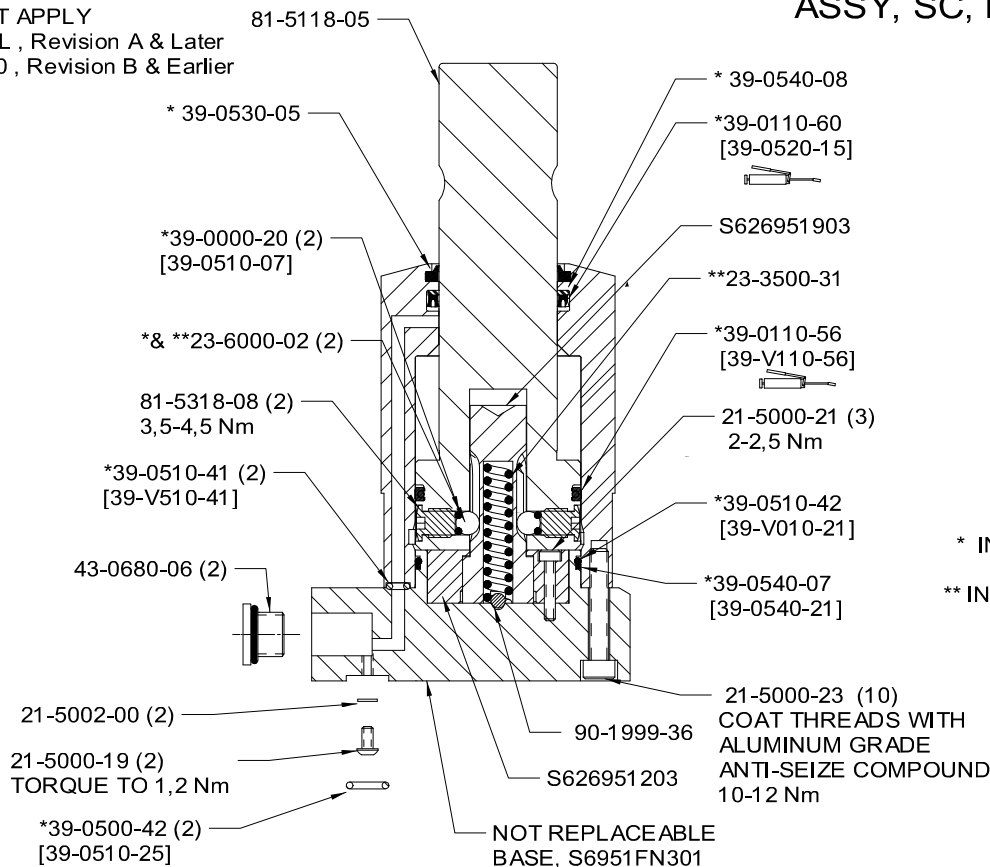

\* INCLUDED IN SEAL KIT 60-7110-04  
[6V-7110-10]  
\*\* INCLUDED IN SPRING KIT 61-7040-02

### UNIT WITHOUT PLUNGER CLUTCH

AS OF 11/09/04

#### MODELS THAT APPLY

41-5222-20, Revision A & Later  
6951FZN-22-20, Revision C & Later

### ASSY, SC, LP, BF, 22KN, DA, STR

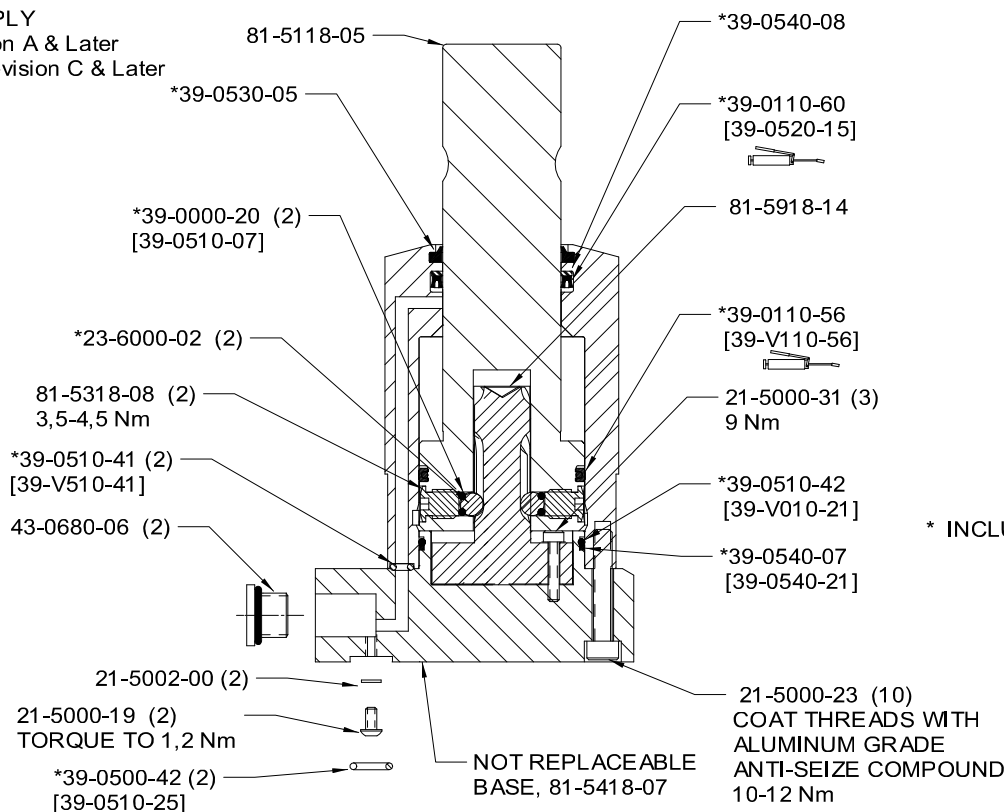

\* INCLUDED IN SEAL KIT 60-7110-04  
[6V-7110-10]