



**VEKTEK, INC.**  
 1334 E. SIXTH AVE.  
 P.O. BOX 625  
 EMPORIA, KS. 66801  
 U.S.A.

**PARTS LIST**

Model Numbers: **41-5222-22**

**MPL-1572**

REV M  
 ECN 2721  
 DRAWN/DATE  
 ROMINE  
 06/08/00

**UNIT WITH PLUNGER CLUTCH**  
 MODELS THAT APPLY  
 6951F-22-22-L , Revision A & Later  
 6951FN-22-22 , Revision E & Earlier

**ASSY, SC, BF, LP, 22KN, DA, LH**

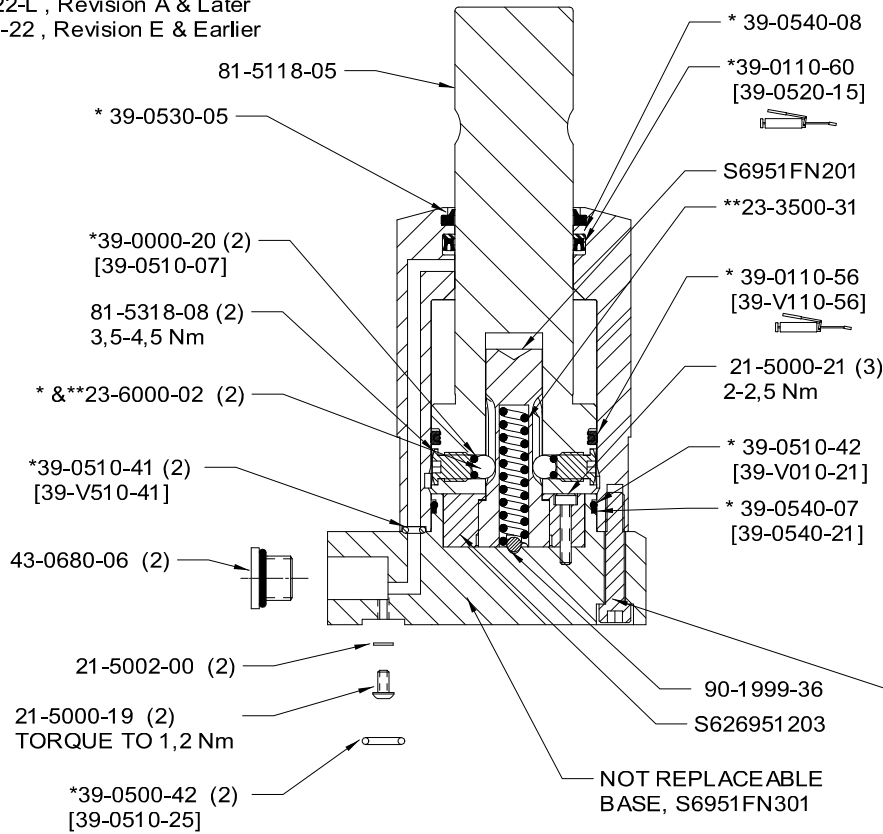

\* INCLUDED IN SEAL KIT 60-7110-04 [6V-7110-10]  
 \*\* INCLUDED IN SPRING KIT 61-7040-02

21-5000-23 (10)  
 COAT THREADS WITH  
 ALUMINUM GRADE  
 ANTI-SEIZE COMPOUND  
 10-12 Nm

**UNIT WITHOUT PLUNGER CLUTCH**  
 AS OF 11/09/04  
 MODELS THAT APPLY  
 41-5222-22 , Revision A & Later  
 6951FN-22-22 , Revision F & Later

**ASSY, SC, BF, LP, 22KN, DA, LH**

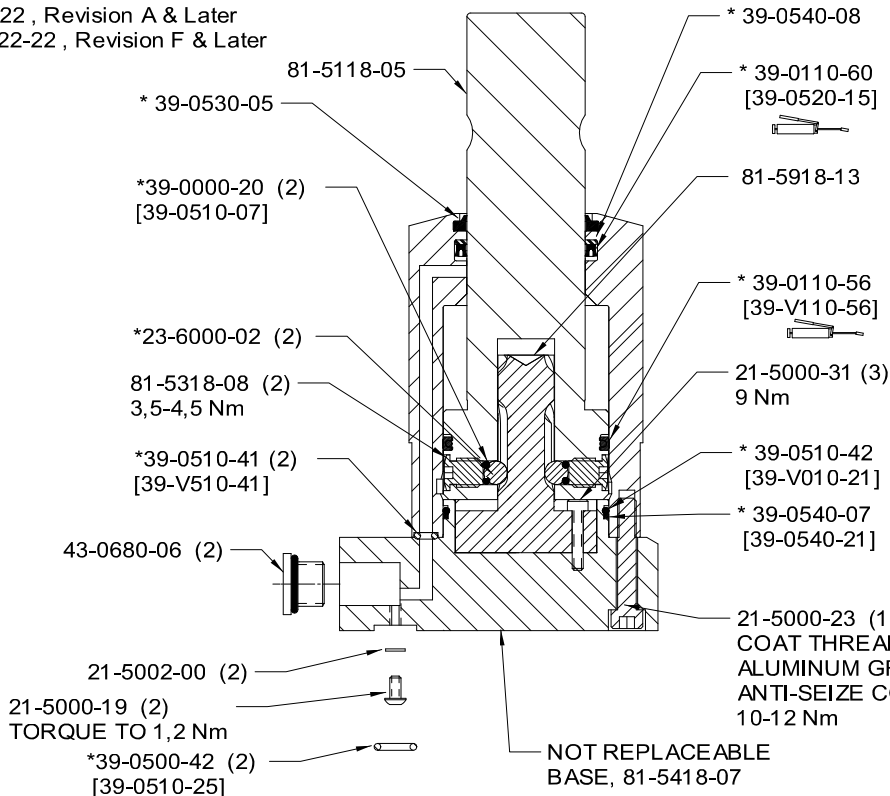

\* INCLUDED IN SEAL KIT 60-7110-04 [6V-7110-10]