



**VEKTEK, INC.**  
 1334 E. SIXTH AVE.  
 P.O. BOX 625  
 EMPORIA, KS. 66801  
 U.S.A

# PARTS LIST

**MPL-1579**

Model Numbers: **41-5222-10**

REV J  
 ECN 2721

DRAWN/DATE

ROMINE  
 06/08/00

## ASSY, SC, LP, BF, 22KN, SA, STR

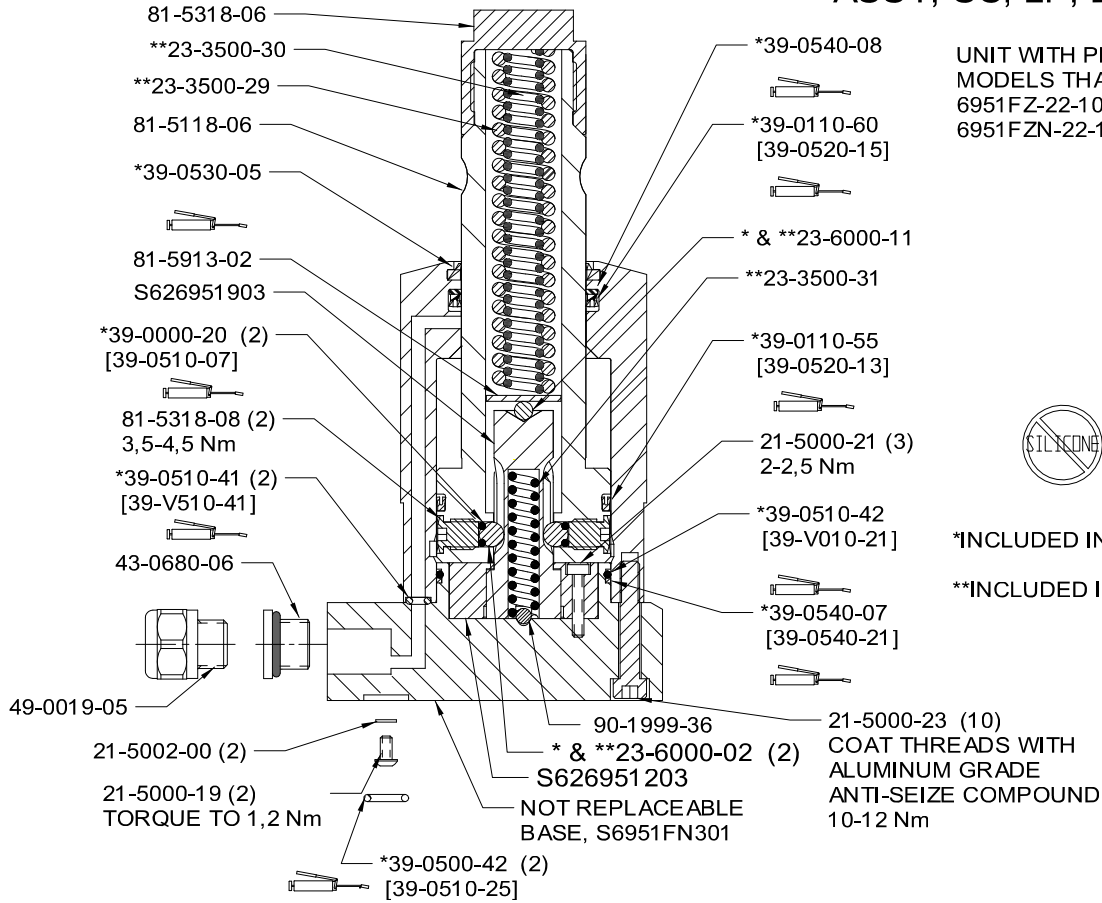

UNIT WITH PLUNGER CLUTCH  
 MODELS THAT APPLY  
 6951FZ-22-10-L , Revision A & Later  
 6951FZN-22-10 , Revision B & Earlier

\*INCLUDED IN SEAL KIT No. 60-7110-06 [6V-7110-09]  
 \*\*INCLUDED IN SPRING KIT No. 61-7040-03

## ASSY, SC, LP, BF, 22KN, SA, STR

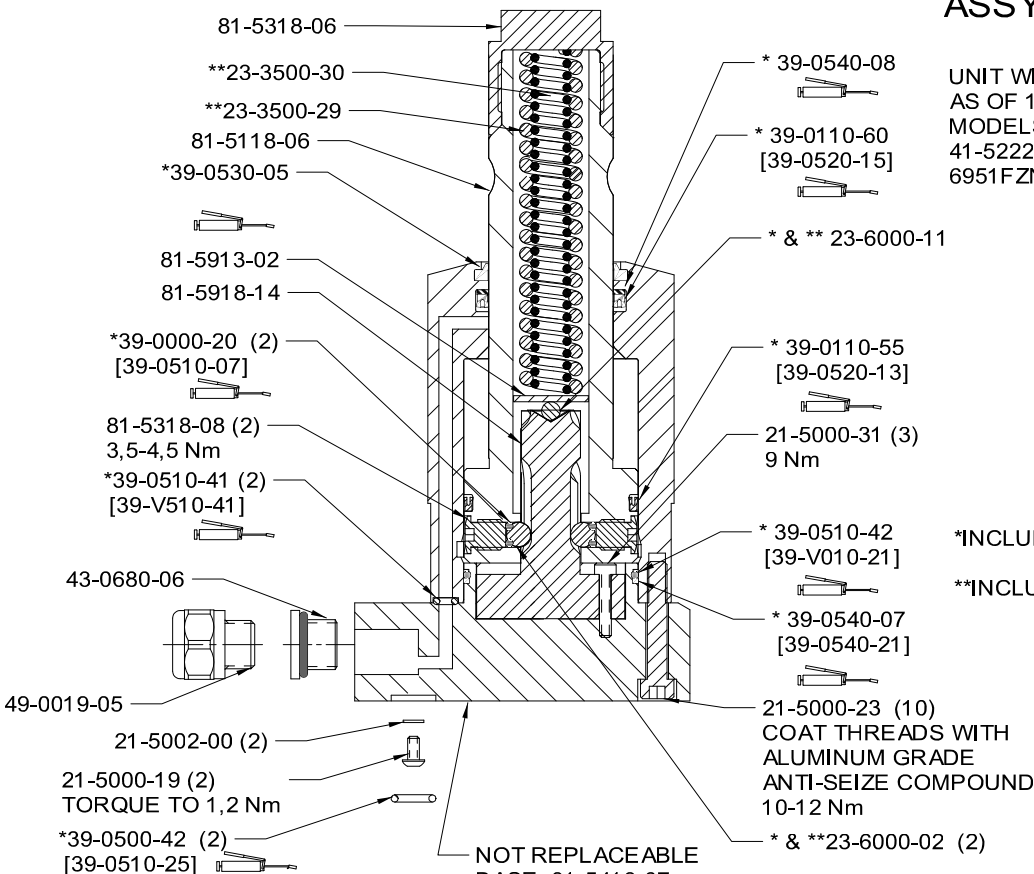

UNIT WITHOUT PLUNGER CLUTCH  
 AS OF 11/09/04  
 MODELS THAT APPLY  
 41-5222-10 , Revision A & Later  
 6951FZN-22-10 , Revision C & Later

\*INCLUDED IN SEAL KIT No. 60-7110-06 [6V-7110-09]  
 \*\*INCLUDED IN SPRING KIT No. 61-7040-08