



VEKTEK, INC.
1334 E. SIXTH AVE.
P.O. BOX 625
EMPORIA, KS. 66801
U.S.A.

PARTS LIST

MODEL NUMBERS: 41-5222-11

MPL-1580

REV M
ECN 2721

DRAWN/DATE
ROMINE
06/08/00

ASSY, SC, LP, BF, 22KN, SA, RH

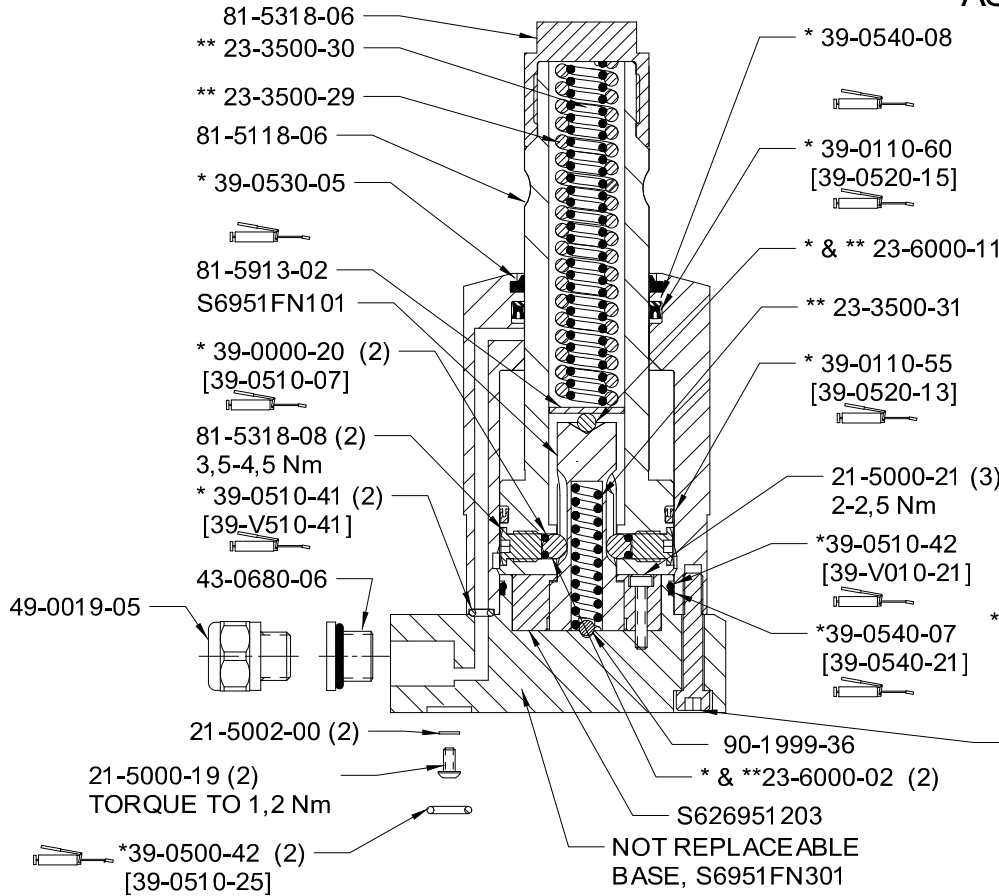

UNIT WITH PLUNGER CLUTCH
MODELS THAT APPLY
6951F-22-11-L, Revision A & Later
6951FN-22-11, Revision D & Earlier



*INCLUDED IN SEAL KIT No. 60-7110-06
[6V-7110-09]
**INCLUDED IN SPRING KIT No. 61-7040-03

21-5000-23 (10)
COAT THREADS WITH
ALUMINUM GRADE
ANTI-SEIZE COMPOUND
10-12 Nm

ASSY, SC, LP, BF, 22KN, SA, RH

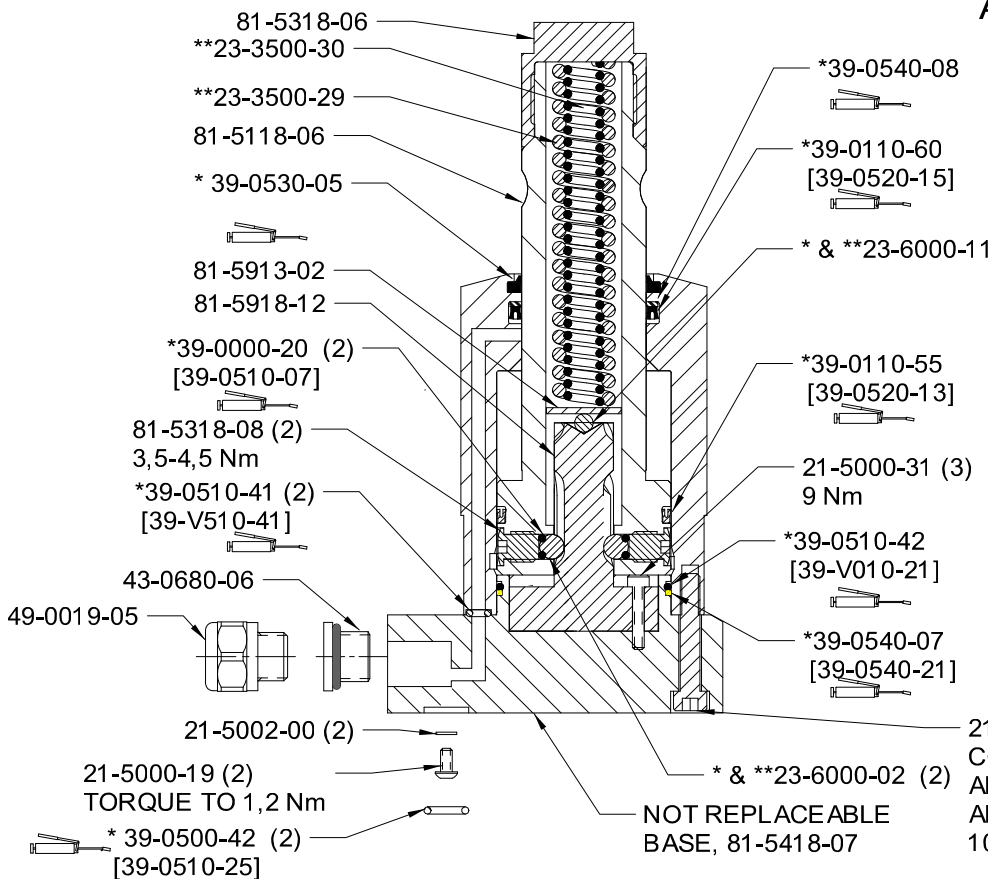

UNIT WITHOUT PLUNGER CLUTCH
AS OF 11/09/04
MODELS THAT APPLY
41-5222-11, Revision A & Later
6951FN-22-11, Revision E & Later



* INCLUDED IN SEAL KIT No. 60-7110-06
[6V-7110-09]
** INCLUDED IN SPRING KIT No. 61-7040-08

21-5000-23 (10)
COAT THREADS WITH
ALUMINUM GRADE
ANTI-SEIZE COMPOUND
10-12 Nm