



VEKTEK, INC.
1334 E. SIXTH AVE.
P.O. BOX 625
EMPORIA, KS. 66801
U.S.A.

PARTS LIST

MPL-1595

Model
Numbers: 41-5633-22

REV J
ECN 2721

DRAWN/DATE
ROMINE
08/01/01

ASSY, SC, LP, TF, 33KN, DA, LH

UNIT WITH PLUNGER CLUTCH
MODELS THAT APPLY
6951KN-33-22, Revision A

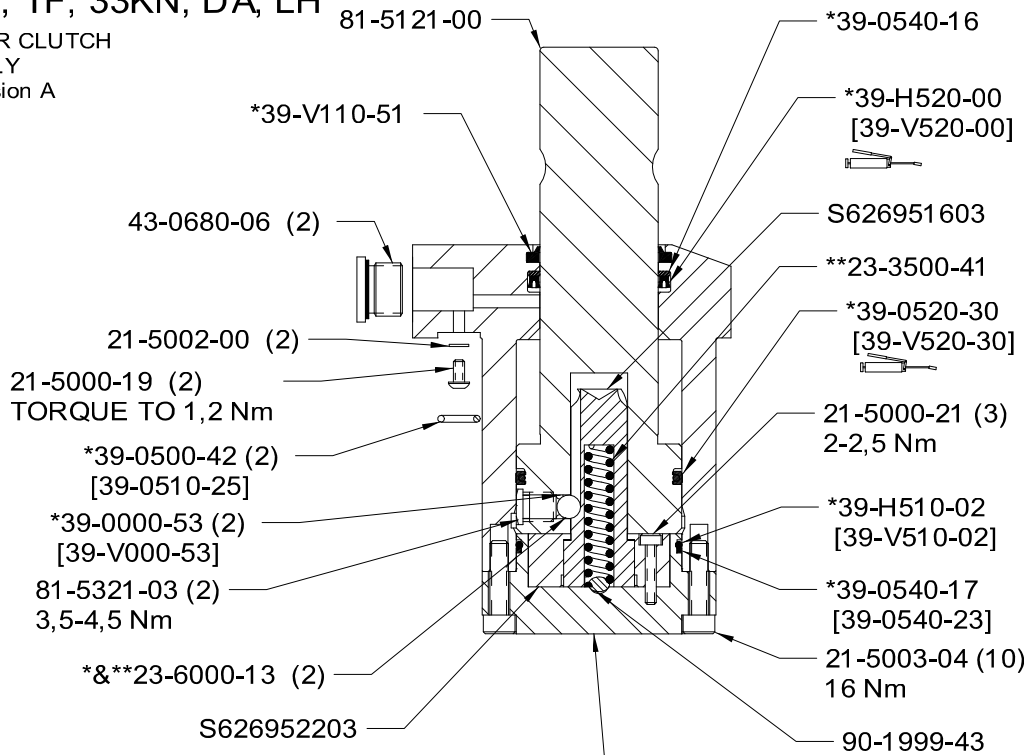

NOT REPLACEABLE
CAP, S626952303

*INCLUDED IN STANDARD SEAL KIT No. 60-7110-11
FLUOROCARBON SEAL KIT No. [6V-7110-11]
**INCLUDED IN SPRING KIT No. 61-7040-07

ASSY, SC, LP, TF, 33KN, DA, LH

UNIT WITHOUT PLUNGER CLUTCH
AS OF 11/09/04
MODELS THAT APPLY
41-5633-22, Revision A & Later
6951KN-33-22, Revision B & Later

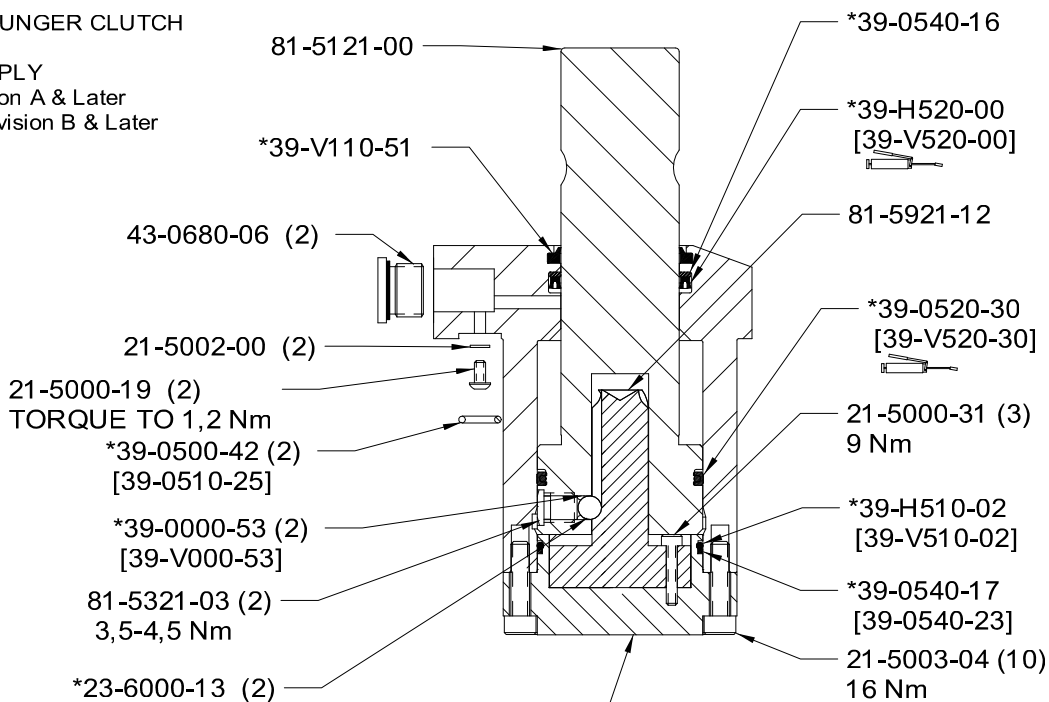

NOT REPLACEABLE
CAP, 81-5321-05

*INCLUDED IN STANDARD SEAL KIT No. 60-7110-11
FLUOROCARBON SEAL KIT No. [6V-7110-11]