

THIS IS A TWO PAGE PARTS LIST.
THIS FIRST PAGE APPLIES TO
MODELS 45-0485-01 & L5-0485-01
AT REVISION B AND LATER REVISIONS.

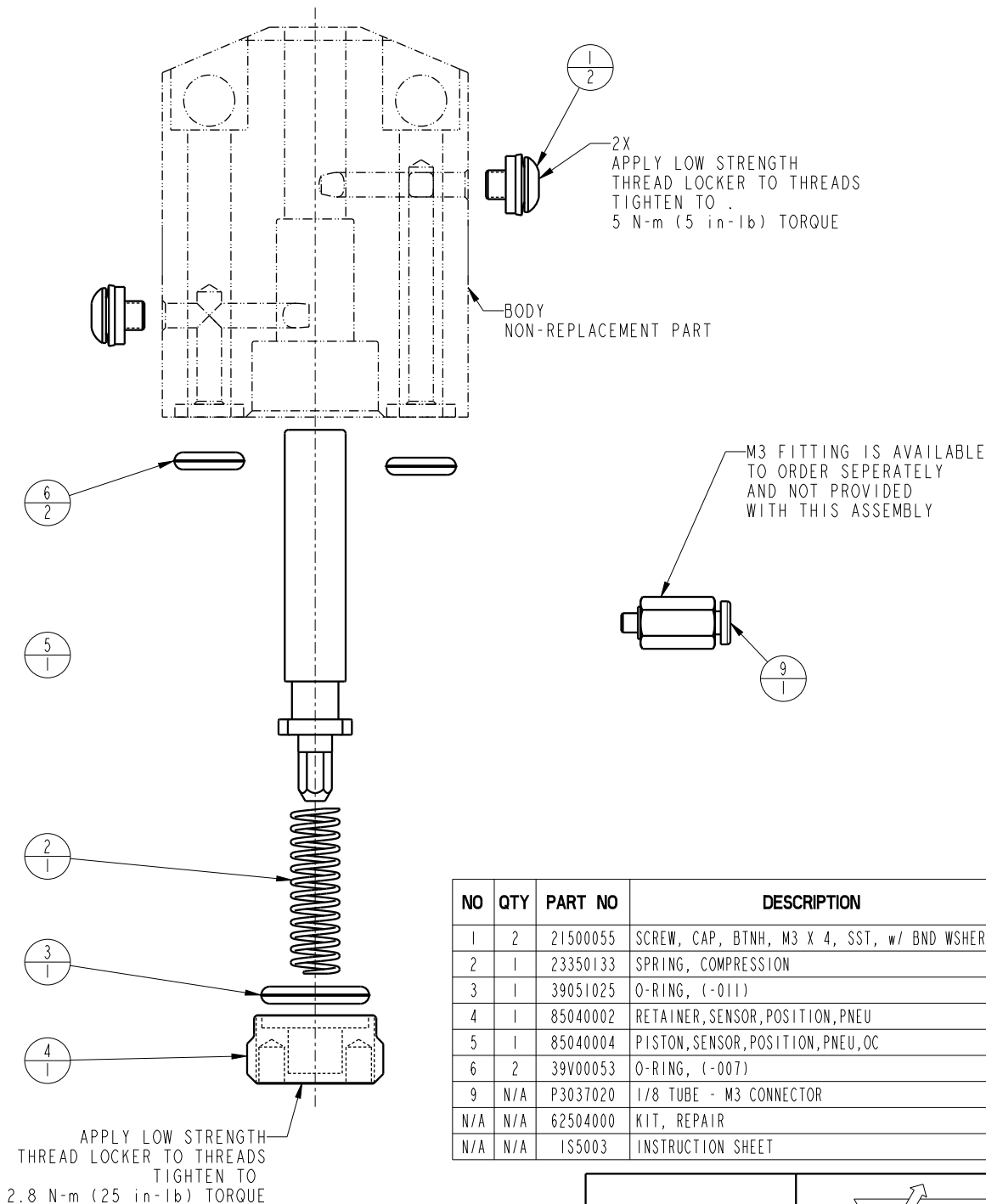

NO	QTY	PART NO	DESCRIPTION	REPAIR KIT
1	2	21500055	SCREW, CAP, BTNH, M3 X 4, SST, w/ BND WSHR	X
2	1	23350133	SPRING, COMPRESSION	X
3	1	39051025	O-RING, (-011)	X
4	1	85040002	RETAINER, SENSOR, POSITION, PNEU	
5	1	85040004	PISTON, SENSOR, POSITION, PNEU, OC	
6	2	39V00053	O-RING, (-007)	X
9	N/A	P3037020	1/8 TUBE - M3 CONNECTOR	
N/A	N/A	62504000	KIT, REPAIR	NOTED
N/A	N/A	1S5003	INSTRUCTION SHEET	

PARTS LIST

ASSEMBLIES AFFECTED
45-0485-01
L5-0485-01

VEKTEK

VEKTEK, INC.
1334 E. SIXTH AVE. EMPORIA, KS. 66801

P.O. BOX 625
U.S.A.

PARTS LIST, ASSY, SENSOR, POSITION, PNEU, OC

SIZE
A

MPL6904

REV
D

D	5164	RELEASE	RLK	8/28/23
REV	IN ACCORDANCE WITH ECN	EFFECTIVE DATE	REVISED BY	DATE
DRW BY: MAJ	DRAWING STATUS: Released			
DATE: 11-11-16	PRODUCTION APPROVED FOR RELEASED STATUS ONLY			

@ Copyright 1986-2024 by Vektex LLC ****See Vektex.com>Products>Maintenance for special tools's

THIS IS A TWO PAGE PARTS LIST.
THIS SECOND PAGE APPLIES TO
MODELS 45-0485-01 & L5-0485-01 AT REVISION A.

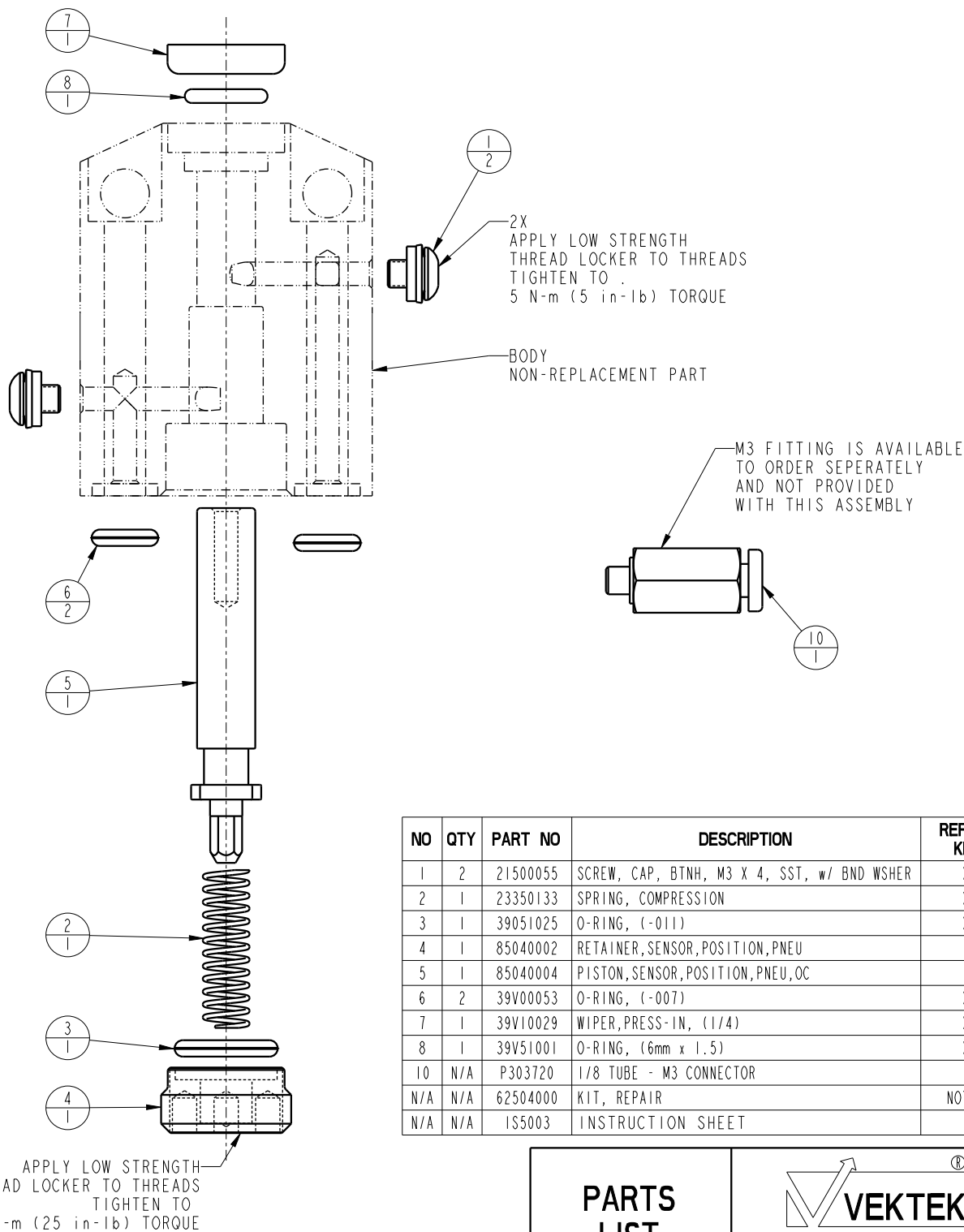

NO	QTY	PART NO	DESCRIPTION	REPAIR KIT
1	2	21500055	SCREW, CAP, BTNH, M3 X 4, SST, w/ BND WSHR	X
2	1	23350133	SPRING, COMPRESSION	X
3	1	39051025	O-RING, (-011)	X
4	1	85040002	RETAINER,SENSOR,POSITION,PNEU	
5	1	85040004	PISTON,SENSOR,POSITION,PNEU,OC	
6	2	39V00053	O-RING, (-007)	X
7	1	39V10029	WIPER,PRESS-IN, (1/4)	X
8	1	39V51001	O-RING, (6mm x 1.5)	X
10	N/A	P303720	1/8 TUBE - M3 CONNECTOR	
N/A	N/A	62504000	KIT, REPAIR	NOTED
N/A	N/A	IS5003	INSTRUCTION SHEET	

PARTS LIST



VEKTEK, INC.
1334 E. SIXTH AVE. P.O. BOX 625
EMPORIA, KS. 66801 U.S.A.

ASSEMBLIES AFFECTED
45-0485-01
L5-0485-01

PARTS LIST, ASSY,SENSOR,POSITION,PNEU,OC

SIZE
A

MPL6904

REV
D

SHEET 2 OF 2

FORM FEG035_PL.ASIZE, REV. B

D	5164	RELEASE	RLK	8/28/23
REV	IN ACCORDANCE WITH ECN	EFFECTIVE DATE	REVISED BY	DATE
DRW BY: MAJ	DRAWING STATUS: Released			
DATE: 11/11/16	PRODUCTION APPROVED FOR RELEASED STATUS ONLY			