



VEKTEK, INC.
 1334 E. SIXTH AVE.
 P.O. BOX 625
 EMPORIA, KS. 66801
 U.S.A.

PARTS LIST

MPL-7022

REV J
 ECN 2721

DRAWN/DATE
 ROMINE
 08/01/01

MODEL
 NUMBERS: 41-5633-24

ASSY, SC, LP, TF, 33KN, DA, LH, LS

UNIT WITH PLUNGER CLUTCH
 MODELS THAT APPLY
 6951KN-33-220 , Revision A

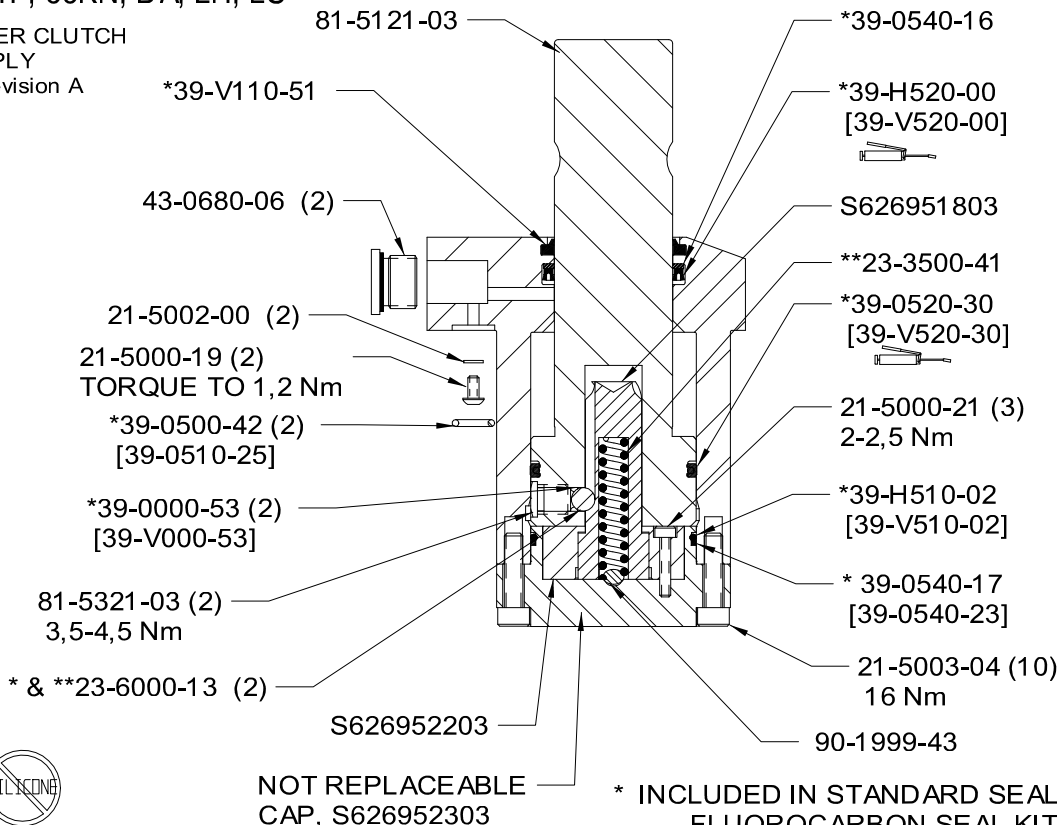

* INCLUDED IN STANDARD SEAL KIT No. 60-7110-11
 FLUOROCARBON SEAL KIT No. [6V-7110-11]
 ** INCLUDED IN SPRING KIT No. 61-7040-07

ASSY, SC, LP, TF, 33KN, DA, LH, LS

UNIT WITHOUT PLUNGER CLUTCH
 AS OF 11/09/04
 MODELS THAT APPLY
 41-5633-24 , Revision A & Later
 6951KN-33-220 , Revision B & Later

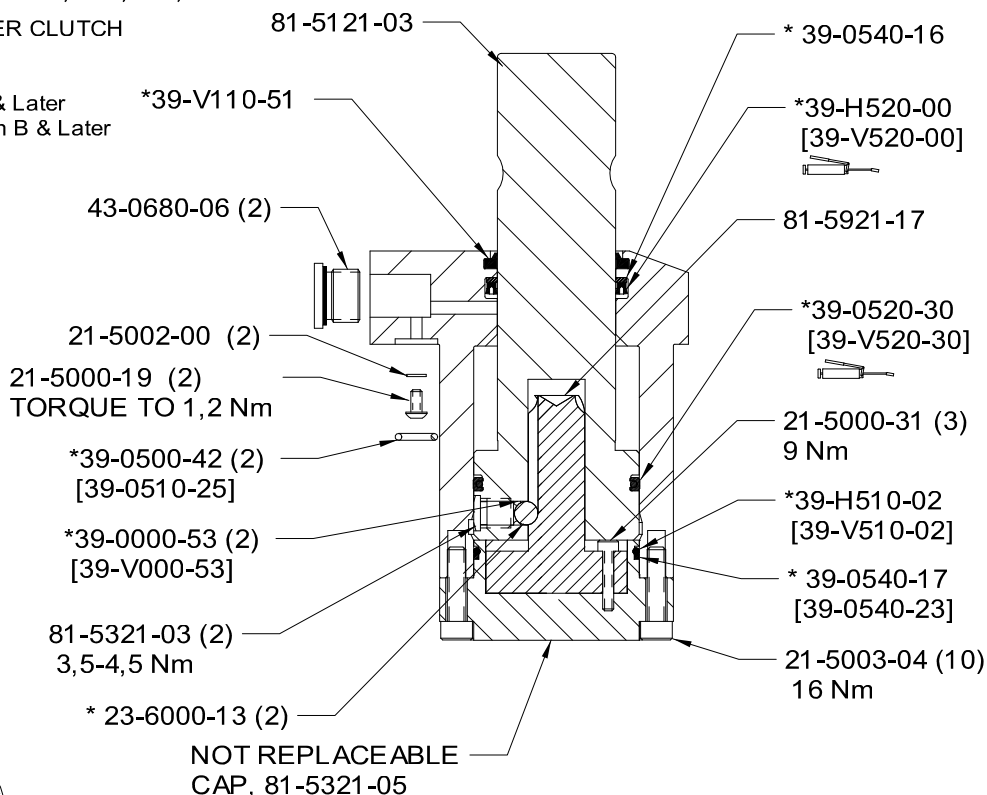

* INCLUDED IN STANDARD SEAL KIT No. 60-7110-11
 FLUOROCARBON SEAL KIT No. [6V-7110-11]