

APPLY LUBRICANT TO ALL SEALS PRIOR TO INSTALLATION. DO NOT USE SILICONE TYPE LUBRICANTS. FOR PROPER ARM MOUNTING SEE IS1505.

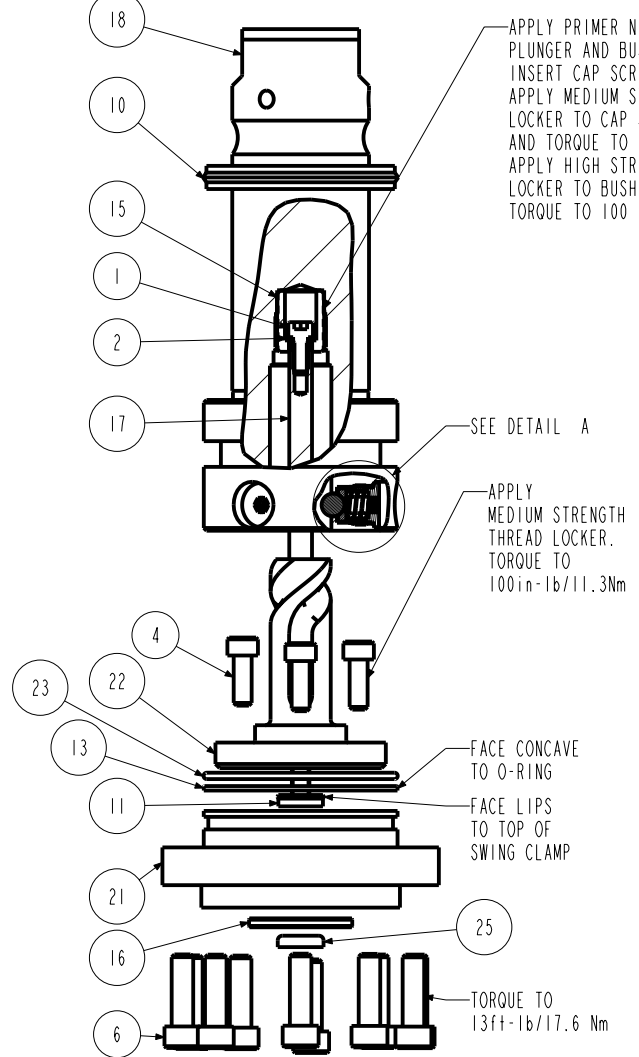

N/A	N/A	IS1505	INSTRUCTION SHEET, ARM INSTALLATION		
N/A	N/A	6V711054	SEAL KIT, FKM		
N/A	N/A	60711054	SEAL KIT, STANDARD		
26	1	39V11051	WIPER, PRESS-IN, (1-1/2)	X	X
25	1	39V10029	WIPER, PRESS-IN, (1/4)	X	X
24	1	39H52000	SEAL, U-CUP, 1-1/2 x 1/8 x 1-3/4	X	39V52000
23	1	39H51002	O-RING, (-033)	X	39V51002
22	1	81592131	CAM, SC, LP, 7500/33KN, RH, TC, PR		
21	1	81532115	CAP, END, SC, LP, 33kN/7500, PR		
20	3	81532108	SEAT, BALL, SC, LP, TC		
19	3	81532107	RETAINER, SC, LP, TC		
18	1	81512121	PLUNGER, SC, LP, 7500/33KN, DA, TC, PR		
17	1	81500051	ROD, ACTUATOR, SC, LP, TF, 7500/33KN		
16	1	81500040	RING, LOCATOR, SC, LP, PR		
15	1	81500039	BUSHING, PLUNGER, PR, SC, LP		
14	2	43068006	PLUG, 1/4 BSPP MALE		
13	1	39054017	BU RING, (-033)	X	39054023
12	1	39054016	BU RING, (1.5x.125x.063)	X	X
11	1	39052043	SEAL, LL, (1/4 x 1/8 x 1/8 x 1/2)	X	39V52043
10	1	39052030	SEAL, CROWN, 1-3/4x2-1/8x1/4	X	39V52030
9	2	39050042	O-RING, (-011)	X	39051025
8	3	23650004	BALL, TUNGSTEN-CARBIDE .250		
7	3	23350066	SPRING, COMPRESSION		
6	10	21500304	SHCS, M6 X 1.0-6G X 20MM		
5	2	21500200	WASHER		
4	3	21500031	SHCS, M5 X 0.8 X 14, ALY		
3	2	21500019	SCREW, CAP, BTNH, M3 X 6, ALY		
2	1	21430022	WASHER		
1	1	21410049	SCREW, CAP, SOCH, 8-32 X 3/8, ALY		
No.	QTY	PART No.	DESCRIPTION	Std. Seal Kit	FKM Seal Kit

PARTS LIST

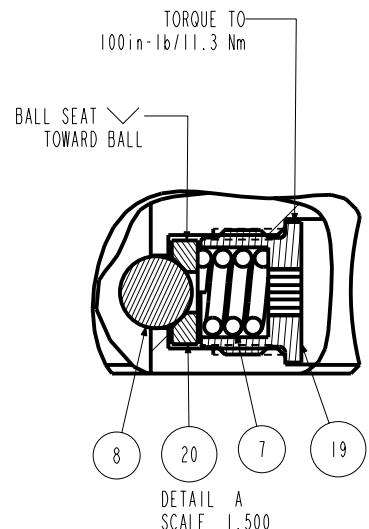

VEKTEK, INC.
1334 E. SIXTH AVE. P.O. BOX 625
EMPORIA, KS. 66801 U.S.A.

ASSEMBLIES AFFECTED
41463321PR

PARTS LIST, ASSY, SC, LP, TC, TF, 33KN, DA, DA, PR

SIZE
A **MPL7206**

REV
A

A	2679	RELEASE	JDW	10/16/13
REV	IN ACCORDANCE WITH ECN	EFFECTIVE DATE	REVISED BY	DATE
DRW BY:	JDW	DRAWING STATUS: Released		
DATE:	10/16/13	PRODUCTION APPROVED FOR RELEASED STATUS ONLY		

