

MODEL NO.			MODEL NAME
42111000			ASSY,CYL, BB, MM, 10,1KN, 6,5 STRK,SA
NO.	QTY	PART NO.	DESCRIPTION
1	1	23313007	SPRING, COMPRESSION
2	1	39010013	SEAL, BEVEL, 9/16 X 3/32 X 3/4
3	1	39012011	WIPER, SNAP-IN, (1/2)
4	2	39050042	O-RING, (-011)
5	1	48010802	PISTON, CYL, BB, 10.1KN, 6.5 STRK
6	1	82030802	GLAND, CYL, BB, DA, 2200
N/A	N/A	60210300	KIT, SEAL, BB, 10,1 KN, SA
N/A	N/A	6V210100	KIT, SEAL, BB, 2200/10,1 KN, SA, FKM
N/A	N/A	46100025	KIT, SPRING, BB, 10,1 KN

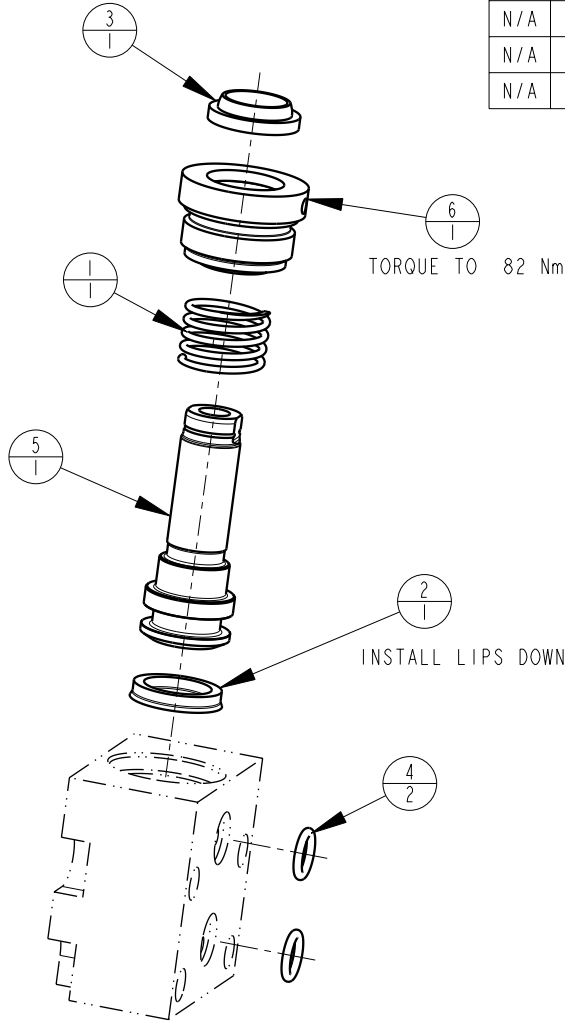

3. SPRING PAK AND RETAINING RING ARE INCLUDED IN THE SPRING KIT.
2. ALL SEALS, O-RINGS, AND WIPERS ARE INCLUDED IN THE STANDARD OR FKM SEAL KIT.
1. APPLY LUBRICANT TO ALL SEALS PRIOR TO ASSEMBLY (DO NOT USE SILICONE TYPE LUBRICANTS).

NOTE:

PARTS LIST



VEKTEK, INC.
1334 E. SIXTH AVE. P.O. BOX 625
EMPORIA, KS. 66801 U.S.A.

ASSEMBLIES AFFECTED
42-1110-00

PARTS LIST, BB, MM, 10,1 KN, SA

SIZE A MPLV2169 REV B

B	2625	RELEASE	GAR	2/28/14
REV	IN ACCORDANCE WITH ECN	EFFECTIVE DATE	REVISED BY	DATE
DRW BY:	G. ROMINE	DRAWING STATUS: Released		
DATE:	11/19/07	PRODUCTION APPROVED FOR RELEASED STATUS ONLY		

FORM FEG035_PL_ASIZE, REV. B

SHEET 1 OF 1