

**THIS IS A TWO PAGE PARTS LIST.  
THIS FIRST PAGE APPLIES TO  
MODEL No. 20211303 AT REVISION L AND LATER REVISIONS**

Lubricate seals with clean hydraulic oil prior to assembly.  
**DO NOT USE SILICONE BASED LUBRICANTS**

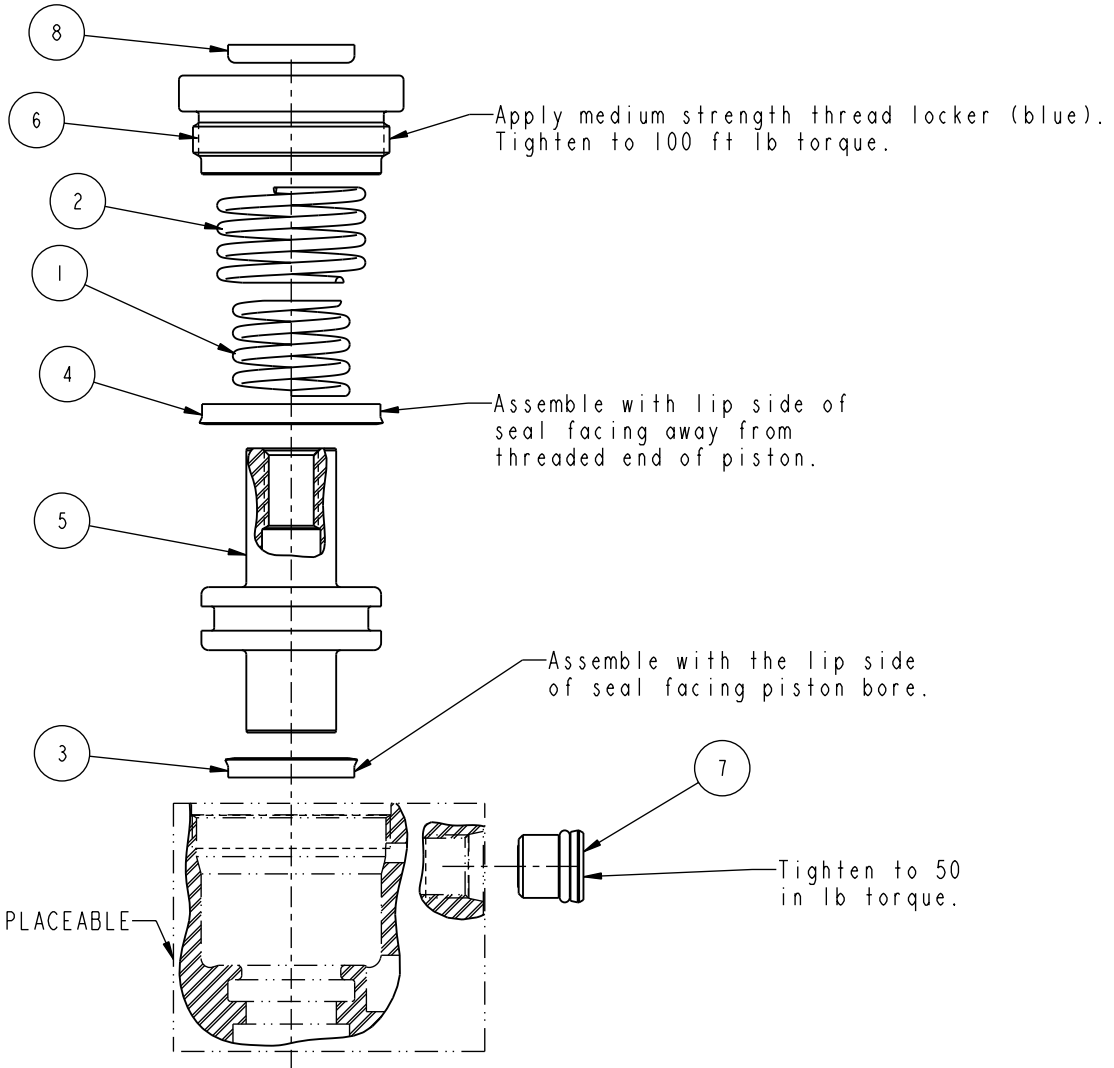

8	1	39V11020	WIPER,PRESS-IN,5/8", 85 FKM
7	1	92090001	ASSY, BREATHER, SAE #4
6	1	82031309	GLAND, CYL, HR, 4600&20.6KN, SA
5	1	82011301	PISTON, CYL, HR, 4600
4	1	39011027	SEAL,BEV,1-1/16x3/32x1-1/4,85 AU
3	1	39010020	SEAL,BEV,INSR,5/8x1/8x7/8,85 AU
2	1	23350075	Spring,1.03x.08x1.665x.333,30.37,SST
1	1	23350074	Spring,.812x.08x1.132x.333,68.4,SST
No.	QTY	PART No.	DESCRIPTION

Standard Seal Kit 60-2021-13	Fluorocarbon Seal Kit 6V-2021-13	Spring Kit 61-2021-14
39-0100-20	39-0520-02	23-3500-74
39-0110-27	39-0520-12	23-3500-75
39-V110-20	39-0520-12	

**PARTS LIST**



VEKTEK, INC.  
1334 E. SIXTH AVE. P.O. BOX 625  
EMPORIA, KS. 66801 U.S.A.

ASSEMBLIES AFFECTED  
20211303  
20211303F

SIZE  
A PL2029

REV  
H

H	2470	RELEASE	JDW	11/14/12
REV	IN ACCORDANCE WITH ECN	EFFECTIVE DATE	REVISED BY	DATE
DRW BY: VANDALSEM	DRAWING STATUS: <b>Released</b>			
DATE: 4-7-87	PRODUCTION APPROVED FOR RELEASED STATUS ONLY			

**THIS IS A TWO PAGE PARTS LIST.  
THIS SECOND PAGE APPLIES TO  
MODEL No. 20211303 AT REVISION K AND EARLIER REVISIONS**

Lubricate seals with clean hydraulic oil prior to assembly.  
DO NOT USE SILICONE BASED LUBRICANTS

Lubricate seals with clean hydraulic oil prior to assembly.  
DO NOT USE SILICONE BASED LUBRICANTS

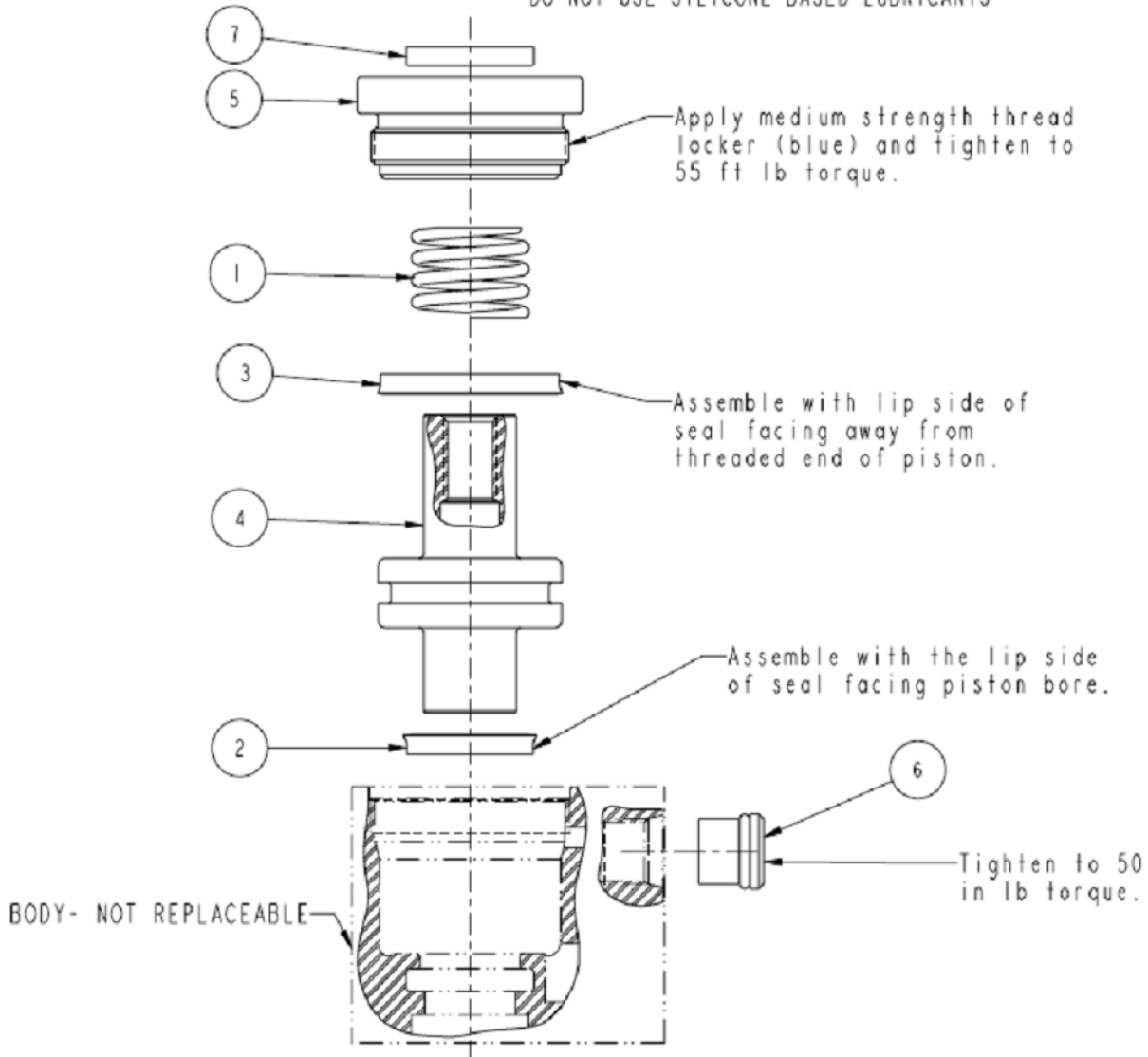

7	1	39V11020	WIPER, PRESS-IN
6	1	92090001	ASSY, BREATHER, SAE #4
5	1	82031301	GLAND, CYL, HR, 4600, SA
4	1	82011301	PISTON, CYL, HR, 4600
3	1	39011027	SEAL, BEVEL, 1-1/16 x 3/32 x 1-1/4
2	1	39010020	SEAL, BEVEL W/ HEEL INSERT, 5/8 x 1/8 x 7/8
1	1	23314005	SPRING
<b>No.</b>	<b>QTY</b>	<b>PART No.</b>	<b>DESCRIPTION</b>

Standard Seal Kit 60-2021-13	Fluorocarbon Seal Kit 6V-2021-13	Spring Kit 61-2021-13
39-0100-20	39-0520-02	23-3140-05
39-0110-27	39-0520-12	
39-V110-20	39-V110-20	

**PARTS LIST**



VEKTEK, INC.  
1334 E. SIXTH AVE. P.O. BOX 625  
EMPORIA, KS. 66801 U.S.A.

ASSEMBLIES AFFECTED  
20211303  
20211303F

SIZE  
A PL2029

REV  
H

H	2470	RELEASE	JDW	11/14/12
REV	IN ACCORDANCE WITH ECN	EFFECTIVE DATE	REVISED BY	DATE
DRW BY: VANDALSEM	DRAWING STATUS: <b>Released</b>			
DATE: 4-7-87	PRODUCTION APPROVED FOR RELEASED STATUS ONLY			