

LUBRICATE ALL SEALS WITH CLEAN HYDRAULIC OIL PRIOR TO ASSEMBLY. DO NOT USE SILICONE BASED LUBRICANTS.

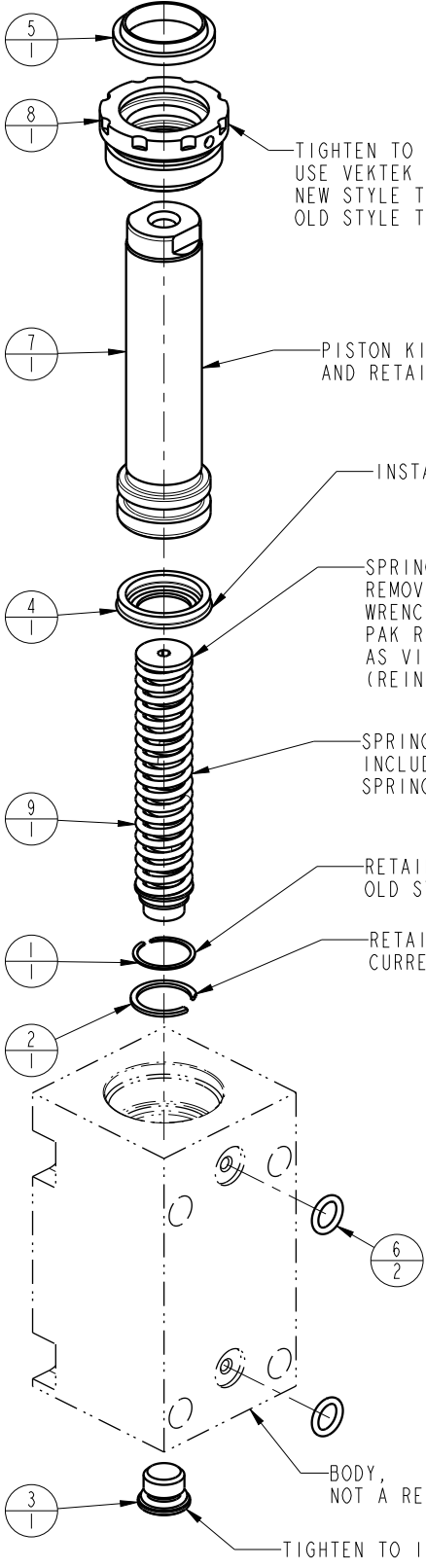

TIGHTEN TO 55 FT-LBS TORQUE
USE VEKTEK TORQUE TOOL
NEW STYLE TORQUE TOOL AT200103, 8 POINTED TOOL (CIRCA 2018)
OLD STYLE TORQUE TOOL AT200101, 2 POINTED SPANNER HOLE TOOL

PISTON KIT INCLUDES PISTON AND RETAINING RING 23050012

INSTALL WITH LIPS DOWN

SPRING PAK REMOVAL - INSERT 1/8" INTERNAL HEX WRENCH THRU SAE 4 PORT INTO SPRING PAK RETAINER AND ROTATE CLOCKWISE AS VIEWED FROM BOTTOM. (REINSTALL - REVERSE ABOVE PROCEDURE)

SPRING KIT 61200110 INCLUDES SPRING PAC 92060005 AND BOTH RETAINING RINGS 23002002 & 23050012

RETAINING RING, 23002002 (NARROW GROOVE) OLD STYLE

RETAINING RING, 23050012 (WIDE GROOVE) CURRENT STYLE, CIRCA 08/01/2003

BODY, NOT A REPLACEMENT PART
TIGHTEN TO 15 FT-LBS TORQUE

No.	QTY	PART No.	DESCRIPTION	Standard Seal Kit	FKM Seal Kit	Spring Kit
N/A	N/A	61200310	KIT, SPRING	N/A	N/A	NOTED
N/A	N/A	6V210111	KIT, SEAL, FKM	N/A	NOTED	N/A
N/A	N/A	60210111	KIT, SEAL, STANDARD	NOTED	N/A	N/A
9	1	92060005	SPRING PAK, CYL, 3900, 2.0 STRK			X
8	1	82031002	GLAND, CYL, 3900 & 17.8 KN			
7	1	62201008	Kit, Piston, Ring & Tag, 3900, 2.0 STRK			
6	2	39050042	O-RING, (-011)	X	39051025	
5	1	39011018	WIPER, SNAP-IN, (13/16)	X	39012008	
4	1	39010014	SEAL, BEVEL, 13/16 x 3/32 x 1	X	39012001	
3	1	30601145	PLUG, SOCH, SAE 4, LOW HEAD			
2	1	23050012	SNAP RING, INTERNAL			X
1	1	23002002	SNAP RING, INTERNAL			X

PARTS LIST

ASSEMBLIES AFFECTED
21111002
21111002F

VEKTEK, INC.
1334 E. SIXTH AVE. P.O. BOX 625
EMPORIA, KS. 66801 U.S.A.

SIZE A

FORM FEG035_PL_ASIZE, REV. B

PL2153

REV F

F	4249	RELEASE	JDW	08/08/20
REV	IN ACCORDANCE WITH ECN	EFFECTIVE DATE	REVISED BY	DATE
DRW BY:	JACOB	DRAWING STATUS: Released PRODUCTION APPROVED FOR RELEASED STATUS ONLY		
DATE:	05/05/97			

SHEET 1 OF 1