

1		2			
MODEL NO.		MODEL NAME			
56-0005-21 / 56-0005-22		ASSY, PD, 2H, DUAL, 3500/5000, PNEU			
NO.	QTY	PART NO.	DESCRIPTION	FILTER KIT	SEAL KIT
1	2	21410063	S.H.C.S. 1/4-20 UNC X .50 LG.	NO	NO
2	1	21440014	SHSS, HOLLOW	NO	NO
3	2	23002013	RETAINING RING, INTERNAL, 13 MM	YES	NO
4	7	30601166	PLUG, SOCH, SAE 6	NO	NO
5	2	30603322	PLUG, PIPE, HEX, HOL, 1/8 NPT, STEEL	NO	NO
6	3	30772766	COUPLING, QD, SAE 6, MALE	NO	NO
7	3	30871166	ASSY, ADAPTER, SAE 6, MALE	NO	NO
8	3	31050011	FILTER, DISC, SAE 6, 25 MICRON	YES	NO
9	6	31050013	DIFFUSER, DISK, SAE 6	YES	NO
10	3	39000021	O-RING, (-018)	NO	YES
11	1	39000030	O-RING, (-014)	NO	YES
12	1	39000031	O-RING, (-012)	NO	YES
13	1	39000036	O-RING, (-908)	NO	YES
14	8	39054010	BU RING, (-012)	YES, QTY 6	YES, QTY 2
15	1	56000703	ASSY, PD COVER, 2H, VEKTEK	NO	NO
16	1	70343792	VALVE, CHECK, SAE 4, 30 PSI	NO	NO
17	1	85600519	COVER, PD, 2H, DUAL, EXT ACC	NO	NO
18	1	85600539	PLUG, PD, PISTON, SAE 6	NO	NO
19	1	87033103	PISTON, AB, PILOT CHK.	NO	NO
20	1	10101602	ASSY, ACC, 3.6 CU IN, 1750 PSIG (3500 PSI)	NO	NO
20	1	10101601	ASSY, ACC, 3.2 CU IN, 1500 PSIG (5000 PSI)	NO	NO
20	1	10101603	ASSY, ACC, 3.8 CU IN, 25 PSIG (1450 PSI)	NO	NO
21	6	39000026	O-RING (INCLUDED WITH 30871166)	NO	YES
22	1	55250001	O-RING, CHECK VLV (INCLUDED WITH 70343792)	NO	YES
23	1	90199986	PD COVER, LEASH, #10 BALL CHAIN	NO	NO
N/A	N/A	60560002	KIT, SEAL, PD, 2H, DUAL, PNEU	N/A	NOTED
N/A	N/A	62560007	KIT, FILTER, PD, DUAL, 25 MICRON	NOTED	N/A
N/A	N/A	62560008	KIT, TOOL, SERVICE, PD, CHK VLV & FILTER	N/A	N/A

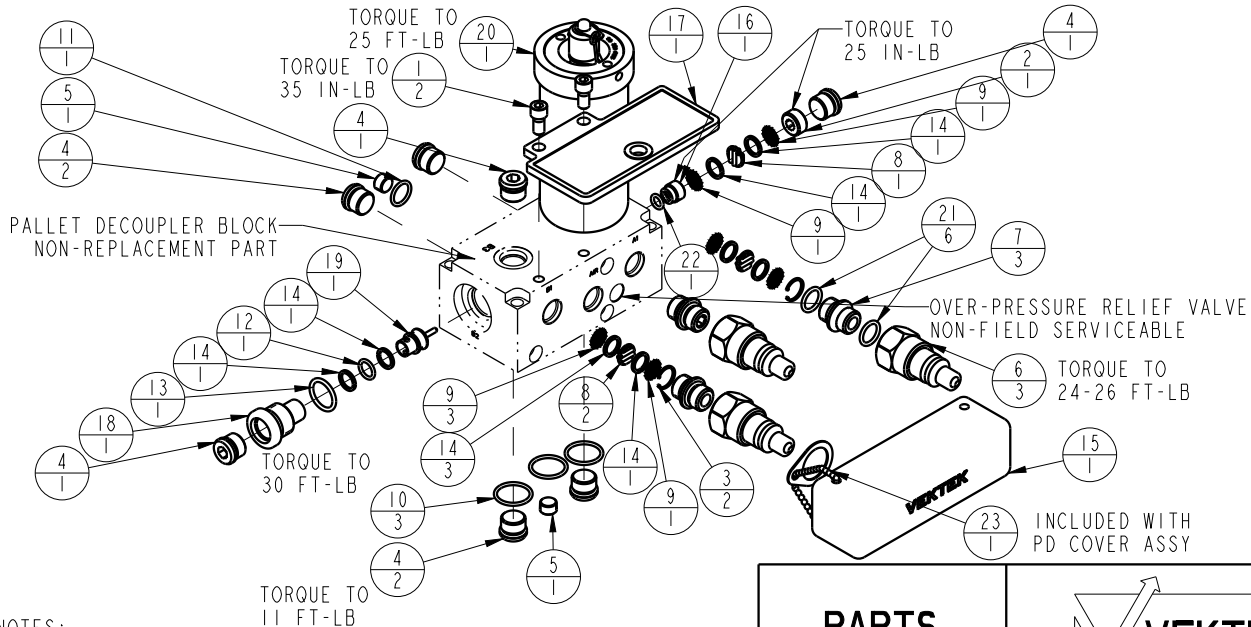

NOTES:

1. APPLY LUBRICANT TO ALL SEALS PRIOR TO INSTALLATION
2. DO NOT USE SILICONE TYPE LUBRICANTS.
3. PD SERVICE TOOL KIT INCLUDES CHK VLV WRENCH (65600000) AND LONG 1/4" HEX KEY (65600001).

PARTS LIST



VEKTEK, INC.  
1334 E. SIXTH AVE. P.O. BOX 625  
EMPORIA, KS. 66801 U.S.A.

J	4131	RELEASE	NPETERS	3/20/20
REV	IN ACCORDANCE WITH ECN	EFFECTIVE DATE	REVISED BY	DATE
DRW BY:	K. ROEMER	DRAWING STATUS: <b>Released</b>		
DATE:	06/17/09	PRODUCTION APPROVED FOR RELEASED STATUS ONLY		

ASSEMBLIES AFFECTED
56-0005-30 (1450 PSI ACC)
56-0005-21 (3500 PSI ACC)
56-0005-22 (5000 PSI ACC)

PARTS LIST, PD, 2H, DUAL, 3500/5000, PNEU	SIZE	PL5626	REV	J
	A			