

NOTE:

1. Seal Kit P/N: 60-5615-00
2. Face Seal P/N: 39-0561-50
3. Seal Mounting Tool P/N: AT-5605-00
4. Thread-In Mounting Tool P/N: AT-5615-00
5. Instructions are on IS5634

**COUPLING ELEMENT
THREAD-IN BODY
SHOWN WITH
SLIP-IN INSTALLED**

Torque to
15 lb*ft

SLIP-IN

SLIP-IN

FACE SEAL P/N: 39-0561-50
INCLUDED IN SEAL KIT.
THIS SEAL CAN BE ORDERED SEPERATELY.

BACK UP RING
INCLUDED IN SEAL KIT.
THIS SEAL CANNOT BE ORDERED SEPERATELY.

O-RING
INCLUDED IN SEAL KIT.
THIS SEAL CANNOT BE ORDERED SEPERATELY.

O-RING
INCLUDED IN SEAL KIT.
THIS SEAL CANNOT BE ORDERED SEPERATELY.

GASKET
INCLUDED IN SEAL KIT.
THIS SEAL CANNOT BE ORDERED SEPERATELY.

O-RING
INCLUDED IN SEAL KIT.
THIS SEAL CANNOT BE ORDERED SEPERATELY.

ALL THE SEALS ARE INSTALLED
ON THE SLIP-IN PART
OF THE COUPLING ELEMENT.
THREAD-IN BODY
NOT SHOWN IN THIS VIEW.

**PARTS
LIST**



VEKTEK, INC.
1334 E. SIXTH AVE. P.O. BOX 625
EMPORIA, KS. 66801 U.S.A.

ASSEMBLIES AFFECTED

56-1015-00

56-2015-00

PARTS LIST, COUPLING ELEMENTS, PRESS, ND5

SIZE
A PL5634

REV
C

C	3840	RELEASE	JDW	05/28/19
REV	IN ACCORDANCE WITH ECN	EFFECTIVE DATE	REVISED BY	DATE
DRW BY:	Twa	DRAWING STATUS: Released		
DATE:	8/18/16	PRODUCTION APPROVED FOR RELEASED STATUS ONLY		

REPLACING THE FACE SEAL:

1. The Coupling Mechanisms (2) are designed so that the face seal (1) can be replaced without having to removed the Mechanism (2) from its cavity.
2. Using a scribe or a sharp pick, pull the old face seal (1) out from the pilot groove.
3. Insert the new face seal (1) into the tip of the Seal Mounting Tool (P/N: AT-5605-00).
4. Taking the Seal Mounting Tool (P/N: AT-5605-00) in your hand, press the face seal (1) until it's flush in the pilot groove, keeping the Seal Mounting Tool (P/N: AT-5605-00) axially aligned to the Mechanism (2).

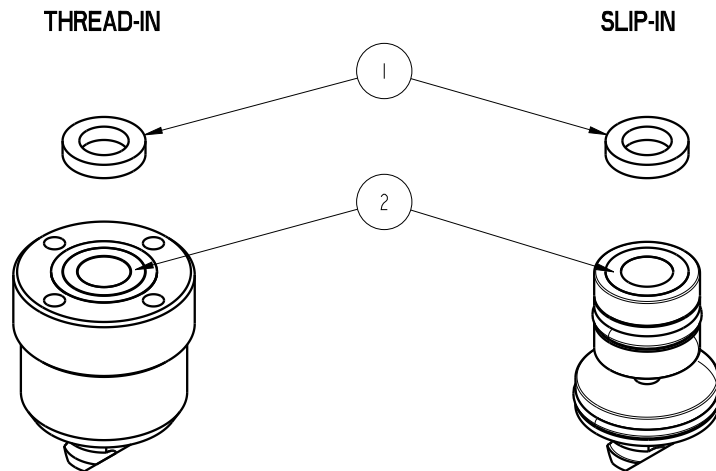

INSTALLATION INSTRUCTIONS



VEKTEK, INC.
1334 E. SIXTH AVE. P.O. BOX 625
EMPORIA, KS. 66801 U.S.A.

A	3077	RELEASE	TWA	8/19/16
REV	IN ACCORDANCE WITH ECN	EFFECTIVE DATE	REVISED BY	DATE
DRW BY:	TWA	DRAWING STATUS: Design		
DATE:	8/19/16	PRODUCTION APPROVED FOR RELEASED STATUS ONLY		

ASSEMBLIES AFFECTED
56-1015-00 56-2015-00 56-1025-00 56-2025-00

INSTRUCTION SHEET, COUPLING ELEMENTS, NDS	
SIZE A	IS5634
REV A	

FORM FEG041-IS-ASIZE, REV. B