



VEKTEK, INC.
1334 E. SIXTH AVE.
P.O. BOX 625
EMPORIA, KS. 66801
U.S.A

PARTS LIST

PL-7090

REV M
ECN 2503

ASSEMBLIES AFFECTED: 15-2818-02

DRAWN/DATE

ROMINE
09/29/00

ASSY, SC, LP, BF, 5000, DA, STR

UNIT WITH PLUNGER CLUTCH
MODELS THAT APPLY
15-2818-02 , Revision E & Earlier

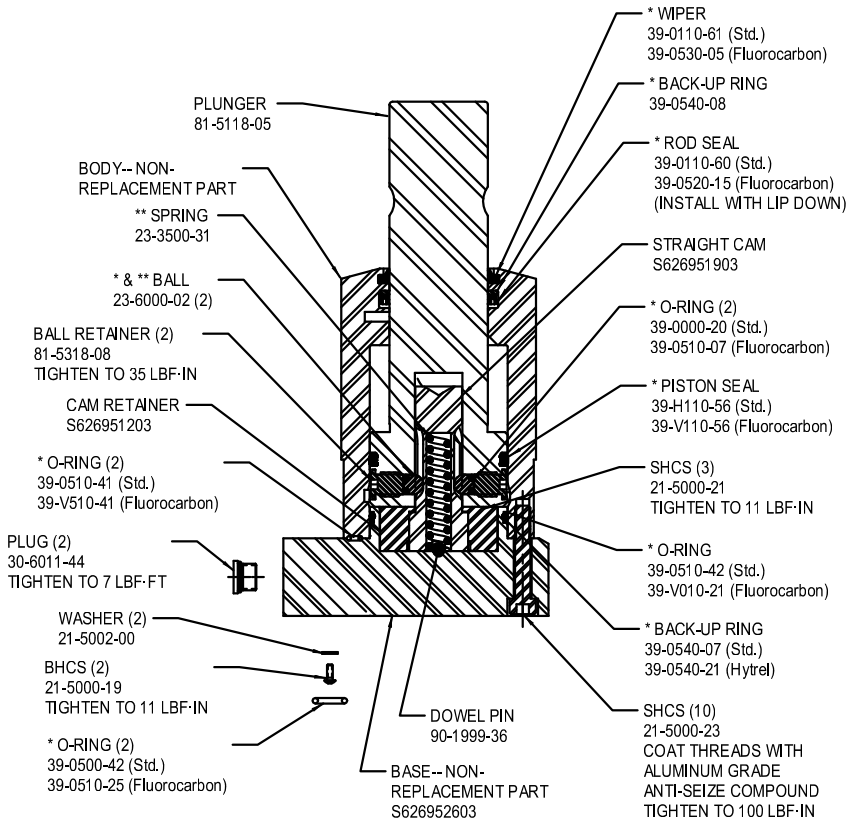

* INCLUDED IN SEAL KIT No. (Std) 60-7110-10
(Fluorocarbon) 6V-7110-10
** INCLUDED IN SPRING KIT No. 61-7040-02

ALSO AVAILABLE:
IS-1505 INSTRUCTION SHEET

APPLY LUBRICANT TO ALL SEALS PRIOR TO INSTALLATION
DO NOT USE SILICONE TYPE LUBRICANTS.

ASSY, SC, LP, BF, 5000, DA, STR

UNIT WITHOUT PLUNGER CLUTCH
AS OF 11/09/04
MODELS THAT APPLY
15-2818-02 , Revision F & Later

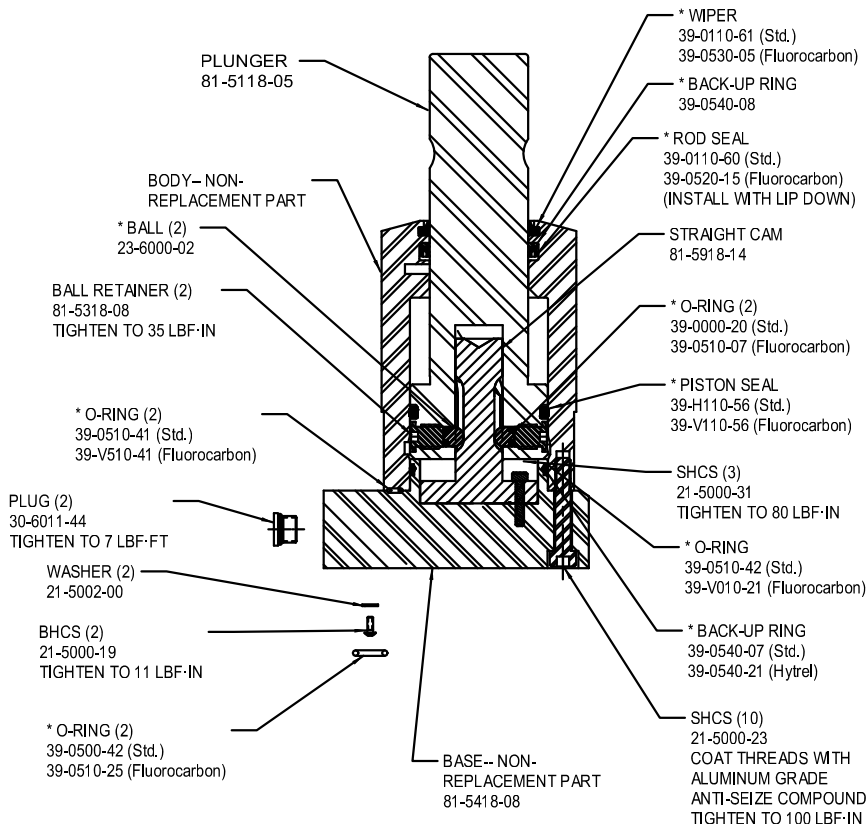

* INCLUDED IN SEAL KIT No. (Std) 60-7110-10
(Fluorocarbon) 6V-7110-10

ALSO AVAILABLE:
IS-1505 INSTRUCTION SHEET

APPLY LUBRICANT TO ALL SEALS PRIOR TO INSTALLATION
DO NOT USE SILICONE TYPE LUBRICANTS.

1 **2**

**READ ALL INSTRUCTIONS BEFORE INSTALLING ARMS
FAILURE TO FOLLOW INSTALLATION INSTRUCTIONS
WILL VOID PRODUCT WARRANTY !**

-Installing or Positioning of Low Profile Swing Clamp Arms-

**NOTE: If the arm is already installed on the plunger,
loosen the cap screw.**

**CAUTION: Never attempt to rotate the arm before loosening
the cap screw. This can damage the plunger rotating mechanism.**

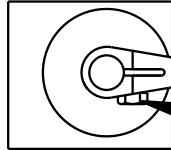

- 1. Rotate the arm to the desired radial position.**
- 2. Tighten to the torque specification listed below.**

MODEL	TORQUE ft-lb	TORQUE N-m
50001b & 22Kn	115 ft-lb	156 N-m
75001b & 33Kn	225 ft-lb	305 N-m

**IT IS RECOMMEND THE CROSS BOLT
BE REPLACED IF THE ARM NEEDS
REMOVED AFTER IT HAS BEEN IN SERVICE.**

CROSS BOLT	CROSS BOLT	CROSS BOLT	CROSS BOLT
5000 & 22KN	5000 & 22KN	7500 & 33KN	7500 & 33KN
SHORT LONG DOUBLE	UPREACH	SHORT LONG DOUBLE	UPREACH
21-5000-24	21-5000-25	21-5000-28	21-5000-25

**Instruction
Sheet**



VEKTEK, INC.
1334 E. SIXTH AVE. P.O. BOX 625
EMPORIA, KS. 66801 U.S.A.

Arm Installation Instruction Sheet

Low Profile Swing Clamps

SIZE A IS1505 REV C

C	2799	RELEASE	JDW	01/29/15
REV	IN ACCORDANCE WITH ECN	EFFECTIVE DATE	REVISED BY	DATE
DRW BY: MES	DRAWING STATUS: Released			
DATE: 08/01/05	PRODUCTION APPROVED FOR RELEASED STATUS ONLY			

FORM FEG041-IS-ASIZE, REV. B