

APPLY LUBRICANT TO ALL SEALS  
PRIOR TO INSTALLATION.  
DO NOT USE SILICONE TYPE LUBRICANTS.  
FOR PROPER ARM MOUNTING SEE IS1505.

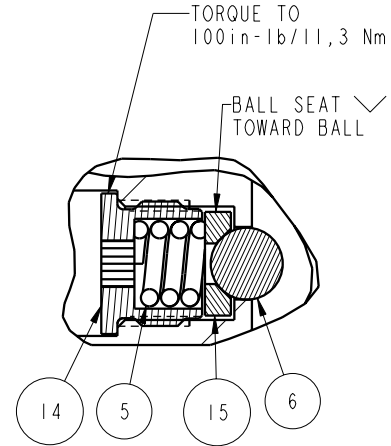

DETAIL A  
SCALE 1:500

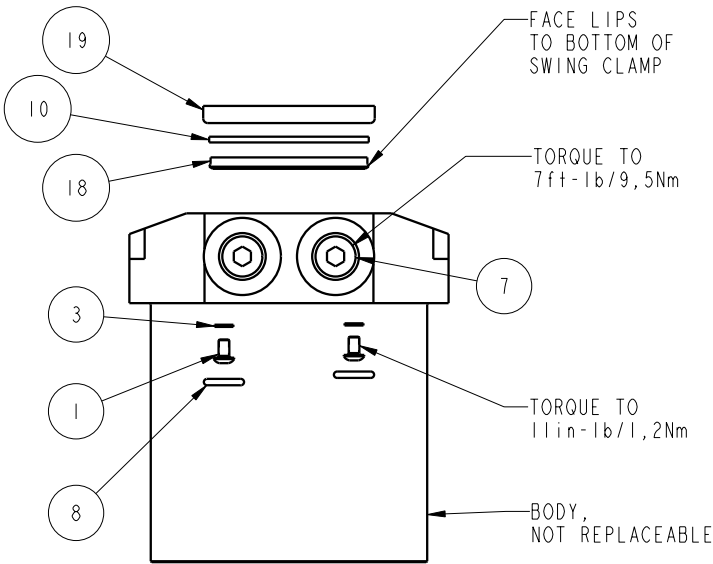
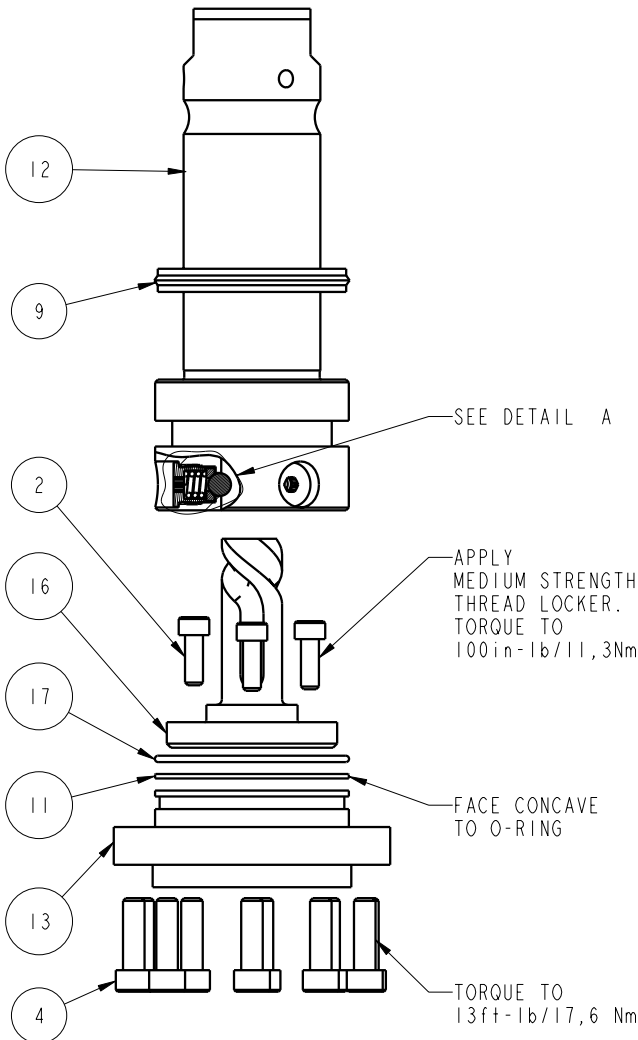

| No. | QTY | PART No. | DESCRIPTION                          | Std. Seal Kit | FKM Seal Kit |
|-----|-----|----------|--------------------------------------|---------------|--------------|
| N/A | N/A | IS1505   | INSTRUCTION SHEET, ARM INSTALLATION  |               |              |
| N/A | N/A | 6V711036 | SEAL KIT, FKM                        |               |              |
| N/A | N/A | 60711036 | SEAL KIT, STANDARD                   |               |              |
| 19  | 1   | 39V11051 | WIPER, PRESS-IN, 1-1/2", 85 FKM      | X             | X            |
| 18  | 1   | 39H52000 | SEAL, BEV, 1-1/2x1/8x1-3/4, 85 HNBR  | X             | 39V52000     |
| 17  | 1   | 39H51002 | O-RING, (-033), 1.989x.070, 90 HNBR  | X             | 39V51002     |
| 16  | 1   | 81592122 | CAM, SC, LP, 7500/33KN, LH, TC       |               |              |
| 15  | 3   | 81532108 | SEAT, BALL, SC, LP, TC               |               |              |
| 14  | 3   | 81532107 | RETAINER, SC, LP, TC                 |               |              |
| 13  | 1   | 81532105 | CAP, END, SC, LP, 33KN/7500          |               |              |
| 12  | 1   | 81512111 | PLUNGER, SC, LP, 7500/33KN, DA, TC   |               |              |
| 11  | 1   | 39054017 | BU RING, (-033), 90 NBR              | X             | 39054023     |
| 10  | 1   | 39054016 | BU RING, 1.5x.125x.063, HYTREL       | X             | X            |
| 9   | 1   | 39052030 | SEAL, CROWN, 1-3/4x2-1/8x1/4, 90AU   | X             | 39V52030     |
| 8   | 2   | 39050042 | O-RING, (-011), .301x.070, 90 AUD    | X             | 39051025     |
| 7   | 2   | 30601144 | PLUG, SOCH, SAE 4                    |               |              |
| 6   | 3   | 23650004 | BALL, TUNGSTEN-CARBIDE, 250          |               |              |
| 5   | 3   | 23350066 | SPRING, COMP., .296x.06x.31x.21, 903 |               |              |
| 4   | 10  | 21500304 | SHCS, M6 X 1.0-6G X 20MM             |               |              |
| 3   | 2   | 21500200 | WASHER, .124x.207x.024, COPPER       |               |              |
| 2   | 3   | 21500031 | SHCS, M5 X 0.8 X 14, ALY             |               |              |
| 1   | 2   | 21500019 | SCREW, CAP, BTNH, M3 X 6, ALY        |               |              |

**PARTS LIST**



ASSEMBLIES AFFECTED  
14062101  
14062101F

SIZE A  
**PL7155**

REV B

|         |                        |  |            |          |
|---------|------------------------|--|------------|----------|
| B       | 2596                   | RELEASE                                      | JDW        | 12/06/13 |
| REV     | IN ACCORDANCE WITH ECN | EFFECTIVE DATE                               | REVISED BY | DATE     |
| DRW BY: | JDW                    | <b>DRAWING STATUS: Released</b>              |            |          |
| DATE:   | 6-7-11                 | PRODUCTION APPROVED FOR RELEASED STATUS ONLY |            |          |

