

APPLY LUBRICANT TO ALL SEALS  
PRIOR TO INSTALLATION.  
DO NOT USE SILICONE TYPE LUBRICANTS.  
FOR PROPER ARM MOUNTING SEE IS1505.

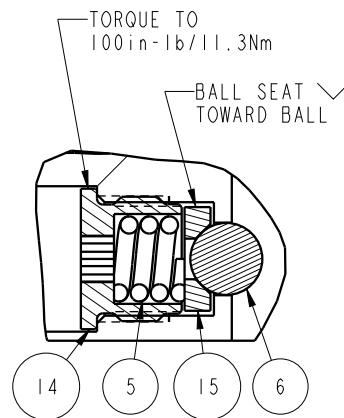

DETAIL A  
SCALE 1.500

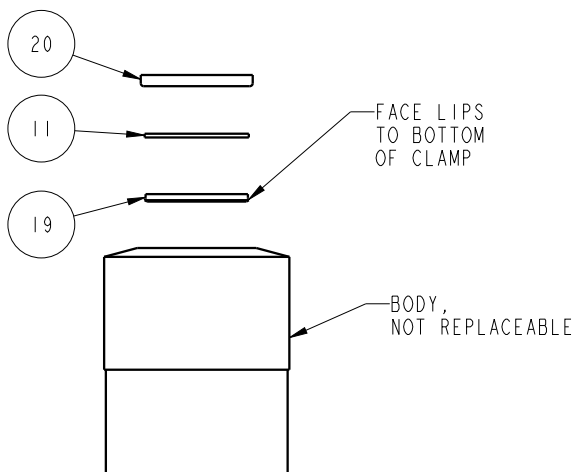
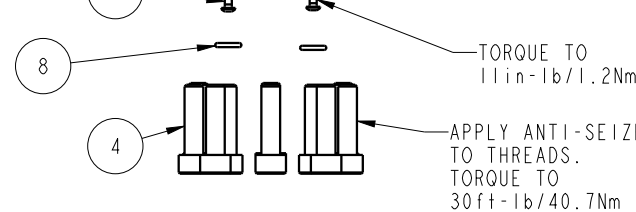
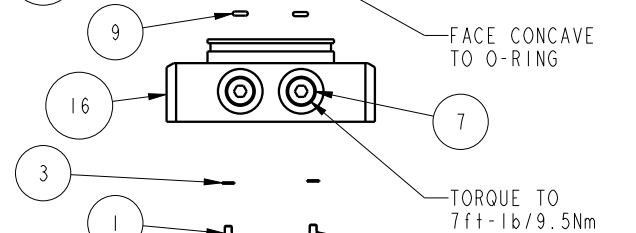
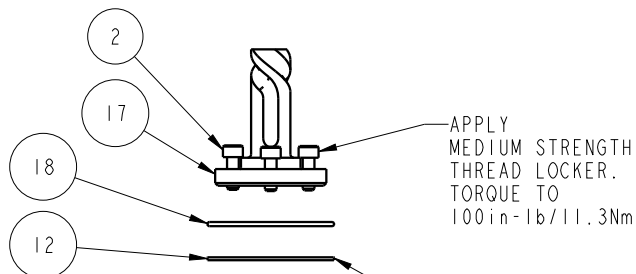
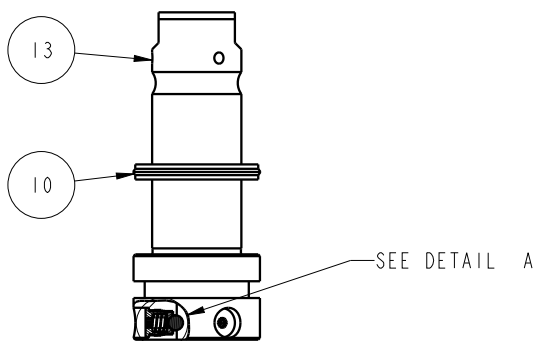

No.	QTY	PART No.	DESCRIPTION	Std. Seal Kit	FKM Seal Kit	Spring Kit
N/A	N/A	IS1505	INSTRUCTION SHEET, ARM INSTALLATION			
N/A	N/A	N/A	SPRING KIT			
N/A	N/A	6V711044	SEAL KIT, FKM			
N/A	N/A	60711044	SEAL KIT, STANDARD			
20	1	39V11051	WIPER, PRESS-IN, (1-1/2)	X	X	
19	1	39H52000	SEAL, U-CUP, 1-1/2 x 1/8 x 1-3/4	X	39V52000	
18	1	39H51002	O-RING, (-033)	X	39V51002	
17	1	81592122	CAM, SC, LP, 7500/33KN, LH, TC			
16	1	81542103	BASE, SC, BF, LP, 7500			
15	3	81532108	SEAT, BALL, SC, LP, TC			
14	3	81532107	RETAINER, SC, LP, TC			
13	1	81512121	PLUNGER, SC, LP, 7500&33KN, DA, TC, PR			
12	1	39054017	BU RING, (-033)	X	39054023	
11	1	39054016	BU RING, (1.5x.125x.063)	X	X	
10	1	39052030	SEAL, CROWN, 1-3/4x2-1/8x1/4	X	39V52030	
9	2	39051041	O-RING, (-006)	X	39V51041	
8	2	39050042	O-RING, (-011)	X	39051025	
7	2	30601144	PLUG, SOCH, SAE 4			
6	3	23650004	BALL, TUNGSTEN-CARBIDE .250			
5	3	23350066	SPRING, COMPRESSION			
4	10	21500305	SHCS, M8 X 1.25-6G X 30MM			
3	2	21500200	WASHER			
2	3	21500031	SHCS, M5 X 0.8 X 14, ALY			
1	2	21500019	SCREW, CAP, BTNH, M3 X 6, ALY			

<b>PARTS LIST</b>	
	VEKTEK, INC. 1334 E. SIXTH AVE. P.O. BOX 625 EMPORIA, KS. 66801 U.S.A.
ASSEMBLIES AFFECTED 14222101 14222101F	PARTS LIST, ASSY, SC, LP, TC, BF, 7500, DA, LH
SIZE A	PL7175
	REV C

C	2981	RELEASE	JDW	02/05/16
REV	IN ACCORDANCE WITH ECN	EFFECTIVE DATE	REVISED BY	DATE
DRW BY:	JDW	<b>DRAWING STATUS: Released</b>		
DATE:	6-17-11	PRODUCTION APPROVED FOR RELEASED STATUS ONLY		

