

APPLY LUBRICANT TO ALL SEALS PRIOR TO INSTALLATION. DO NOT USE SILICONE TYPE LUBRICANTS. FOR PROPER ARM MOUNTING SEE IS1505.

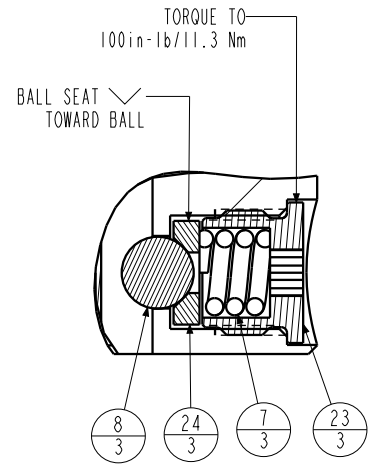

DETAIL A
SCALE 1.500

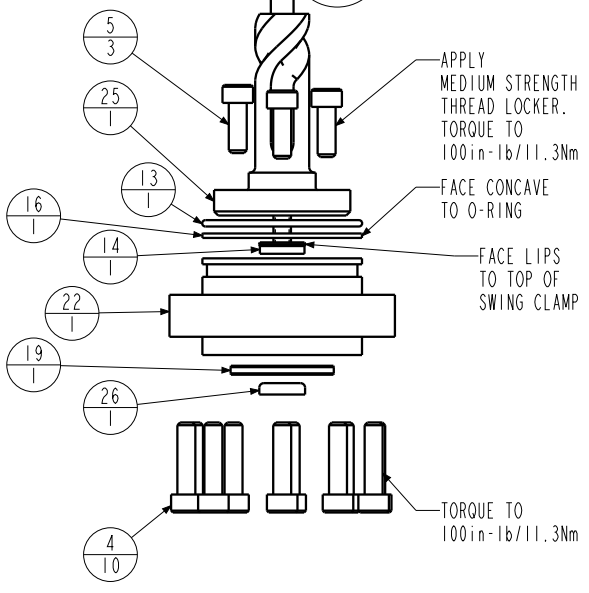
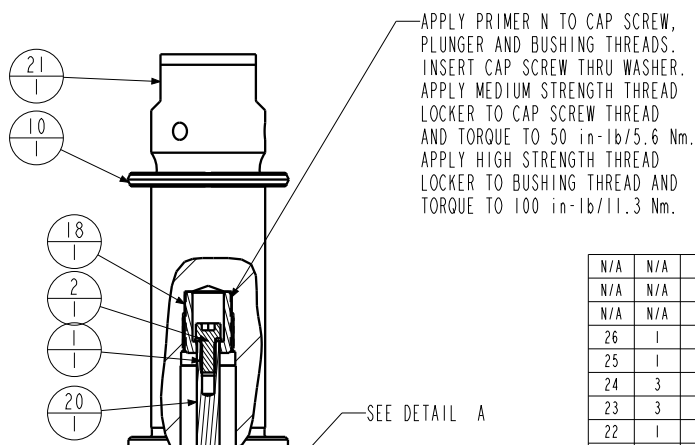

No.	QTY	PART No.	DESCRIPTION	Std. Seal Kit	FKM Seal Kit
N/A	N/A	IS1505	INSTRUCTION SHEET, ARM INSTALLATION		
N/A	N/A	6V711052	SEAL KIT, FKM		
N/A	N/A	60711052	SEAL KIT, STANDARD		
26	1	39V10029	WIPER, PRESS-IN, (1/4)	X	X
25	1	81591832	CAM, SC, LP, 5000/22KN, RH, TC, PR		
24	3	81532108	SEAT, BALL, SC, LP, TC		
23	3	81532107	RETAINER, SC, LP, TC		
22	1	81531819	CAP, END, SC, LP, 22KN/5000, PR		
21	1	81511821	PLUNGER, SC, LP, 5000&22KN, DA, TC, PR		
20	1	81500041	ROD, ACTUATOR, SC, LP, TF, 22KN		
19	1	81500040	RING, LOCATOR, SC, LP, PR		
18	1	81500039	BUSHING, PLUNGER, PR, SC, LP		
17	1	39054008	BU RING, (-218)	X	X
16	1	39054007	BU RING, (-030)	X	39054021
15	1	39053005	WIPER, SNAP-IN, (1-1/4)	X	X
14	1	39052043	SEAL, LL, (1/4 X 1/8 X 1/8 X 1/2)	X	39V52043
13	1	39051042	O-RING, (-030)	X	39V01021
12	2	39050042	O-RING, (-011)	X	39051025
11	1	39011060	SEAL, BEVEL W/HHEEL INSERT, 1-1/4 x 1/8 x 1-1/2	X	39052015
10	1	39011056	SEAL, CROWN, 1-9/16 x 1-3/4 x 5/32	X	39V11056
9	2	30601144	PLUG, SOCH, SAE 4		
8	3	23650004	BALL, TUNGSTEN-CARBIDE, 250		
7	3	23350066	SPRING, COMPRESSION		
6	2	21500200	WASHER		
5	3	21500031	SHCS, M5 x 0.8 x 14, ALY		
4	10	21500022	SHCS, M5 x .8-6G x 20, ALY		
3	2	21500019	SCREW, CAP, BTNH, M3 x 6, ALY		
2	1	21430022	WASHER		
1	1	21410049	SCREW, CAP, SOCH, 8-32 X 3/8, ALY		

PARTS LIST



VEKTEK, INC.
1334 E. SIXTH AVE. P.O. BOX 625
EMPORIA, KS. 66801 U.S.A.

ASSEMBLIES AFFECTED
14061800PR
14061800FPR

PARTS LIST, ASSY, SC, LP, TC, TF, 5000, DA, RH, PR
SIZE A
PL7230
REV A

A	3481	RELEASE	JDW	06/01/18
REV	IN ACCORDANCE WITH ECN	EFFECTIVE DATE	REVISED BY	DATE
DRW BY:	JDW	DRAWING STATUS: Released		
DATE:	06/01/18	PRODUCTION APPROVED FOR RELEASED STATUS ONLY		

