

APPLY LUBRICANT TO ALL SEALS PRIOR TO INSTALLATION. DO NOT USE SILICONE TYPE LUBRICANTS. FOR PROPER ARM MOUNTING SEE IS1505.

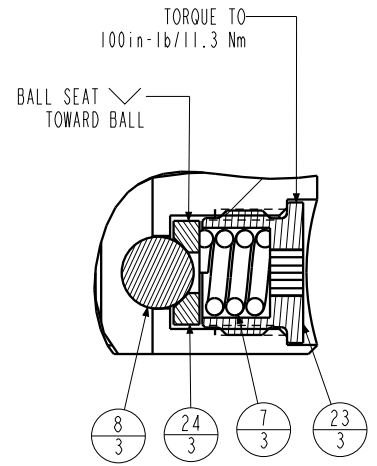

DETAIL A
SCALE 1.500

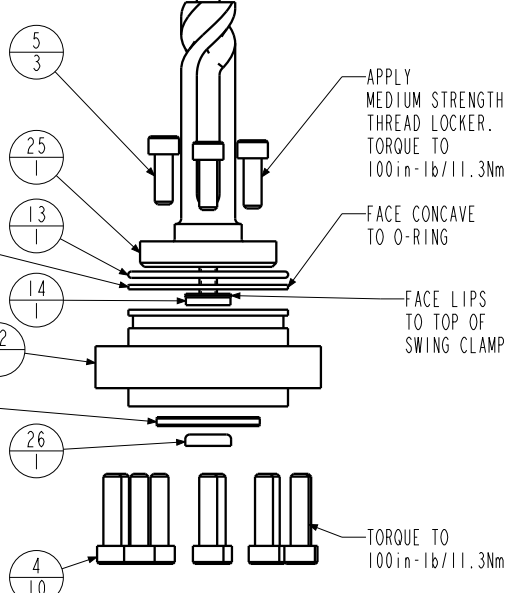
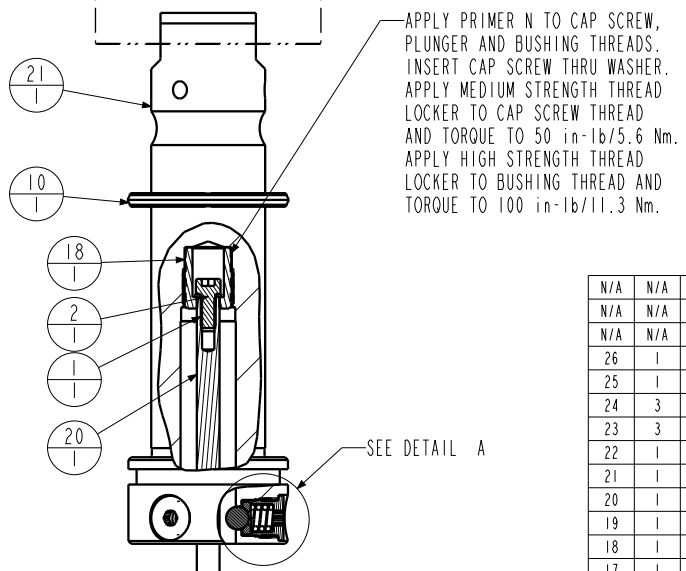

No.	QTY	PART No.	DESCRIPTION	Std. Seal Kit	FKM Seal Kit
N/A	N/A	IS1505	INSTRUCTION SHEET, ARM INSTALLATION		
N/A	N/A	6V711052	SEAL KIT, FKM		
N/A	N/A	60711052	SEAL KIT, STANDARD		
26	1	39V10029	WIPER, PRESS-IN, (1/4)	X	X
25	1	81591837	CAM, SC, LP, 22KN, RH, LS, TC, PR		
24	3	81532108	SEAT, BALL, SC, LP, TC		
23	3	81532107	RETAINER, SC, LP, TC		
22	1	81531819	CAP, END, SC, LP, 22KN/5000, PR		
21	1	81511822	PLUNGER, SC, LP, 22KN, DA, LS, TC, PR		
20	1	81500042	ROD, ACTUATOR, SC, LP, TF, 22KN, LS		
19	1	81500040	RING, LOCATOR, SC, LP, PR		
18	1	81500039	BUSHING, PLUNGER, PR, SC, LP		
17	1	39054008	BU RING, (-218)	X	X
16	1	39054007	BU RING, (-030)	X	39054021
15	1	39053005	WIPER, SNAP-IN, (1-1/4)	X	X
14	1	39052043	SEAL, LL, (1/4 X 1/8 X 1/8 X 1/2)	X	39V52043
13	1	39051042	O-RING, (-030)	X	39V01021
12	2	39050042	O-RING, (-011)	X	39051025
11	1	39011060	SEAL, BEVEL W/HEEL INSERT, 1-1/4 x 1/8 x 1-1/2	X	39052015
10	1	39011056	SEAL, CROWN, 1-9/16 x 1-3/4 x 5/32	X	39V11056
9	2	30601144	PLUG, SOCH, SAE 4		
8	3	23650004	BALL, TUNGSTEN-CARBIDE, 250		
7	3	23350066	SPRING, COMPRESSION		
6	2	21500200	WASHER		
5	3	21500031	SHCS, M5 x 0.8 x 14, ALY		
4	10	21500022	SHCS, M5 x .8-6G x 20, ALY		
3	2	21500019	SCREW, CAP, BTNH, M3 X 6, ALY		
2	1	21430022	WASHER		
1	1	21410049	SCREW, CAP, SOCH, 8-32 X 3/8, ALY		

PARTS LIST



A	3481	RELEASE	JDW	06/01/18
REV	IN ACCORDANCE WITH ECN	EFFECTIVE DATE	REVISED BY	DATE
DRW BY:	JDW	DRAWING STATUS: Released		
DATE:	06/01/18	PRODUCTION APPROVED FOR RELEASED STATUS ONLY		

ASSEMBLIES AFFECTED
14061803PR
14061803FPR

PARTS LIST, ASSY, SC, LP, TC, TF, 5000, DA, RH, LS, PR	
SIZE A	PL7236
REV A	

