

Valves

Pneumatic Confirmation Valve

Confirm Clamp Stroke Position Pneumatically

The pneumatic confirmation valve confirms the stage of loading before or after clamping. It is adaptable to multiple devices including: swing clamps, link clamps, cylinders and supports.

Avoid machine crashes by confirming specific actions before you cycle your machine. It is designed to be used in both coolant and dry environments, and is easily mounted either vertically or horizontally. Confirmation at its finest!

- Easily fine tune to your fixture giving you a choice of set and differential pressure.
- Confirm signal is based on restricting air flow when tested function is present.
- Over-travel sensing will reopen if a device depresses plunger too far on over travel models.
- Pneumatic Confirmation Valve can be used with almost any clamping device.
- Can help you detect missing or misloaded parts.
- Remote venting recommended in coolant applications.

NOTE: Mounting hardware not included.

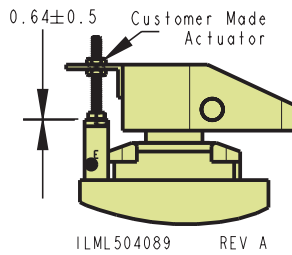
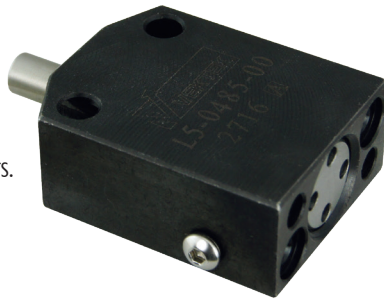

Application Setup:
Adjust actuator 0.064 ± 0.5 above valve body with clamp positioned at the bottom of clamping stroke. THIS WILL AVOID VALVE AND ACTUATOR DAMAGE IF CLAMP OVER TRAVELS.

Pneumatic Confirmation Valve Block Style

Model No.	L5-0485-00	L5-0485-01
Description	Over-Travel Sensing	Standard
Max Air Pressure (bar)	10	10
Operating Pressure Range (bar)	0.70 - 4.80	0.70 - 4.80
Air Flow Rate (SCFM)	10 - 20	10 - 20
Differential Pressure*	@1.4 bar Air Pressure	Min. 0.8
	@4.8 bar Air Pressure	Min. 0.8
Plunger Stroke (mm)	10 Max	10 Max
Spring (N)	6.6 - 13.3	6.6 - 13.3
Feed Port Nominal Diameter (mm)	2	2
Port Types	Manifold and M3	Manifold and M3

* Pressure drop when one or more valves open. All valves must be closed for pressure confirmation. Plumb multiple valves in parallel.

H-9

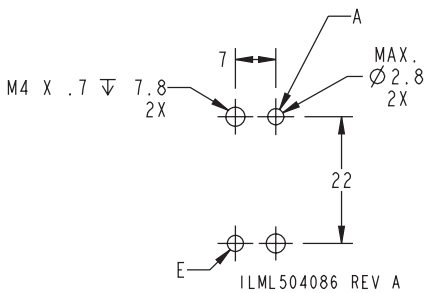

For proper sealing, the mating surface must be flat within 0.08 mm with a maximum surface roughness of $1.6 \mu\text{m } R_a$.

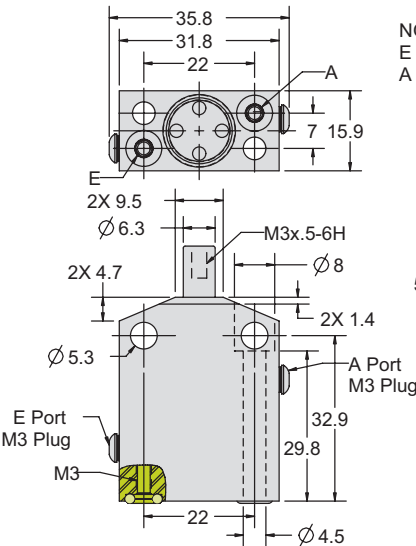

NOTE: MOUNTING HARDWARE NOT INCLUDED
E = INPUT
A = OUTPUT (VENT TO ATMOSPHERE)

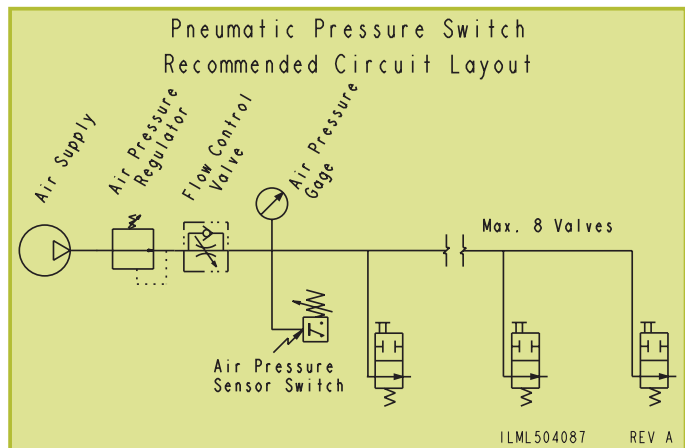
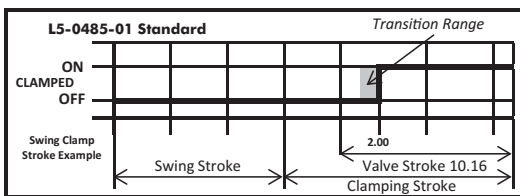
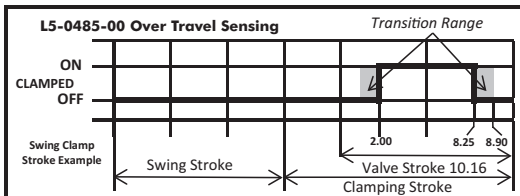
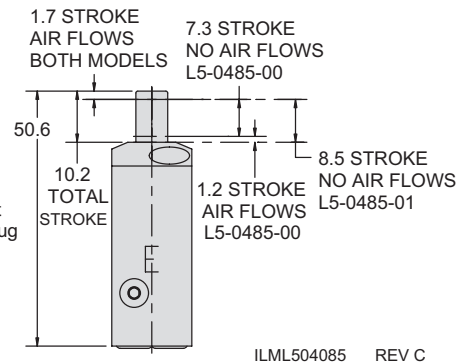

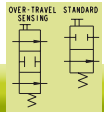

Pneumatic Confirmation Valve

Pneumatic Confirmation Valve Cartridge Style



Model No.	L5-0495-00	L5-0495-01
Description	Over-Travel Sensing	Standard
Max Air Pressure (bar)	10	10
Operating Pressure Range (bar)	0.70 - 4.80	0.70 - 4.80
Air Flow Rate (SCFM)	10 - 20	10 - 20
Differential Pressure* @4.8 bar Air Pressure	@1.4 bar Air	Min. 0.8
	Min. 0.8	Min. 0.8
Plunger Stroke (mm)	10 Max	10 Max
Spring (N)	6.6 - 13.3	6.6 - 13.3
Feed Port Nominal Diameter (mm)	2	2
Port Types	Manifold and M3	Manifold and M3

H-10

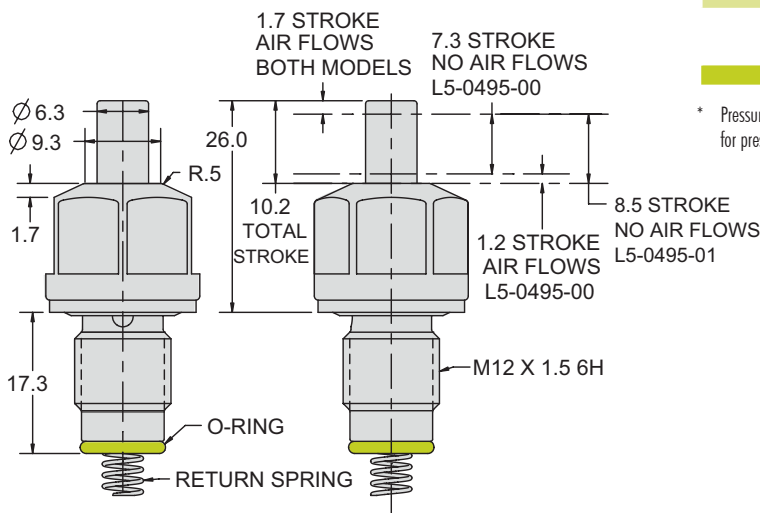

* Pressure drop when one or more valves open. All valves must be closed for pressure confirmation. Plumb multiple valves in parallel.

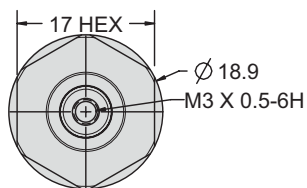

ILML504096 REV B

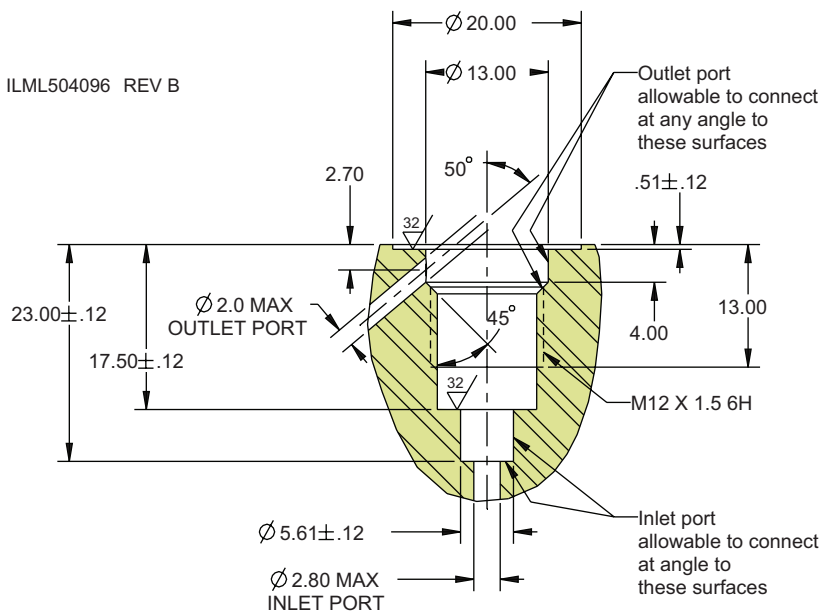

ILML504097 REV B