

# Hardware

## Dura Pin



# NEW

## Stronger Spring Forces

### Dura Pin

- Holds parts against fixture locator pins prior to clamping.
- Prevents premature part unloading when unclamping.
- Eccentric pin design for easy spring retention adjustment.
- Positive ball locking design in fixture cavity.
- Light, medium and heavy springs available for each size.
- BHC™ (Black Hard Coat) body finish.
- Hardened threaded pivot and spring cup.
- Multiple hardened club head profiles, order separately.
- Adjust club height then rotate the body to fix position, spring retention force, and location.

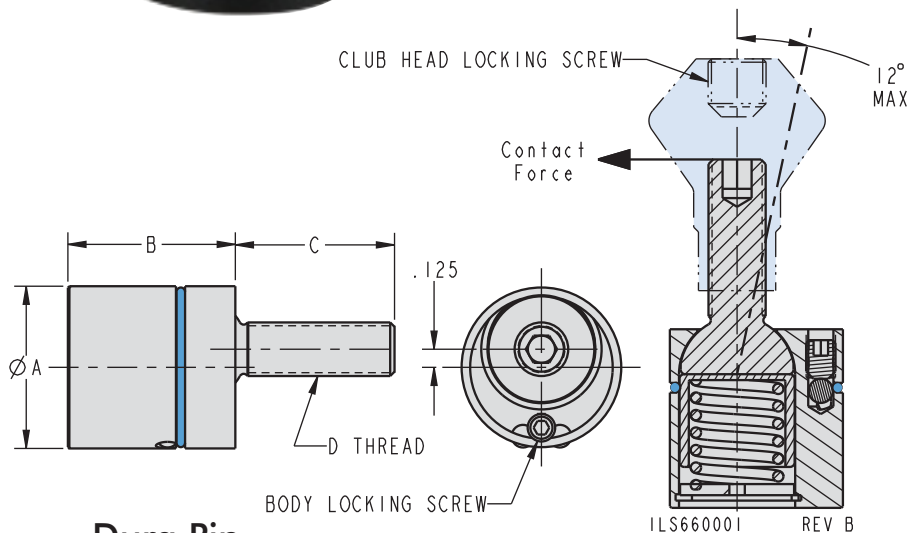

### Dura Pin

Model No.*	Spring Force (lb)**	Pin / Lever Ratio	A	B	C	D
66-0912-01	0.8 - 0.9					
66-0912-02	1.5 - 1.8					
66-0912-03	2.5 - 3.0	1 : 4.5	0.75	0.65	0.51	8-32
66-0912-04	4.2 - 4.8					
66-0912-05	5.2 - 6.0					
66-0915-01	1.4 - 1.8					
66-0915-02	2.3 - 3.0					
66-0915-03	2.9 - 3.8	1 : 4.2	0.93	0.98	0.77	1/4-28
66-0915-04	5.2 - 5.7					
66-0915-05	7.6 - 8.5					
66-0918-01	2.8 - 3.4					
66-0918-02	4.6 - 6.5					
66-0918-03	8.2 - 11.6	1 : 4.1	1.12	1.16	1.10	3/8-24
66-0918-04	15.7 - 20.0					
66-0918-05	23.5 - 29.5					

\* Club heads sold separately.

\*\* Spring contact force values are calculated at the end of the threaded pivot. Actual force values will vary at the part depending on the club head design and contact location.



## Dura Pin Club Heads

**NEW**  
Stronger Spring Forces

### Dura Pin Club Heads

- Three styles: standard, ball, and pin.
- Hardened alloy steel.
- Locking screw provided with all club heads.
- Club heads sold separate from the Dura Pin.

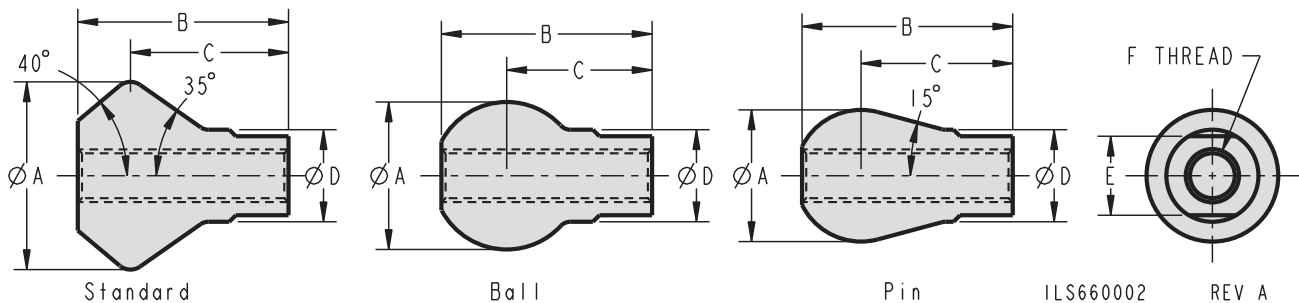

### Dura Pin Club Heads

Model No.	A	B	C	D	E	F
<b>Standard</b>						
66-1012-01	0.53	0.62	0.47	0.25	0.22	8-32
66-1015-01	0.89	1.00	0.75	0.44	0.37	1/4-28
66-1018-01	1.14	1.50	1.10	0.56	0.50	3/8-24
<b>Ball</b>						
66-1012-02	0.44	0.62	0.43	0.25	0.22	8-32
66-1015-02	0.70	1.00	0.69	0.44	0.37	1/4-28
66-1018-02	0.99	1.50	1.05	0.56	0.50	3/8-24
<b>Pin</b>						
66-1012-03	0.40	0.62	0.45	0.25	0.22	8-32
66-1015-03	0.62	1.00	0.72	0.44	0.37	1/4-28
66-1018-03	0.87	1.50	1.11	0.56	0.50	3/8-24

### Mounting

Model No.	Hole Size	Hole Depth
66-0912-01	0.755	0.656
66-0912-02		
66-0912-03		
66-0912-04		
66-0912-05		
66-0915-01	0.942	0.994
66-0915-02		
66-0915-03		
66-0915-04		
66-0915-05		
66-0918-01	1.130	1.166
66-0918-02		
66-0918-03		
66-0918-04		
66-0918-05		

