

Link Clamp Levers

High Pressure

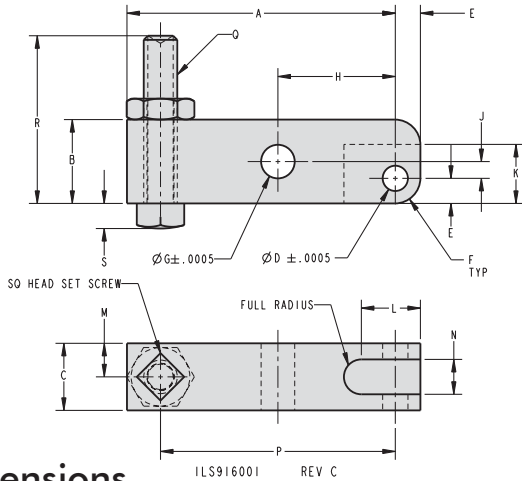

Dimensions

| Model No. | Cylinder Capacity S/A-D/A | A | B | C | D | E | F | G | H | J | K | L | M | N | P | Q | R | S |
|---|---------------------------|------|------|------|-------|-------|------|-------|------|------|------|------|------|------|------|-------------|------|------|
| Standard Length Lever, 1:1 Ratio | | | | | | | | | | | | | | | | | | |
| 91-6004-01 | 350/450 | 2.00 | 0.63 | 0.50 | 0.189 | 0.188 | 0.19 | 0.250 | 0.88 | 0.13 | 0.44 | 0.44 | 0.25 | 0.26 | 1.75 | 1/4-20 UNC | 1.25 | 0.19 |
| 91-6006-01 | 700/1100 | 2.50 | 0.88 | 0.63 | 0.252 | 0.250 | 0.25 | 0.375 | 1.13 | 0.13 | 0.56 | 0.56 | 0.31 | 0.32 | 2.25 | 5/16-18 UNC | 1.75 | 0.24 |
| 91-6009-01 | 1300/2600 | 3.13 | 1.25 | 1.00 | 0.377 | 0.375 | 0.38 | 0.500 | 1.38 | 0.19 | 0.81 | 0.81 | 0.50 | 0.51 | 2.75 | 3/8-16 UNC | 2.25 | 0.28 |
| 91-6014-01 | 3000/5000 | 4.00 | 1.75 | 1.25 | 0.502 | 0.500 | 0.50 | 0.625 | 1.75 | 0.25 | 1.19 | 1.19 | 0.63 | 0.63 | 3.50 | 1/2-13 UNC | 3.00 | 0.38 |
| 91-6016-01 | 5000/6800 | 4.88 | 2.00 | 1.50 | 0.627 | 0.625 | 0.63 | 0.750 | 2.13 | 0.25 | 1.50 | 1.50 | 0.75 | 0.76 | 4.25 | 5/8-11 UNC | 3.50 | 0.47 |
| Extended Length Lever without Tapped Hole, 2:1 Ratio | | | | | | | | | | | | | | | | | | |
| 91-6004-02 | 350/450 | 2.88 | 0.63 | 0.50 | 0.189 | 0.188 | 0.19 | 0.250 | 0.88 | 0.13 | 0.44 | 0.44 | 0.25 | 0.26 | N/A | N/A | N/A | N/A |
| 91-6006-02 | 700/1100 | 3.63 | 0.88 | 0.63 | 0.252 | 0.250 | 0.25 | 0.375 | 1.13 | 0.13 | 0.56 | 0.56 | 0.31 | 0.32 | N/A | N/A | N/A | N/A |
| 91-6009-02 | 1300/2600 | 4.50 | 1.25 | 1.00 | 0.377 | 0.375 | 0.38 | 0.500 | 1.38 | 0.19 | 0.81 | 0.81 | 0.50 | 0.51 | N/A | N/A | N/A | N/A |
| 91-6014-02 | 3000/5000 | 5.75 | 1.75 | 1.25 | 0.502 | 0.500 | 0.50 | 0.625 | 1.75 | 0.25 | 1.19 | 1.19 | 0.63 | 0.63 | N/A | N/A | N/A | N/A |
| 91-6016-02 | 5000/6800 | 7.00 | 2.00 | 1.50 | 0.627 | 0.625 | 0.63 | 0.750 | 2.13 | 0.25 | 1.50 | 1.50 | 0.75 | 0.76 | N/A | N/A | N/A | N/A |

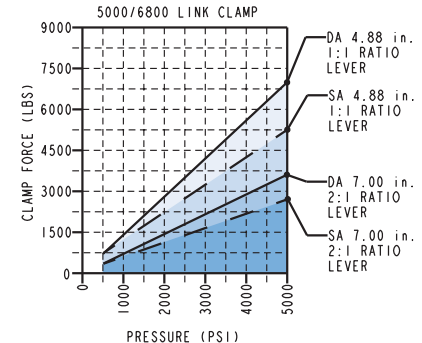
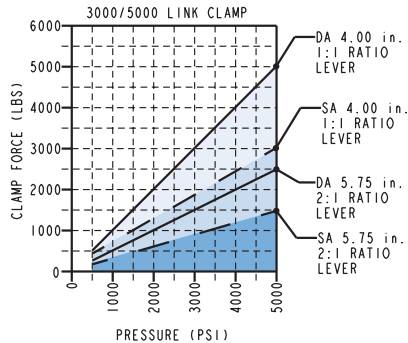
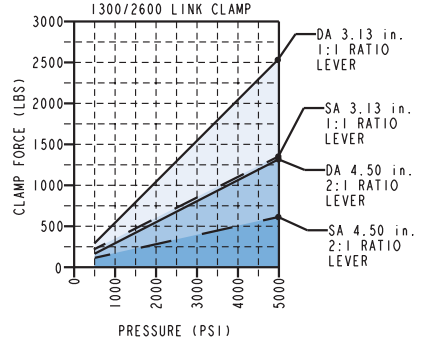
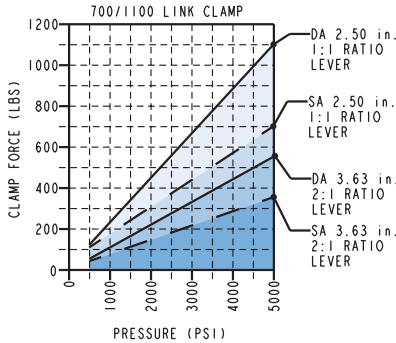
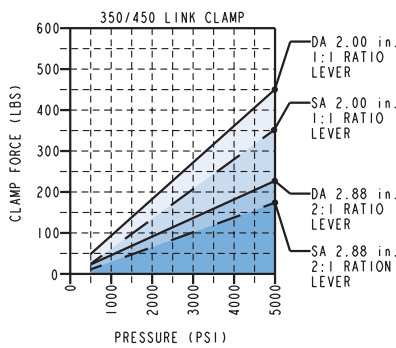

Link Clamp Lever Output Curves

NOTE: Modifications to levers that result in clamp ratios below a 1:1 ratio are not in the safe operating zone for the corresponding link clamp and could result in premature failure.

Exceeding the allowable offset values and operating pressures specified in the tables will result in excessive forces on the link clamp pins, links, and rod which could result in premature failure.

DOUBLE ACTING (DA) ————
SINGLE ACTING (SA) - - - - -

ILS916002 REV B



Link Clamp Levers

Low Pressure

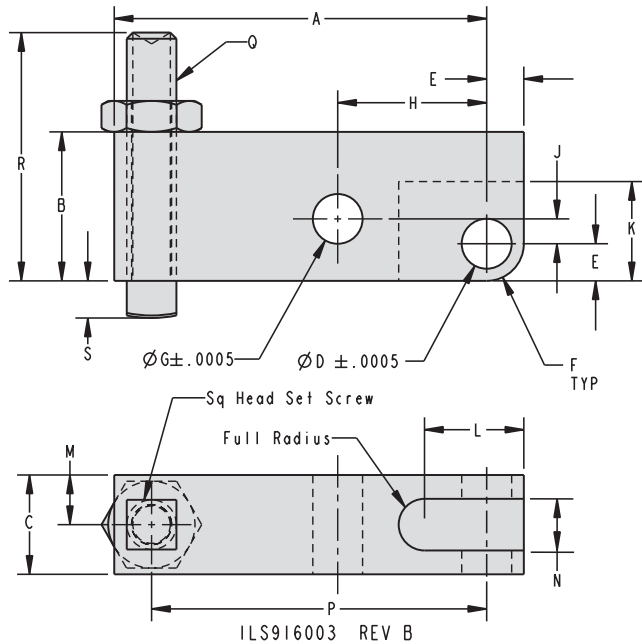

Dimensions

| Model No. | Cylinder Capacity (lbs) | A | B | C | D | E | F | G | H | J | K | L | M | N | P | Q | R | S | |
|--|-------------------------|------|------|------|--------|------|------|--------|------|------|------|------|------|------|------|------------|------|------|--|
| Standard Length Lever | | | | | | | | | | | | | | | | | | | |
| 91-6011-03 | 550 | 1.88 | 0.75 | 0.50 | 0.2515 | 0.19 | 0.19 | 0.2505 | 0.75 | 0.13 | 0.50 | 0.50 | 0.25 | 0.26 | 1.69 | 1/4-20 UNC | 1.25 | 0.19 | |
| 91-6015-03 | 1100 | 2.63 | 1.00 | 0.75 | 0.3765 | 0.31 | 0.31 | 0.3755 | 1.00 | 0.31 | 0.75 | 0.69 | 0.38 | 0.39 | 2.25 | 3/8-16 UNC | 2.25 | 0.28 | |
| 91-6021-03 | 2200 | 3.09 | 1.25 | 0.88 | 0.5015 | 0.38 | 0.38 | 0.5005 | 1.19 | 0.38 | 0.94 | 0.88 | 0.44 | 0.45 | 2.69 | 1/2-13 UNC | 3.00 | 0.38 | |
| Extended Length Lever without Tapped Hole | | | | | | | | | | | | | | | | | | | |
| 91-6011-02 | 550 | 3.00 | 0.75 | 0.50 | 0.2515 | 0.19 | 0.19 | 0.2505 | 0.75 | 0.13 | 0.50 | 0.50 | N/A | 0.26 | N/A | N/A | N/A | N/A | |
| 91-6015-02 | 1100 | 3.50 | 1.00 | 0.75 | 0.3765 | 0.31 | 0.31 | 0.3755 | 1.00 | 0.31 | 0.75 | 0.69 | N/A | 0.39 | N/A | N/A | N/A | N/A | |
| 91-6021-02 | 2200 | 4.00 | 1.25 | 0.88 | 0.5015 | 0.38 | 0.38 | 0.5005 | 1.19 | 0.38 | 0.94 | 0.88 | N/A | 0.45 | N/A | N/A | N/A | N/A | |

Low Pressure Link Clamp Lever Output Curves (Double Acting Only)

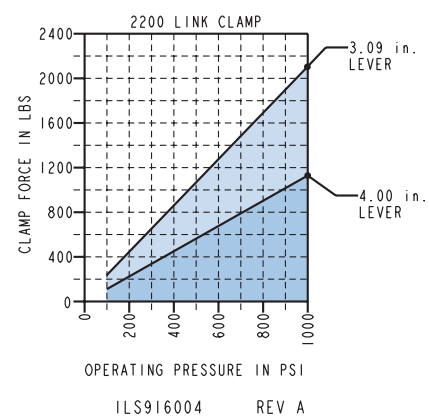
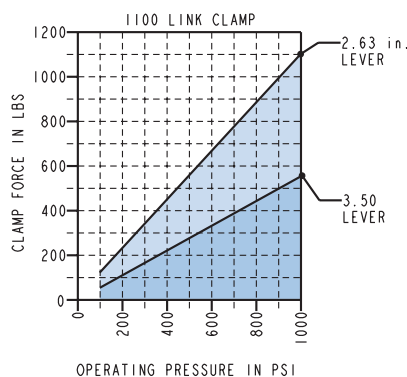
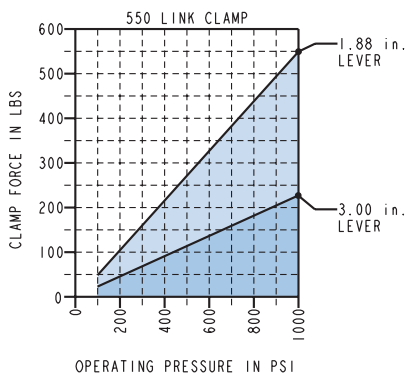

NOTE: Modifications to levers that result in clamp ratios below a 1:1 ratio are not in the safe operating zone for the corresponding link clamp and could result in premature failure.

Exceeding the allowable offset values and operating pressures specified in the tables will result in excessive forces on the link clamp pins, links, and rod which could result in premature failure.