

# Miscellaneous Plumbing

## Hoses & Tubing

### Hoses

- All VektorFlo® hoses are intended to operate up to 5,000 psi working pressure.
- End fittings have the largest possible orifice to reduce restrictions and allow devices to work better.
- Large hoses are typically used to feed entire fixtures, medium size hoses are for feeding small fixtures or single devices.
- Small hoses are to be used to feed single devices ONLY and are to be connected directly back to a manifold unless used on double acting clamps.

**NOTE:** Use of standard rubber hoses and end fittings can hamper the action of many devices due to excessive end fitting restrictions. If you choose to purchase hoses from another supplier, be sure that hose diameters and end fittings are not causing excessive restrictions.

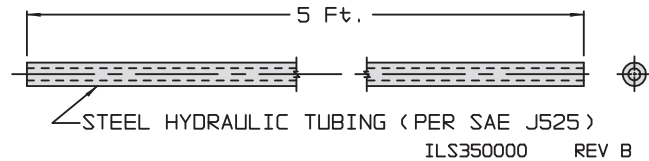

### Tubing

Part No.	Description
35-0002-05	1/4 (0.250") O.D. x 0.049 Thick Wall
35-0003-05	3/8 (0.375") O.D. x 0.065 Thick Wall

Suggested Center Line Radius 1/4" = 0.56 and 3/8" = 0.94

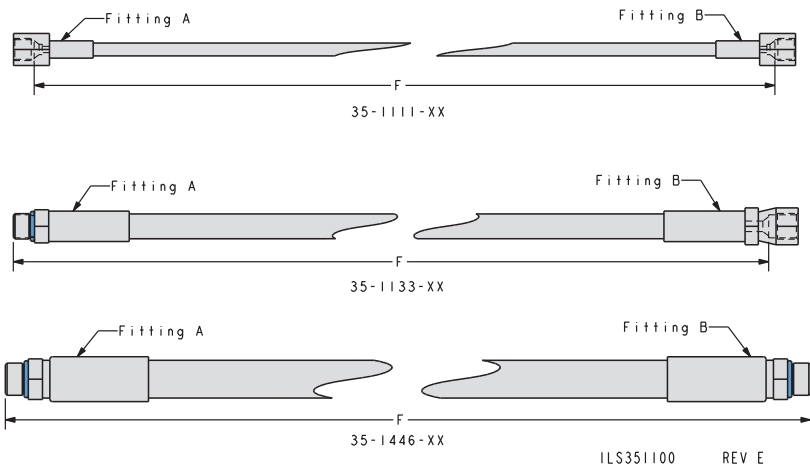
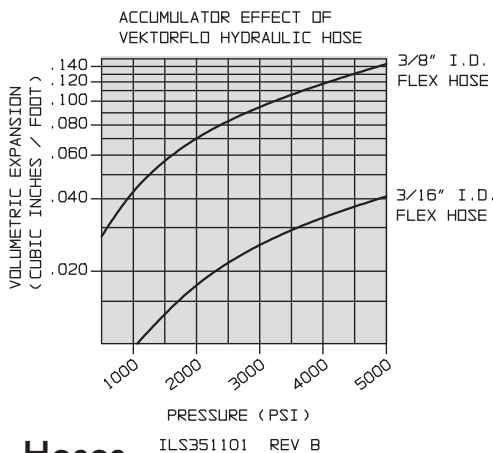

### Hoses

Part No.	Minimum Bend Radius (in.)	Hose I. D.	Hose O. D.	Fitting A	Fitting B	F
35-1111-08	0.75	0.08	0.22	7/16-20 Female JIC 37° Swivel	7/16-20 Female JIC 37° Swivel	8 in.
35-1111-12						12 in.
35-1111-18						18 in.
35-1111-24						24 in.
35-1111-30						30 in.
35-1133-02	1.50	0.19	0.43	7/16-20 Male Straight Thread SAE 4 O-ring Boss	7/16-20 Female JIC 37° Swivel	24 in.
35-1133-03						36 in.
35-1133-05						60 in.
35-1446-03	2.50	0.38	0.67	9/16-18 Male Straight Thread SAE 6 O-ring Boss	9/16-18 Male Straight Thread SAE 6 O-ring Boss	36 in.
35-1446-05						60 in.
35-1446-10						120 in.

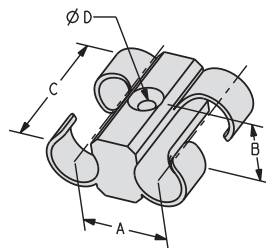

Hose Mounting Clip  
ILS352000 REV E

### Hose Mounting Clip

Model No.	Hose ID	A	B	C	D
35-2001-00	0.08	0.48	0.36	0.80	0.13
35-2003-00	0.19	0.74	0.57	1.10	0.16
35-2006-00	0.38	1.04	0.80	1.61	0.22

