

Cylinders

Threaded Specifications

Single and Double Acting

- Easy to use, basic hydraulic cylinders in G 1/8 ported designs.
- Vektek cylinders are designed for long life in high production applications.
- Reduce or eliminate part distortion by providing accurate, repeatable clamping force.
- A force ranging from "minimal" to maximum cylinder capacity is adjusted by tuning the input pressure.
- Double Acting cylinders assure complete powered retraction for CNC controlled operations where time is critical or when heavy end effectors are used. Single acting cylinders should be used with small end effectors only and where retraction speed is not critical.
- Single Acting units have a coaxial spring design to extend life.

Hardened chrome alloy steel pistons won't "mushroom" even when used without grippers.

Leak-free G 1/8 fluid ports are common to all models.

Springs are designed to return the cylinder and contact points, not intended to pull mechanisms.

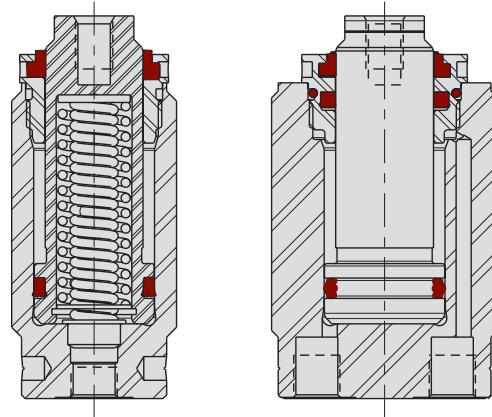

1LMV200113 REV D

Specifications

Model No.	Cylinder Capacity (kN)**		Stroke (mm)	Body Thread	Minimum Length (mm)	Piston Area (cm ²)		Oil Capacity (cm ³)	
	Extend	Retract				Extend	Retract	Extend	Retract
Single Acting (S/A) Cylinders, actuated hydraulically and spring returned.									
42-0010-03			12.5		68			6.5	
42-0010-04	17.8	N/A	25.5	M35 x 1.5	80.5	5.1	N/A	13.0	N/A
42-0010-05			51		109			26.0	
42-0010-06	39.9	N/A	12.5	M48 x 1.5	70	11.4	N/A	14.5	N/A
42-0010-07			25.5		82.5			29.0	
Double Acting (D/A) Cylinders, actuated hydraulically both directions.									
42-0020-00	17.8	5.9	25.5	M48 x 1.5	80.5	5.1	1.7	13.0	4.4
42-0020-01			51		109			26.0	8.8
42-0020-02	39.9	17.5	25.5	M65 x 1.5	82.5	11.4	5.0	29.0	12.7
42-0020-03			51		111.5			58.0	25.5

** Cylinder capacities are listed at 350 bar (35 MPa) maximum operating pressure. The output force is adjustable by varying the hydraulic system pressure. To determine approximate output force for your application, multiply the Piston Area times Your System Operating Pressure. Actual force may vary slightly due to friction loss, seal and wiper drag and/or return spring forces.



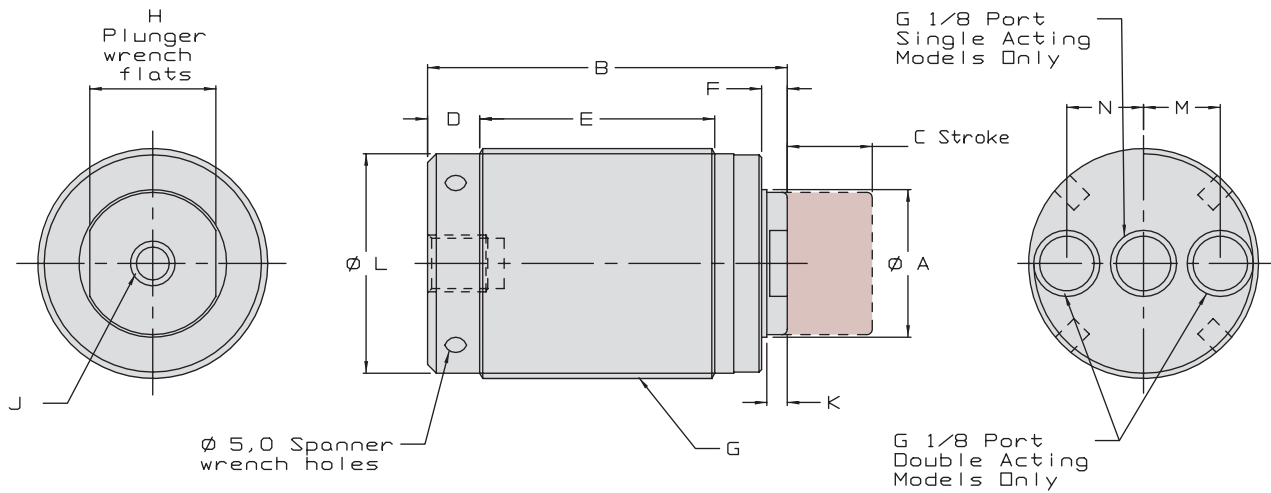
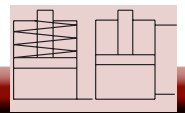

F-5

ILMV200116 REV D

Dimensions													
Model No.	A	B	C	D	E	F	G	H	J	K	L	M	N
Single Acting (S/A) Cylinders, actuated hydraulically and spring returned.													
42-0010-03		68	12.5		39.5								
42-0010-04	20.64	80.5	25.5	12.5	52.5	8	M35 x 1.5	17	M8 x 1.25 x 11	6.5	30.5	N/A	N/A
42-0010-05		109	51		81	8.5							
42-0010-06		70	12.5	12.5	39.5								
42-0010-07	28.58	82.5	25.5	12.5	52.5	10	M48 x 1.5	25	M12 x 1.75 x 13	9	45	N/A	N/A
Double Acting (D/A) Cylinders, actuated hydraulically both directions.													
42-0020-00		80.5	25.5	12.5	52.5								
42-0020-01	20.64	109	51	12.5	81	8	M48 x 1.5	17	M8 x 1.25 x 11	6.5	45	14.5	14.5
42-0020-02		82.5	25.5	12.5	52.5								
42-0020-03	28.58	111.5	51	12.5	81	10	M65 x 1.5	25	M12 x 1.75 x 13	9	60.5	20.5	11

All dimensions are in mm.