

# TuffLink™ 360 Link Clamps

Double Acting

# NEW



## Double Acting Rotary Lug

- Available in 6 sizes; 2.73kN to 22.3 kN capacity at 350 bar (35 MPa) pressure.
- Patented rotary lug feature delivers 360° of lever and/or body positioning.
- Maximum clamping force - Minimal footprint.
- Top flange manifold mounted or standard plumbed.
- Independent body/lever adjustment simplifies manifold mount drill passage design or plumbing position and installation.
- Eccentric levers are unnecessary.
- Levers sold separately — see Section P.

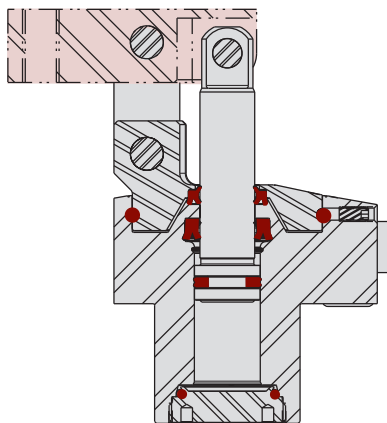

ILMV166001 REV A



U.S. Patent  
No. 8,678,362



## Specifications

Model No.	Clamp Capacity* (kN)	Vertical Clamping Stroke** (mm)	Effective Piston Area (cm <sup>2</sup> )		Oil Capacity (cm <sup>3</sup> )		Maximum Flow Rate*** (L/min.)	Optional Flow Control Model No.****
			Extend	Retract	Extend	Retract		
<b>Double Acting (D/A) Cylinders, actuated hydraulically both directions.</b>								
41-6212-00	2.73	2	1.13	1.87	.57	0.22		
41-6215-00	4.36	2.5	1.77	3.5	1.26	0.42		47-0203-71
41-6218-00	6.22	3	2.54	6.21	1.90	0.75		
41-6222-00	10.4	3.5	3.98	11.73	4.22	1.41		
41-6228-00	15.9	4.2	6.16	21.61	8.27	2.59		47-0203-74
41-6232-00	22.3	5.00	8.04	35.15	11.94	4.22		

\* Clamp capacities are listed at 350 bar (35 MPa) maximum operating pressure with a standard length link clamp lever installed. See section P for clamping force with various lever lengths. Minimum operating pressure is 35 bar (3.5 MPa) for double acting devices. The clamping force is adjustable by varying the hydraulic system pressure. (Actual force will vary slightly due to mechanical inefficiencies and friction.)

\*\* Equal to +/- 3° with standard lever.

\*\*\* To insure maximum service life and trouble-free operation, restrict fluid flow to the above flow ratings when clamping. If you are unable to measure flow rates, the devices should be positioned in no less than 1/2 second. These recommendations apply when using the standard lever. When using the optional long lever or your custom lever, please restrict the flow rates to position the lever in no less than 1 second.

\*\*\*\* In-port flow control requires the use of manifold mount ports.

Optional in-port flow control is a meter-in device with reverse free flow check valve.



# TuffLink™ 360 Link Clamps

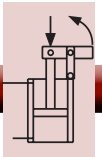

Double Acting

D-5

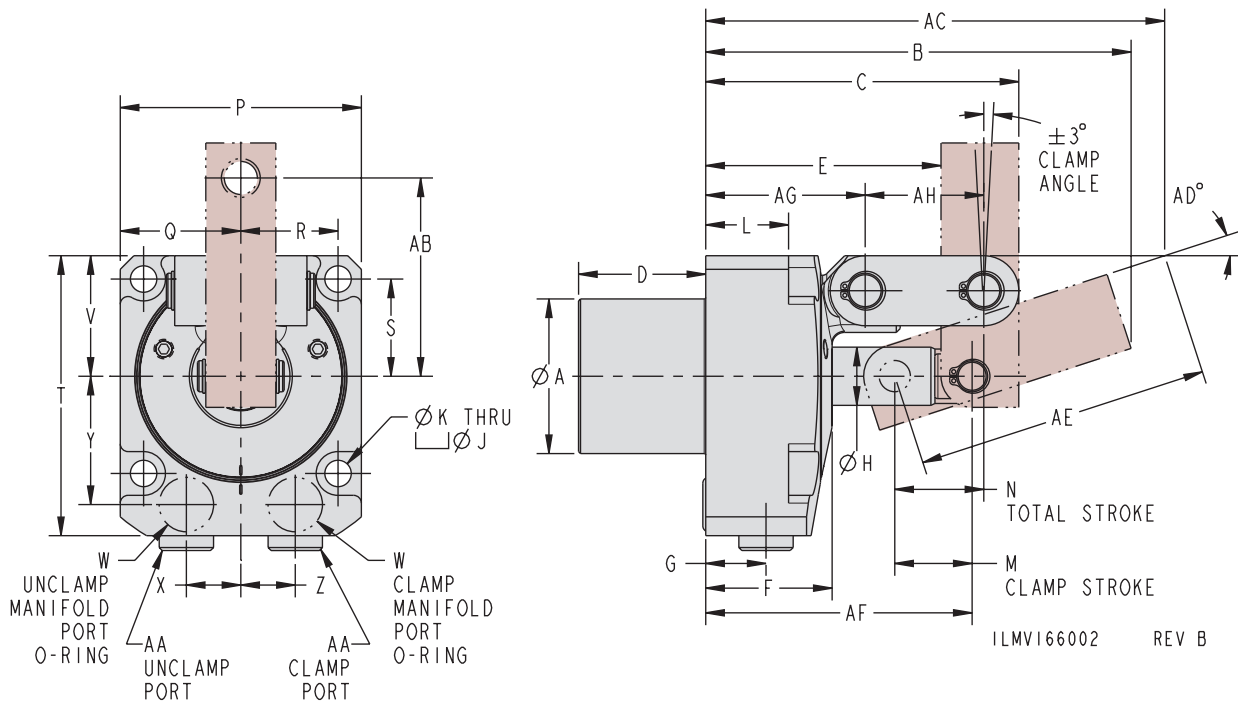

## Dimensions

Model No.	A	B	C	D	E	F	G	H	J	K	L	M	N	P	Q	R
<b>Double Acting (D/A) Cylinders, actuated hydraulically both directions.</b>																
41-6212-00	31.77	81.2	65.00	22.30	51.00	31.50	15.50	10	8.25	4.8	24.50	16.50	19.50	42	21	16.5
41-6215-00	35.77	90.52	72.50	26.60	54.50	31.50		12	9.75	5.8	22.30	19.80	23.30	50	25	20
41-6218-00	39.77	104.73	80.50	32.70	60.50	32.50		15	11.25	6.8	21.30	24.40	28.15	62	31	25
41-6222-00	47.77	118.12	91.50	39.30	66.50	33.00	17.25	18	14.5	8.8	18.50	29.50	34.00	75	37.5	30
41-6228-00	54.77	140.73	107.75	42.40	77.75	38.25		22	17.25	10.8	20.50	35.10	40.10	90	45	36.5
41-6232-00	59.77	166.48	128.50	49.40	92.50	44.00		26	19.25	12.8	22.50	43.70	49.20	112	56	45.5
Model No.	S	T	V	W	X	Y	Z	AA	AB	AC	AD	AE	AF	AG	AH	
<b>Double Acting (D/A) Cylinders, actuated hydraulically both directions.</b>																
41-6212-00	16.5	56	21	ID 8.0 X CS 3.0	10.00	27.00	10.00	G 1/8	35	85.16	19	50	56.00	37.50	21.5	
41-6215-00	20	61	25		11.00	28.00	11.00		41.5	97.66	18	61.91	60.50	38.50	27.0	
41-6218-00	25	72	31		14.00	33.00	14.00		51	109.32	19	71.79	68.50	41.00	30.50	
41-6222-00	30	87.5	37.5		16.00	39.00	16.00	59	126.83	19	87.63	76.50	43.50	37.0		
41-6228-00	36.5	101	45		18.00	45.00	18.00	G 1/4	72	144.35	20	99.63	89.75	50.25	44.5	
41-6232-00	45.5	118	56		20.00	49.00	20.00		86.5	171.82	21	121.76	106.50	58.50	54.0	

## Manifold Port/Bolt Mounting Dimensions

Model No.	Clamp Capacity (kN)	A	K	R	S	W	X	Y
41-6212-00	2.73	32	M4 X 0.7	16.5	16.5	4	10	27
41-6215-00	4.36	36	M5 X 0.8	20	20		11	28
41-6218-00	6.22	40	M6 X 1	25	25		14	33
41-6222-00	10.4	48	M8 X 1.25	30	30		16	39
41-6228-00	15.9	55	M10 X 1.5	36.5	36.5		18	45
41-6232-00	22.3	60	M12 X 1.75	45.5	45.5		20	49

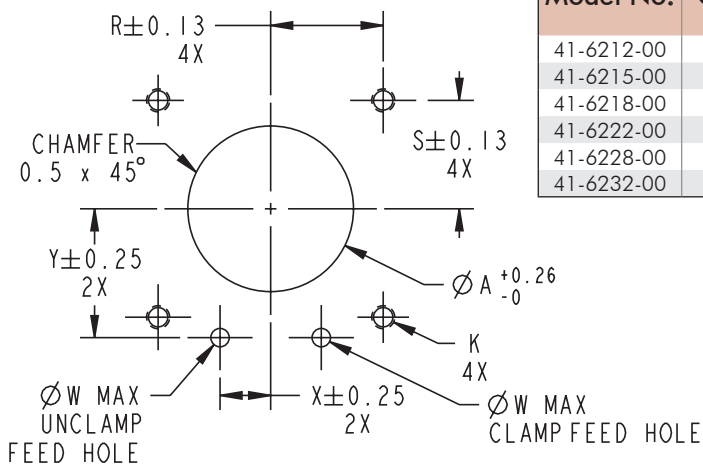

For proper sealing, the mating surface must be flat within 0.08 mm with a maximum surface roughness of 1.6 µm R<sub>a</sub>.

ILMV166003 REV A