

# Miscellaneous Plumbing

## Rotary Union, Dual Path

### Dual Path Rotary Union

- Rotating unions are a rotary connection, feeding pressure to fixtures while allowing full 360° rotation of the fixture with or without pressure. A machine or independent indexer may do this indexing.
- Feature aluminum construction for low weight and excellent durability.
- Dual precision sealed bearings for consistent performance and long seal life.
- Larger units are available upon request.



#### Operating Parameters

- Max. Input Pressure: 600 psi
- Max. Vacuum: 30 Hg
- Max. Rotational Speed: up to 500 RPM
- Max. Temperature: 220° F

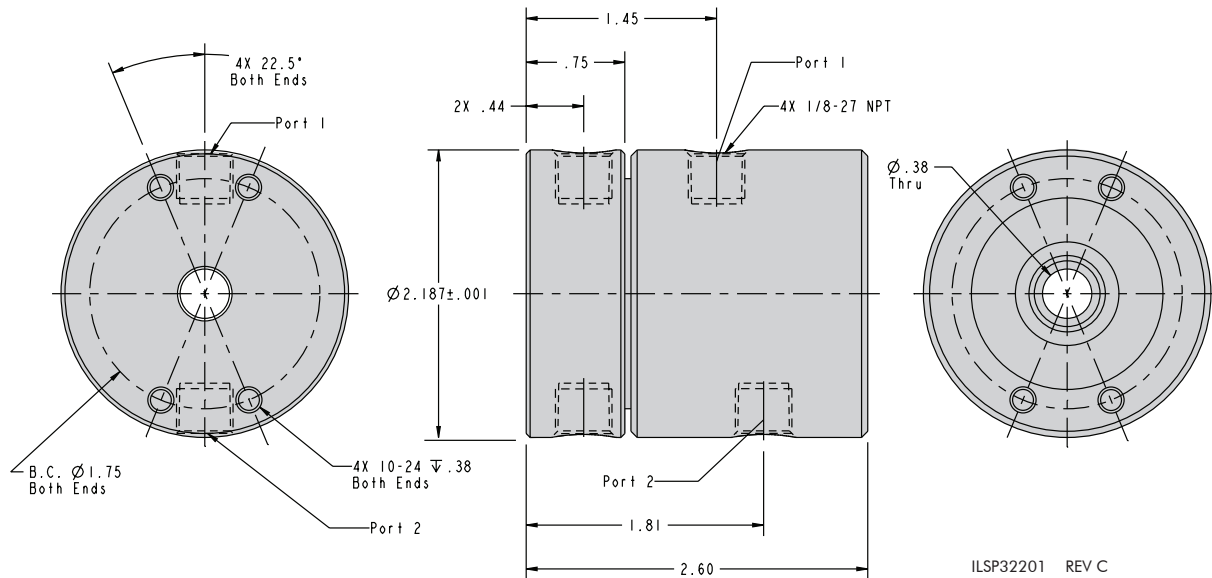

#### Specifications

Model Number	Max. Input Pressure (psi)	Max RPM	Max Vacuum (Hg)	Max Temperature (F)	Electrical Slip Ring Option	Maximum Amps per Circuit	Maximum Volts per Circuit	Lead Wire Length Min.
P3-2242-01	600	500	30	220	NA	NA	NA	NA
P3-2242-01-ES6A					6 Circuit	2	120	24 in.
P3-2242-01-ES12A					12 Circuit			

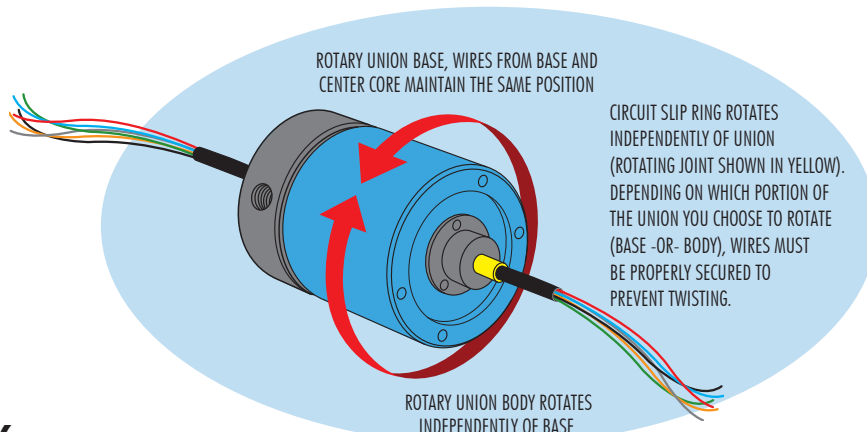

800-992-0236

© Vektex LLC, July 2017